

Conversion Instructions for Cylindrical (93KZ) and Mortise (45HZ) Electronic Inside Escutcheons

9KEKT Cylindrical Conversion

See the reverse side for 45HEKT mortise conversion.

Use this instruction to replace the inside, one-piece escutcheon with the updated two-piece escutcheon.

Use this instruction for:

- Keypad EZ locks

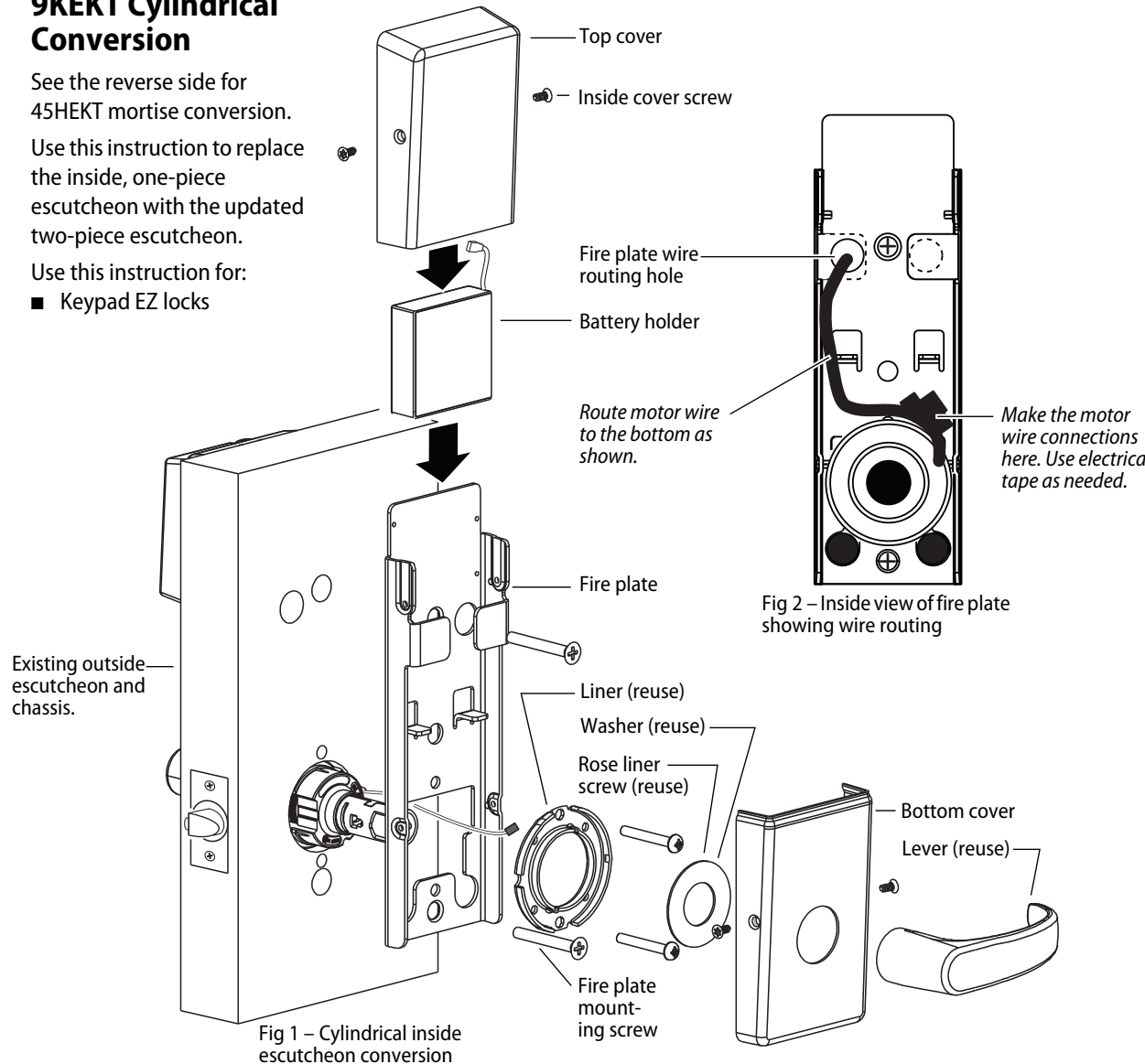

Components in the box

- Top cover
- Bottom cover
- Fire plate with mounting screws (qty 2)
- Battery holder with eight batteries
- Inside cover screws (qty 4)
- Self wrapping sleeving

Conversion instructions for cylindrical electronic inside escutcheons

Remove old inside escutcheon

- 1 Remove the inside lever. Save and reuse.
- 2 Remove the battery door.
- 3 Remove the inside escutcheon.
- 4 Disconnect the wires.
- 5 Remove the liner and washer. Save and reuse.

Install new inside two-piece escutcheon (top cover and bottom cover)

- 1 Route wires through the fire plate hole. See Fig 2.
- 2 Mount the fire plate.
- 3 Reinstall the liner and washer.
- 4 Connect the motor wire. See Fig 2.
- 5 Route wires on fire plate. See Figure 2 for the proper routing of the wires.
- 6 Install the bottom cover.
- 7 Install inside lever.
- 8 Install the battery holder from the top of the fire plate.
- 9 Connect the battery wire.
- 10 Install the top cover.

45HEKT Mortise Conversion

See the reverse side for 9KEKT cylindrical conversion.

Use this instruction to replace the inside, one-piece escutcheon with the updated two-piece escutcheon.

Use this instruction for:

- Keypad EZ locks

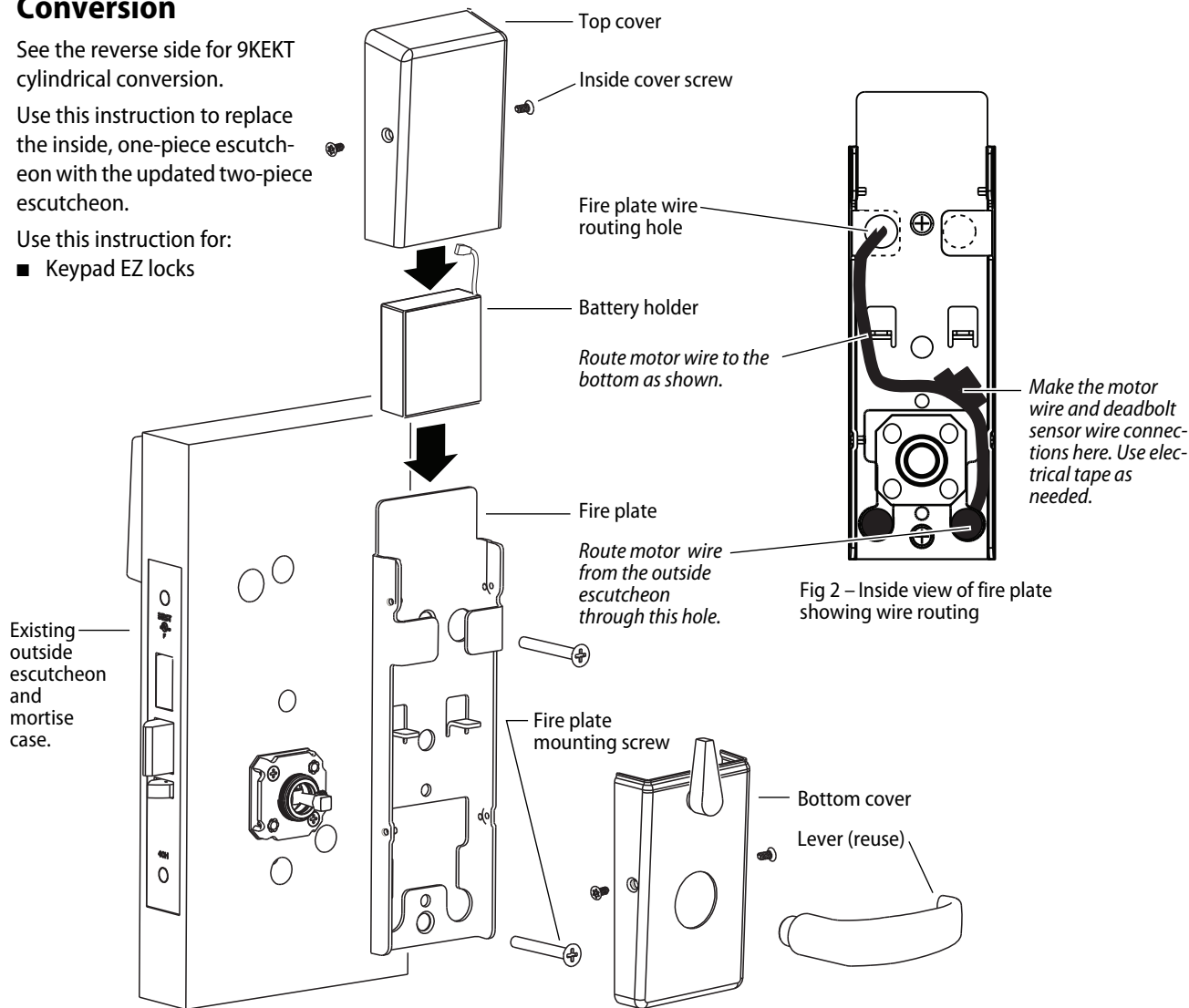

Fig 1 – Mortise inside escutcheon conversion

Fig 2 – Inside view of fire plate showing wire routing

Components in the box

- Top cover
- Bottom cover
- Fire plate with mounting screws (qty 2)
- Battery holder with eight batteries
- Inside cover screws (qty 4)
- Self wrapping sleeving

Conversion instructions for mortise electronic inside escutcheons

Remove old inside escutcheon

- 1 Remove the inside lever. Save and reuse.
- 2 Remove the battery door.
- 3 Remove the inside escutcheon.
- 4 Disconnect the wires.

Install new inside two-piece escutcheon (top cover and bottom cover)

- 1 Route wires through the fire plate hole. See Fig 2.
- 2 Mount the fire plate.
- 3 Connect the motor and deadbolt sensing wire.
- 4 Route wires on fire plate. See Figure 2 for the proper routing of the wires.
- 5 Install the bottom cover.
- 6 Install inside lever.
- 7 Install the battery holder from the top of the fire plate.
- 8 Connect the battery wire.
- 9 Install the top cover.

BEST ACCESS SYSTEMS

A Product Group of Stanley Security Solutions, Inc