

Tools Needed

Herramientas necesarias
 Outils nécessaires

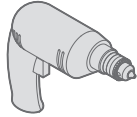

⚠ Wood Door
 7/8" (22.2 mm)
 Drill Bit

⚠ Wood Door
 7/32" (5.6 mm)
 Drill Bit

⚠ Metal Door
 #12-24

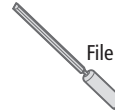

File

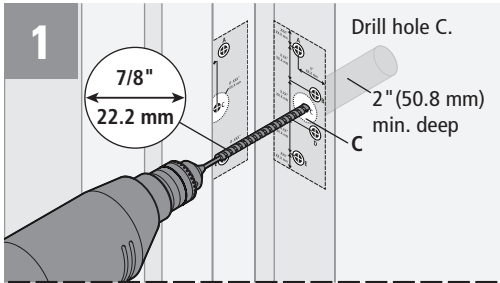
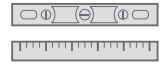

Drill hole C.

2" (50.8 mm)
 min. deep

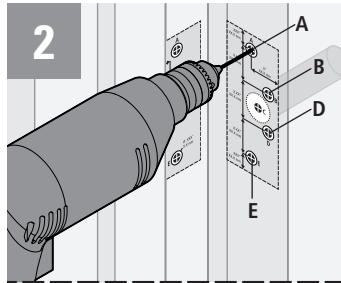

Drill hole A,
 B, D, and E.

Machine Screw -
 1/2 x 12-24 F.H.
 Wood Screw -
 1-1/4 x #12 F.H.

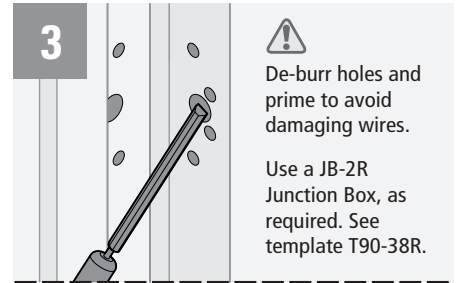

De-burr holes and
 prime to avoid
 damaging wires.

Use a JB-2R
 Junction Box, as
 required. See
 template T90-38R.

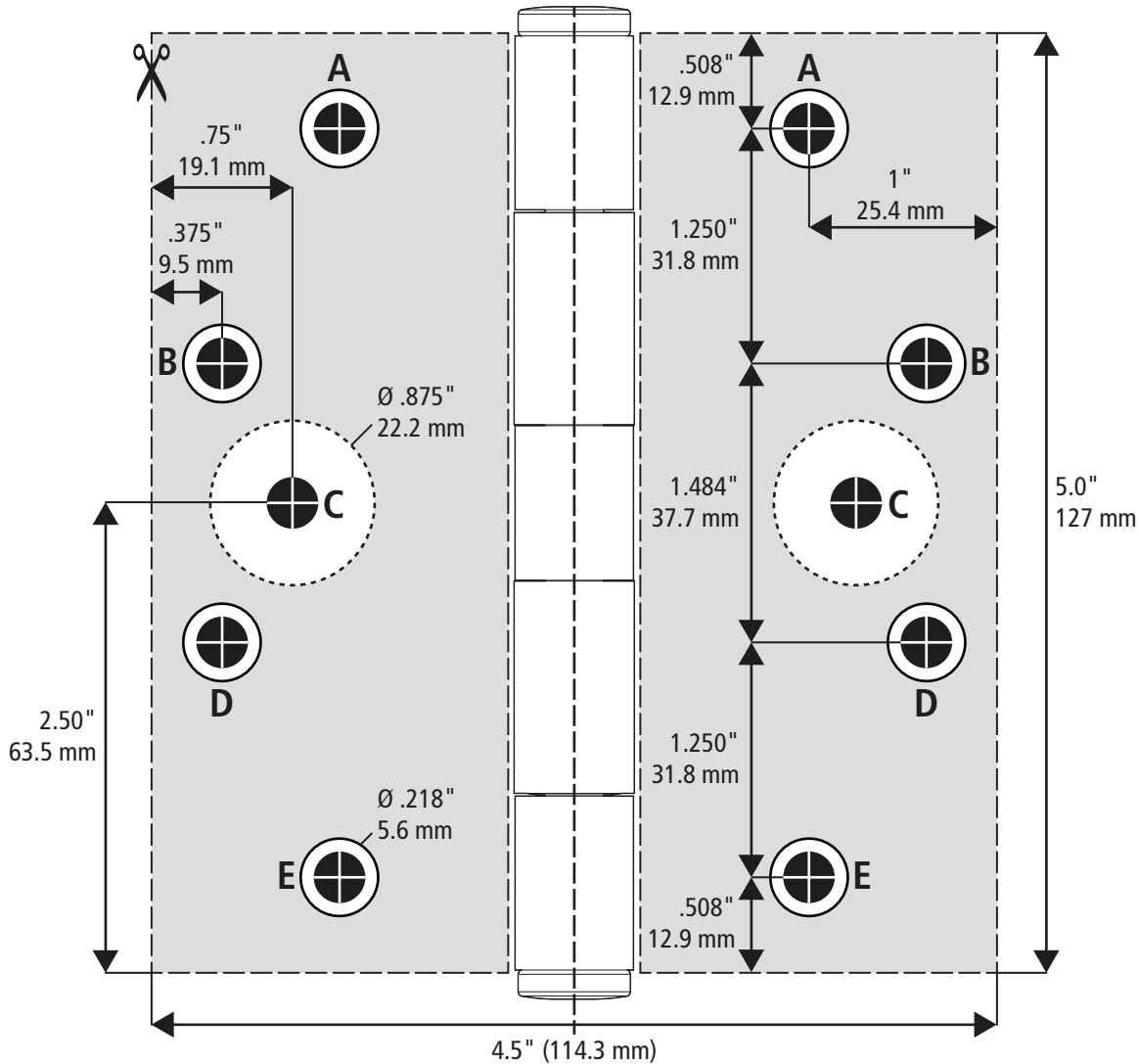

Standard Weight
 0.146" (3.7mm)
 CECB 179 & 191

Heavy Weight
 0.190" (4.8mm)
 CECB 168 & 199



1/32-1/16
 (.79mm-1.6mm)
 clearance between hinge
 leaves when parallel.

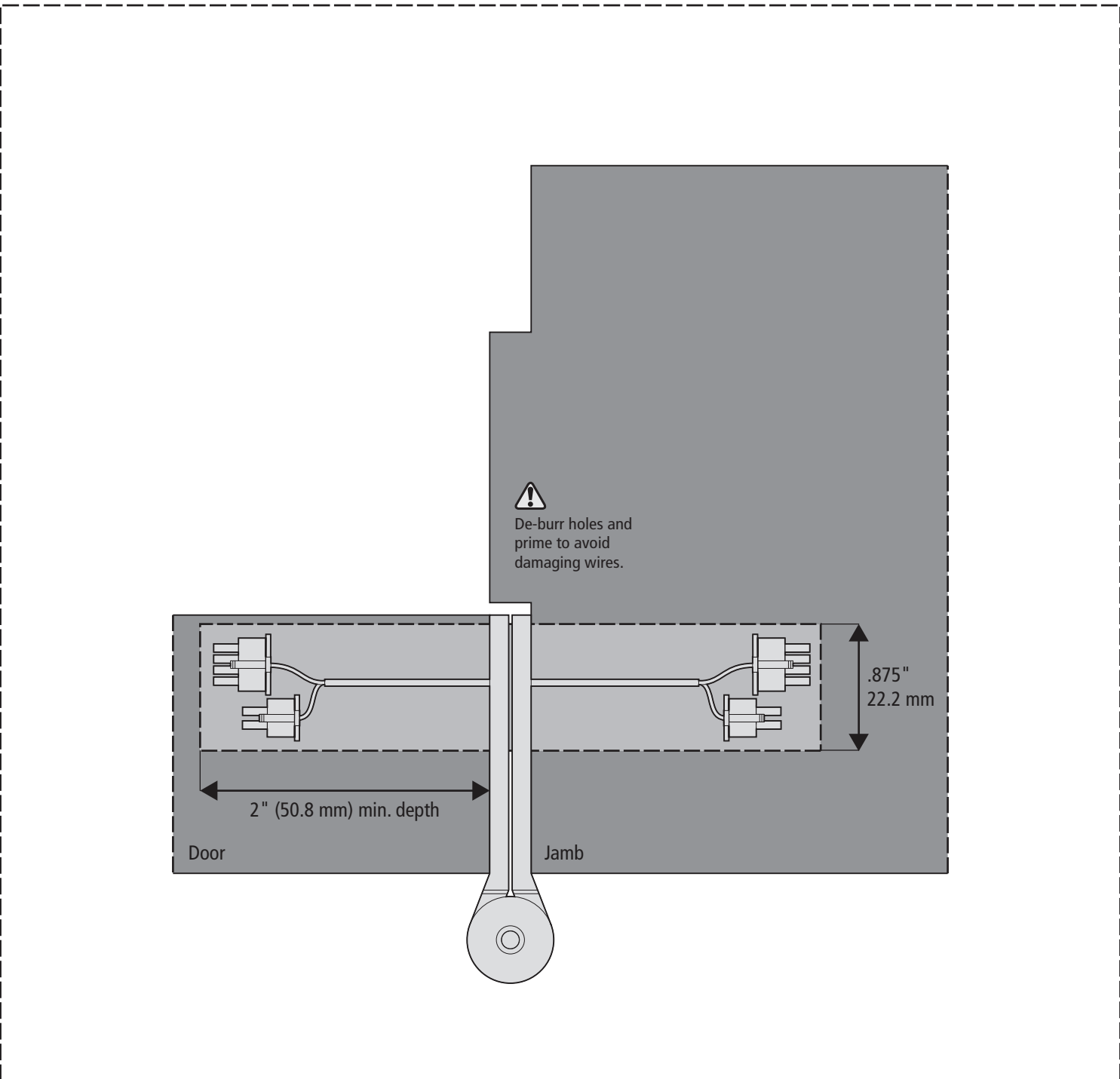

De-burr holes and prime to avoid damaging wires.

2" (50.8 mm) min. depth

.875"
22.2 mm

Door

Jamb