

## Notes

1. Before drilling, check the G04 Template—Hole Pattern Chart for 35HG, 35HBV, and 35HZ Mortise Locks. See also the G06 Template—Installation Template for 35HG, 35HBV, and 35HZ Mortise Locks.
2. Mortise the clearance for the anti-friction latch.
3. The maximum door-to-frame gap is  $\frac{3}{16}$ ".
4. Allow  $\frac{3}{64}$ " clearance for the strike box thickness.
5. For metal doors, lock case support is required from the door manufacturer.
6. Tap for a #12-24 machine screw or drill for a #12 wood screw (a combination screw is supplied).
7. Lock case holes:
  - ① Cylinder hole— $1 \frac{3}{8}$ " dia.
  - ② Turn knob hole— $\frac{5}{8}$ " dia.
  - ④ Lever hole— $\frac{7}{8}$ " dia.
  - ⑤ Through-bolt holes— $\frac{3}{8}$ " dia. (two required)

### Strike box — overhead view

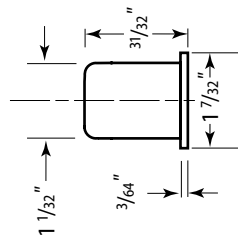

### Strike plate — overhead view

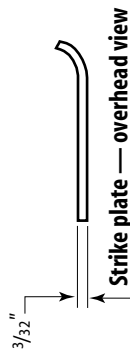

### Mortise case — overhead view

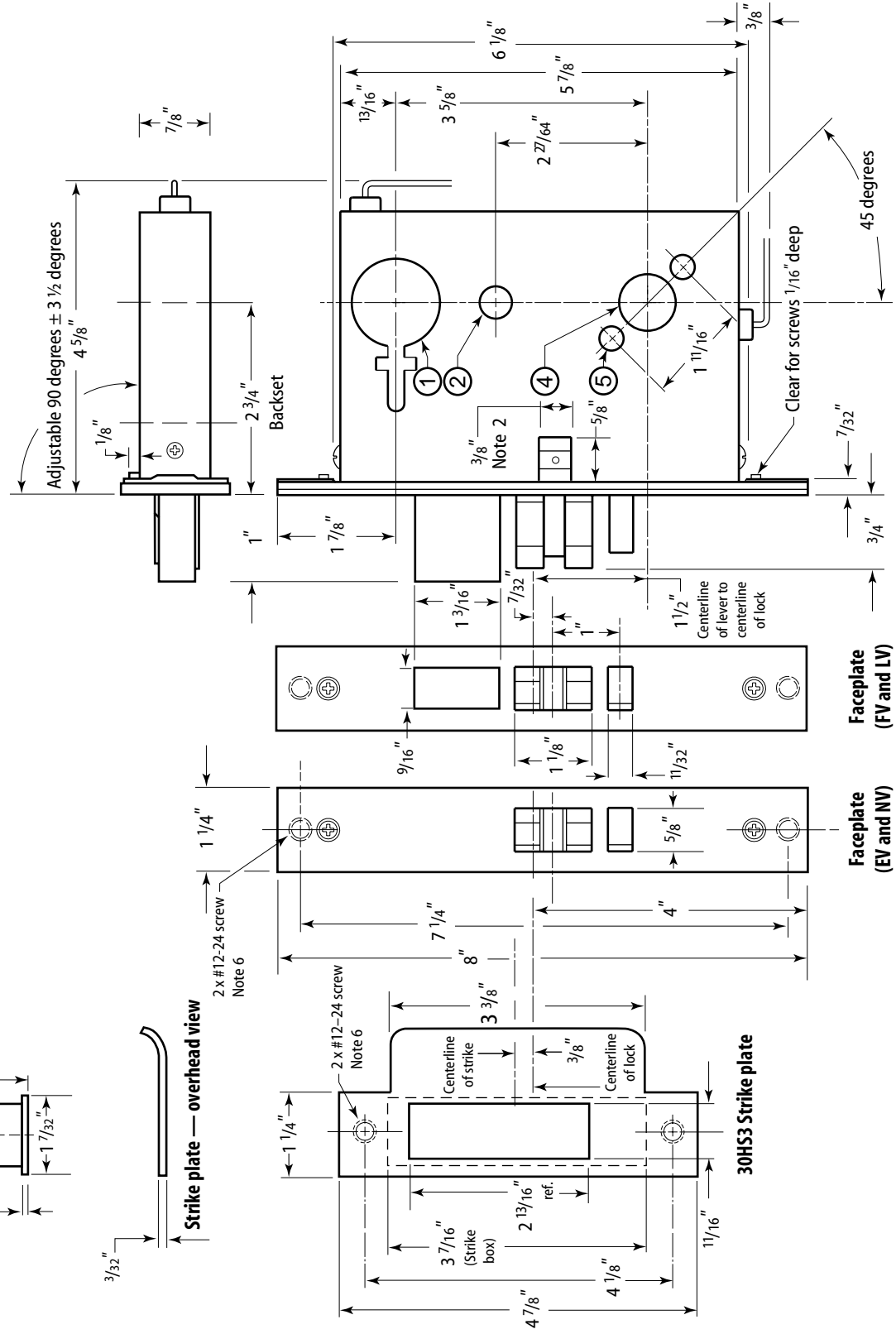

Title  
Installation Specifications for 35HG, 35HBV, and 35HZ Mortise Locks

**BEST ACCESS SYSTEMS**

Series  
35HG, 35HBV,  
35HZ

Backset  
2 3/4"

Trim style  
DV, MS, PH,  
PM, SC, KP

Door thickness  
1 3/4" to 3"

Rev date  
3/2003

Template  
number

**G03**

Rev  
**C**