

Cylinder Dogging Instructions

OVERVIEW

A Channel

B Hex key bracket

C Mortise cylinder

D Collar

E Cylinder locating washer

F Locknut

G Hinge side filler

H Touchbar (down)

I Dogging cam
(dogged down position)

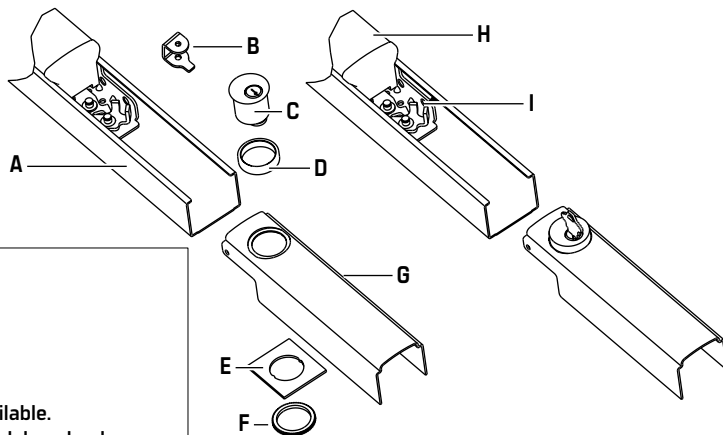

Document translations available.
Scan for product details and downloads.

Call 1-800-392-5209 or visit
<https://dhwsupport.dormakaba.com/hc/en-us>
for assistance and warranty information.

1 CYLINDER DOGGING

- 1.1 Slide hinge side filler out of the channel.
- 1.2 Remove hex key bracket, if necessary.
- 1.3 Install cylinder:
 - Position cylinder with cylinder core away from touchbar.
 - Insert cylinder through collar, hinge side filler, locating washer, and tighten with locknut.
- 1.4 Slide hinge side filler into channel.

NOTE: Dogging cam must be in dogged down position as shown.

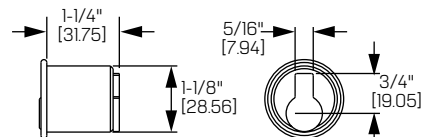

Mortise cylinder dimensions