

OMNILOCK®

Adaptation Instructions for Omnilock QASOM with Schlage D-series Locks

Planning the installation

Contents

These adaptation instructions describe how to install your QASOM Omnilock with an existing Schlage D-series Cylindrical Lock. Topics covered include:

Planning the installation..... 1
Installing the lock.....2
Testing the lock.....4

Components checklist

Use the following checklist to make sure that you have the items necessary to install your QASOM Lock.

Components provided in the box:

- Outside escutcheon assembly
- Miscellaneous hardware
- Batteries

Other components:

- Programming Default ID Card (provided with software)

Environment information

Model	Side of door	Temperature Range	Exposure
<i>Standard</i>	<i>Outside</i>	+32°F to +129°F 0°C to +54°C	<i>Drip proof. Inadvertent splashing of water spray acceptable.</i>
<i>Weatherized</i>	<i>Outside</i>	-4°F to +129°F -20°C to +54°C	<i>Direct exposure to rain and snow</i>

Planning the installation

1 Install batteries

Four alkaline AA batteries (or two weatherized packs if installing a weatherized unit) are furnished with your Omnilock system and must be installed before proceeding with operation verification and system installation.

- 1 Remove the gasket from the rear of the housing assembly as shown in Figure 1.
- 2 Remove the screw from the battery cover and remove the cover.
- 3 Install batteries with proper polarity as shown in Figure 2. (For weatherized battery packs, simply connect the wires from the battery pack to the circuit board as shown in Figure 3.)

Note: Be sure red and black motor wires are connected before attempting step 4. Align the wires together so that the wire colors match.

- 4 Press and hold the reset button on the PC board (as shown in Figure 2) until the green light on the keypad flashes (about three seconds) then release the button. If green light does not flash, see "Troubleshooting" on page 4.
- 5 Replace the battery cover. See Figure 1. Make sure that the tabs on the lower edge of the battery cover are hooked over the edge of the back plate and secure the cover with the screw.
- 6 Replace the gasket. See Figure 1. Make sure that it is inside the edge of the housing.

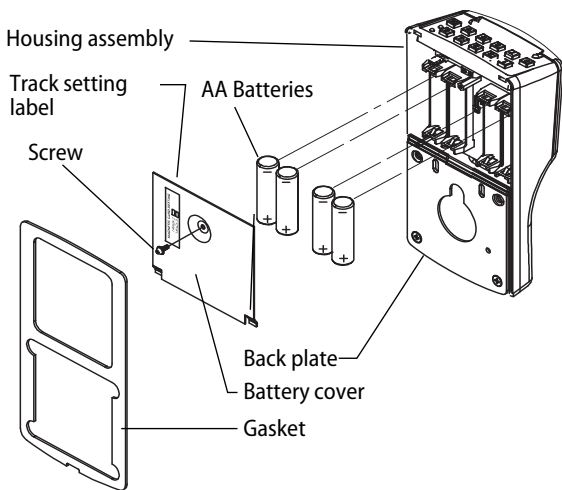

Figure 1 Installing batteries

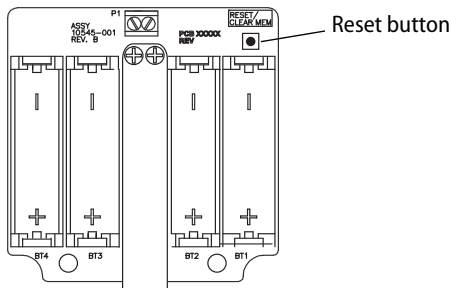

Figure 2 Using the reset button

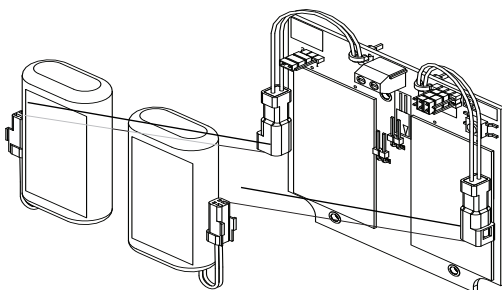

Figure 3 Installing weatherized batteries

Planning the installation

2 Remove outside lever

Standard core

- 1 Insert key and rotate 90 degrees clockwise.
- 2 Use a push pin to release the lever catch on the spindle.
- 3 Pull lever off.

IC core

- 1 Insert key and rotate 15 degrees clockwise.
- 2 Remove IC core from lever.
- 3 Use a push pin to release the lever catch on the spindle.
- 4 Pull lever off.

3 Install escutcheon

- 1 Place escutcheon over outside spindle.
- 2 Seat the driver over the spindle. The driver key slot should be on the same side as the lever return. See Figure 5.
- 3 The driver will be flush with the escutcheon when fully seated.
- 4 Insert the driver key.
- 5 Replace the lever by reversing the removal process in section 2.

4 Check operation

Check the operation of the lock. For example, check that:

- door latches and opens properly
- key access works
- door gap is 1/8" (3 mm)

For assistance, contact your local dormakaba dealer.

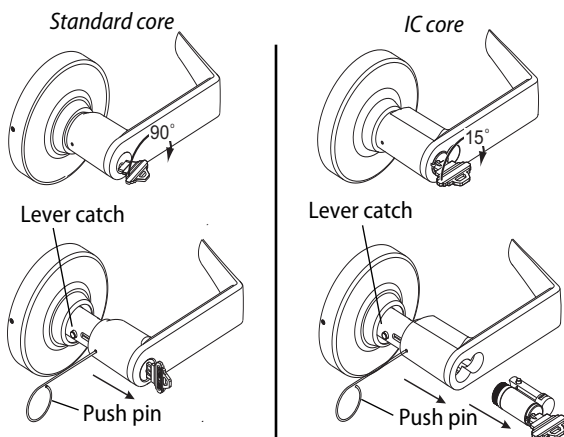

Figure 4 Remove the outside lever and rose

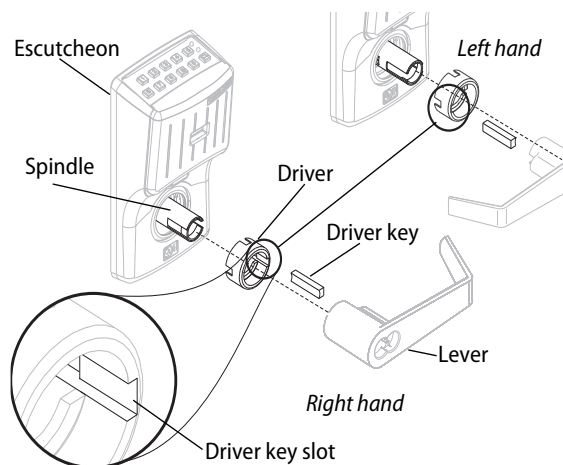

Figure 5 Inserting the driver and key

Testing the lock

5 Test lock

To test the lock for proper operation before the lock is programmed, follow these instructions:

For keypad locks

- 1 Press **1234 for the 2000 series, or 5011234 for the 500 series.**

The green light flashes and the latch unlocks.

- 2 Turn the lever and open the door.

During the unlock time, the green light flashes. Then the red light flashes and the latch relocks.

For magnetic stripe card locks

- 1 Align the magnetic stripe card with the V mark by the card slot.

- 2 Insert and then remove the card.

The green light flashes and the latch unlocks.

- 3 Turn the lever and open the door.

During the unlock time, if using the Programming Default ID Card, the green light flashes. Then the red light flashes and the latch relocks.

For proximity card locks

- 1 Align the proximity card over the recess on the front of the escutcheon.

The green light flashes and the latch unlocks.

- 2 Turn the lever and open the door.

During the unlock time, if using the Programming Default ID Card, the green light flashes. Then the red light flashes and the latch relocks.

6 Troubleshooting

If the mechanism does not unlock, remove the battery cover and check for proper orientation and seating of the batteries and motor connector. Ensure that wires are not pinched. Reset the electronics by pressing and holding the reset button on the circuit board until the light flashes green (approximately 3 seconds), then releasing the button. See Figure 6.

Note: *The system will go through a self-test and the green light will flash five times. You will hear the lock unlock, then relock three times. A red flash indicates a PC board or drive system problem. If a red flash or no flash is observed, check for proper orientation and seating of the batteries and motor connector, ensure that wires are not pinched, then repeat the reset process.*

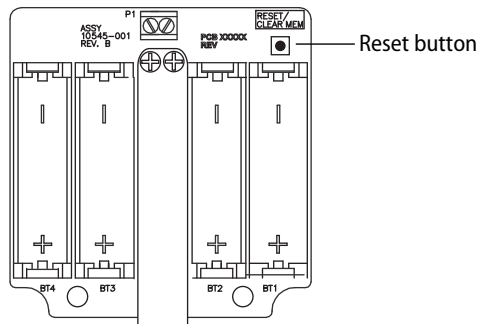

Figure 6 Using the reset button