

Installation Instructions: 2-Part Ligature-Resistant Continuous Hinge

1. Before installing the hinge, make sure the door is supported in the frame. You should have 1/16" gap between door and the frame on the top of door and 1/8" to 3/16" on the lock side of door.

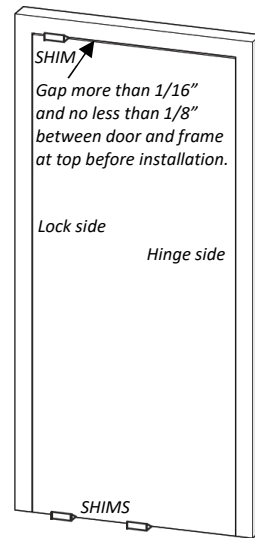

For wood doors: pre-drill wire access holes on interior face of door to center of door depth as shown (DO NOT DRILL HOLES THRU THE DOOR). Drill 1/8" pilot holes and enlarge to 1/2". Remove all burrs! Drill channel from top edge of door to intersect the two holes as seen below.

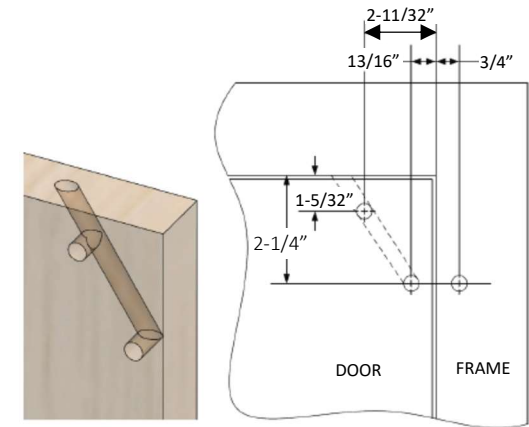

2. Once door is secure pre-drill the wire access holes as shown.

For hollow metal doors: drill 1/8" pilot holes and enlarge to 1/2". Remove all burrs!

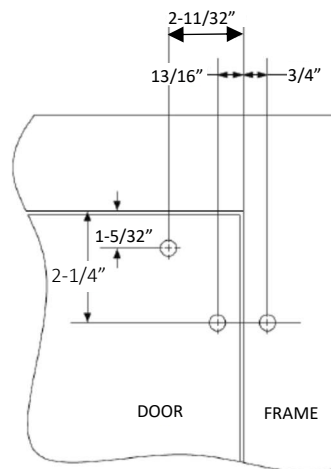

3. Mark a vertical line with pencil on the frame. Distance of the line from the edge of the hinge side door opening depends on the gap left on the lock side:

- 1/16" on lockside: 1-3/8" line
- 1/8" on lockside: 1-7/16" line
- 3/16" on lockside: 1-1/2" line

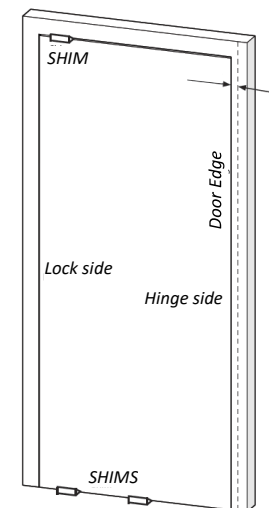

4. Align top of notch in shorter upper part of hinge with bottom edge of door frame. Mark horizontal line at the bottom of hinge.

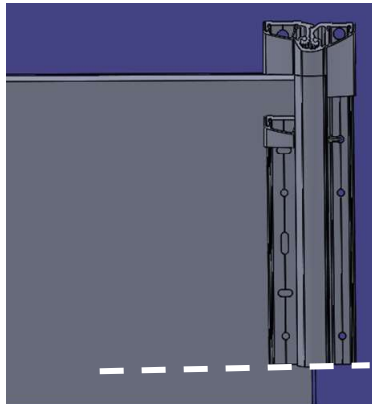

NOTE! It is recommended to check the alignment of hinge with sensor. Hold upper part of hinge aligned with vertical and horizontal lines. Place a sensor (covered) where the cutout in hinge is. The top of the sensor should slightly protrude above the door.

5. Start with installation of bottom longer part of hinge. Align the vertical edge of the frame leaf of the hinge with the vertical line and align the top of hinge with horizontal line. Make sure the hinge is level.

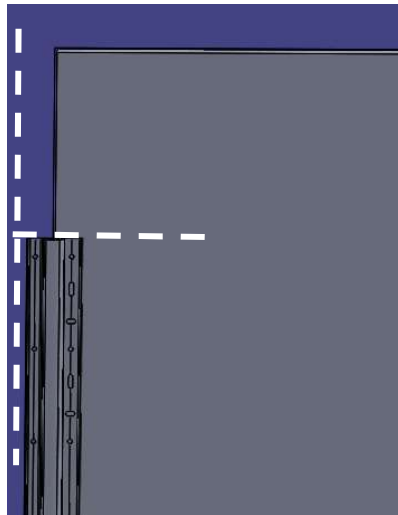

6. Number

6 Mount door to hinge – Please read carefully

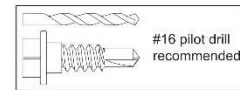
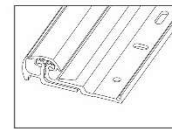

▲ Use wood screws provided instead of screws in illustrations.

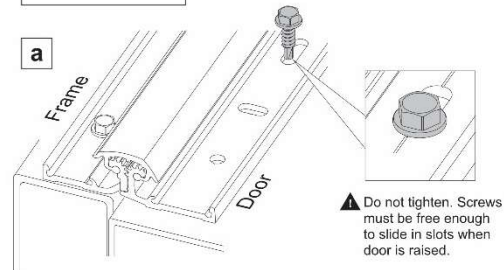

- a. Fold door leaf of hinge against door. Install a hex screw at the bottom end of each vertical slot.

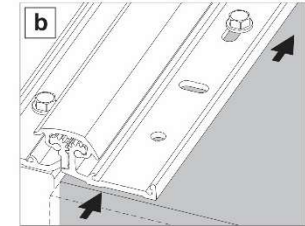

- b. Use pry bar to raise door until tight against shims between the top of door and frame header.

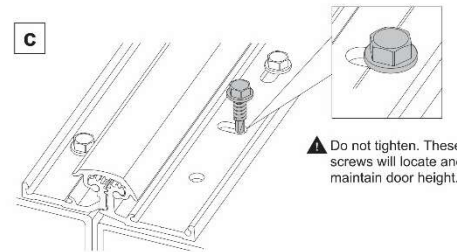

- c. Install screws into lock side end of each horizontal slot.

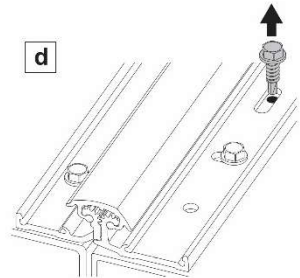

- d. Remove shims from top of door(s) and remove screws from vertical slots.

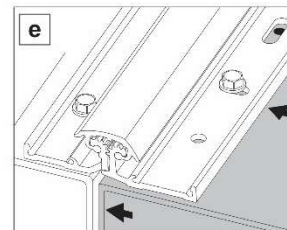

- e. Adjust lateral clearances of door by prying door from lock side of frame.

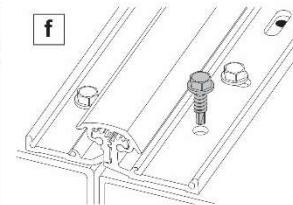

- f. Install screws into two or three round holes at both top and bottom of hinge. Open and close door slowly, checking all edges for clearance. If lock side clearance is satisfactory, insert remaining screws into round holes.

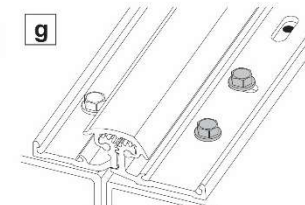

- g. Tighten all screws on door leaf.

- Place upper part of the hinge on the door. Feed the wire from the hinge through the lower wire access hole in the door and back out through the upper wire access hole as shown. *Make sure the wire is free moving and not pinched.*

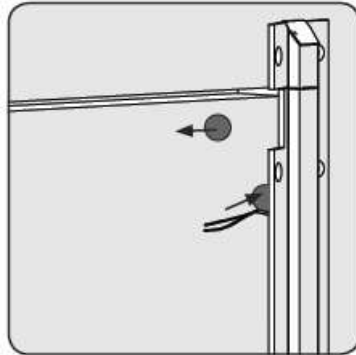
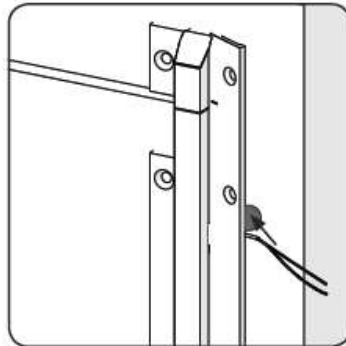
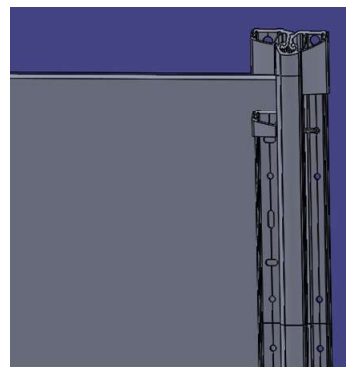

Illustration only. Different model of hinge shown.

- Connect the other set of wires through the wire access hole in the frame according to the wiring diagram.



- Fasten hinge to the frame using wood screws and self-drilling screws (door leaf) provided. Follow same steps as for bottom part of hinge.



- Test the operation of the door. If needed adjust lateral clearances of door by prying door from lock side of frame. Tighten screws fully when operating properly.

- Fasten hospital tip plug with two security screws.

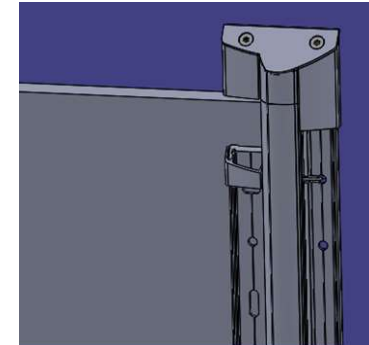

Attention! Covers are vandal resistant and non-removable, and should not be installed until the door is operating properly

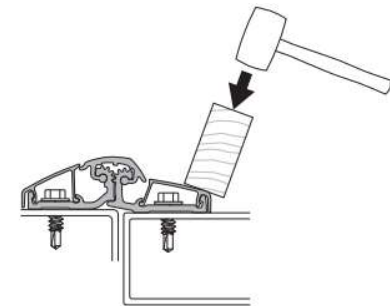

12. Install covers to upper part of hinge as shown. Curved hooks of the covers needs to snap into the hinge as shown in the picture. Install using a light hammer tap against a wood block.

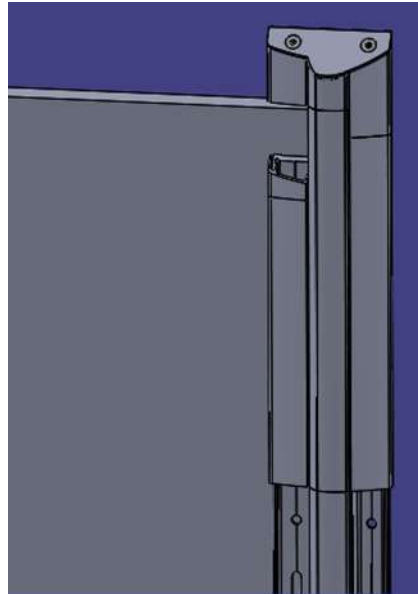

NOTE: Covers of the upper part of the hinge are slightly shorter than the hinge. When installing bottom hinge covers push the covers up to eliminate any gap.

13. Install covers for lower part of the hinge.

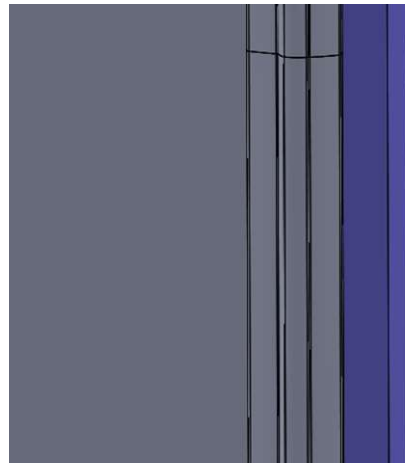

NOTE:

Use hinge fillers provided by others.



For Complete Online Instructions Visit:
<https://dhwsupport.dormakaba.com/hc/en-us>
For Assistance or Warranty Information:
Call 1-800-392-5209 or visit
<https://dhwsupport.dormakaba.com/hc/en-us>