

FULL MORTISE TEMPLATE PIVOT REINFORCED HINGES WITH 4 1/8" DOOR PLATE FOR DOORS WITH SQUARE EDGE HINGE STILES

Size: 5 × 4 1/2"

**TOP HINGE - RIGHT HAND SHOWN
LEFT HAND IS OPPOSITE**

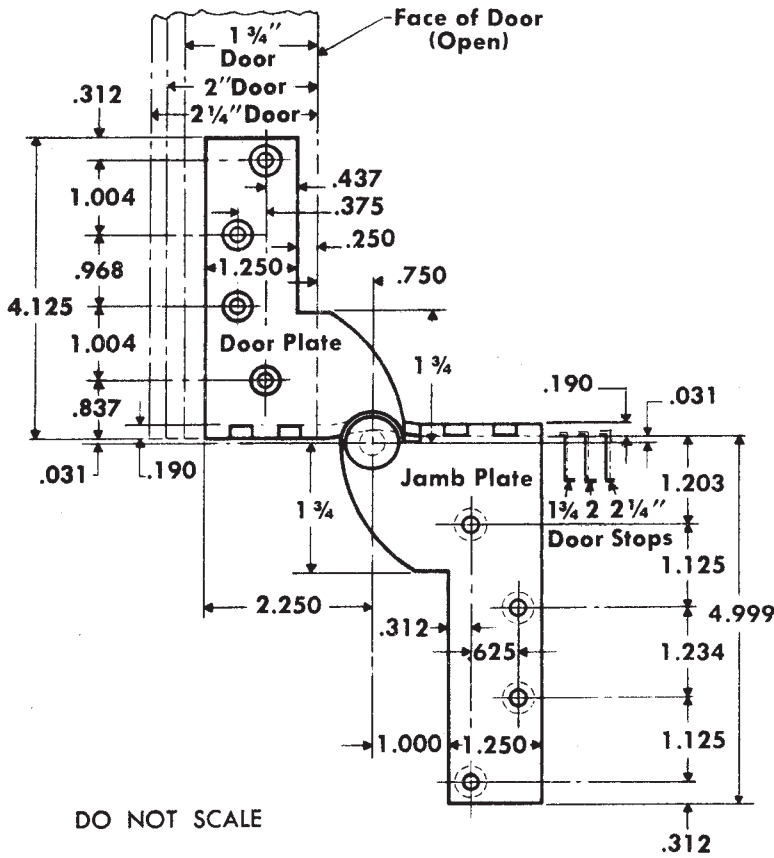

DO NOT SCALE

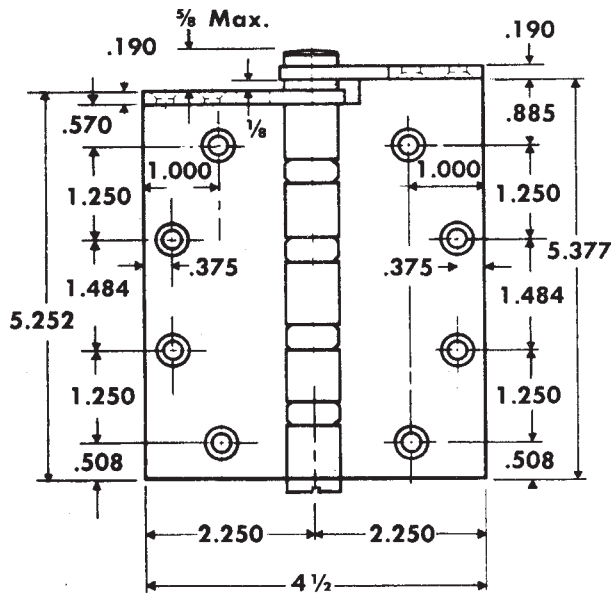

For use with door holders, closers and operators which interfere with standard door plates shown on template T50-08.

SET CLASS NO.		Gauge of Metal
Steel	Nonferrous	
CB212 with 4 1/8 door plate	CB222 with 4 1/8 door plate	0.190
FBB212 with 4 1/8 door plate	FBB222 with 4 1/8 door plate	0.190
CB1908 with 4 1/8 door plate	CB1968 with 4 1/8 door plate	0.190
CB1908R with 4 1/8 door plate	CB1968R with 4 1/8 door plate	0.190

Machine Screw Size — 1/2 × 12-24 F.H.
Wood Screw Size — 1 1/2 × No. 12 F.H.

NOTE: Backsets which apply when pivot-reinforced hinge is used on door thickness indicated and when the usual 1/16 stop clearance is desired.

Door Thickness	*Backset on Door	*Backset on Frame
1 3/4	1/4	5/16
2	1/2	9/16
2 1/4	3/4	13/16

*CAUTION: These backsets must be used on ALL hinges in set.

CENTER AND BOTTOM HINGES

Size—5 × 4 1/2"
Gauge of Metal — .190

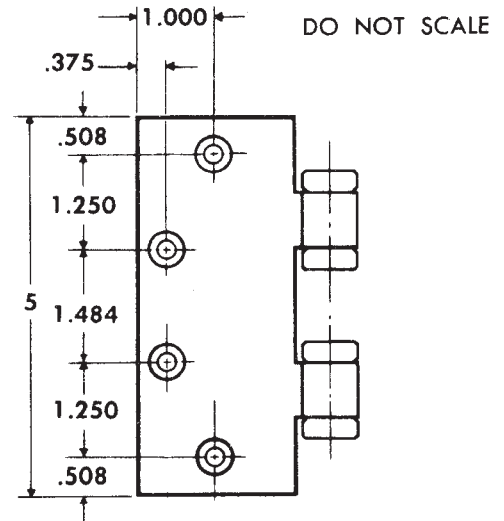

DO NOT SCALE

Machine Screw Size — 1/2 × 12-24 F.H.
Wood Screw Size — 1 1/2 × No. 12 F.H.

