

Rim RDC-10 Series: Double Cylinder (10 Function) Installation Instructions

TOOLS NEEDED:

Phillips screwdriver



Slotted screwdriver



OVERVIEW

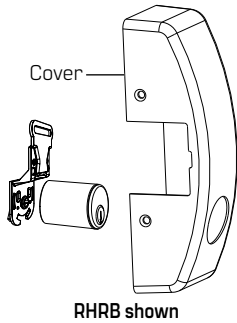

1 ASSEMBLING CYLINDER ASSEMBLY

- 1.1 Insert RIM cylinder into collar.
- 1.2 Position cylinder bracket over collar.
- 1.3 Place cylinder cam on collar.
- 1.4 Secure cylinder by tightening two screws.

NOTE: Cylinder tail must engage cylinder cam, but not protrude outside cam.

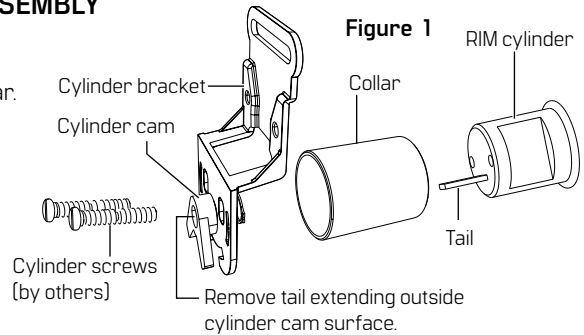

2 INSTALLING TRIM LOCKING ASSEMBLY

- 2.1 Remove two screws and install trim locking assembly.
- 2.2 Secure trim locking assembly onto lock stile case with two provided screws.

Figure 2

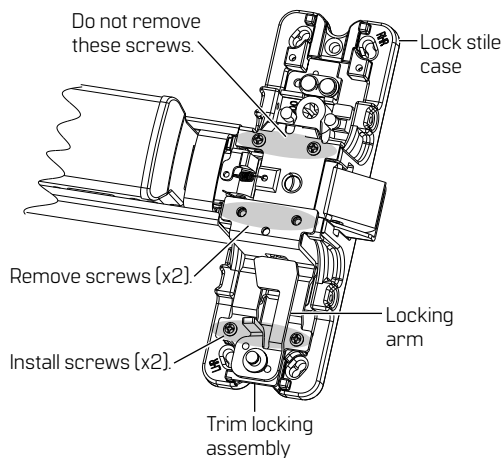

3 INSTALLING CYLINDER ASSEMBLY

- 3.1 Secure cylinder assembly to lock stile case with two provided screws.

Figure 3

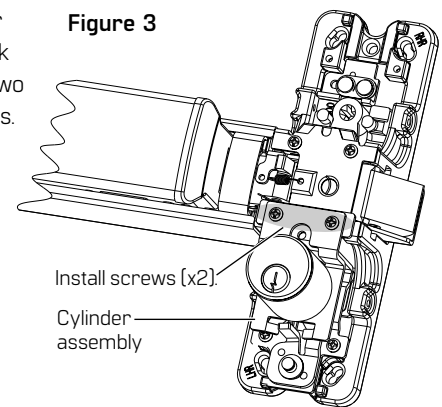

4 ASSEMBLING CYLINDER ASSEMBLY

- 4.1 Attach lock stile case to door.

NOTE: Trim finger must not be longer than 1-1/16" [26.99] past door surface.

NOTE: For 4908 or V4908 trim, see installation instructions packaged with trim.

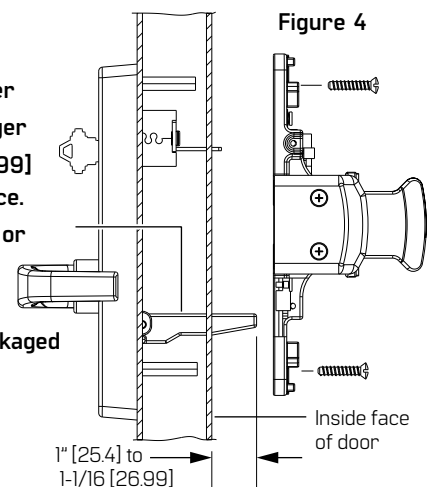

Document translations available.
Scan for product details and downloads.
Call 1-800-392-5209 or visit
<https://dhwsupport.dormakaba.com/hc/en-us>
for assistance and warranty information.

⚠ WARNING! This Manufacturer advises that no lock can provide complete security by itself. This lock may be defeated by forcible or technical means, or evaded by entry elsewhere on the property. No lock can substitute for caution, awareness of your environment, and common sense. Builder's hardware is available in multiple performance grades to suit the application. In order to enhance security and reduce risk, you should consult a qualified locksmith or other security professional.