

3900 Series Trim Conversion

For online instructions, assistance or warranty information:
Call 1-800-392-5209 or visit <https://dhwsupport.dormakaba.com/hc/en-us>

(SEE TEMPLATE FOR DOOR PREPARATION)

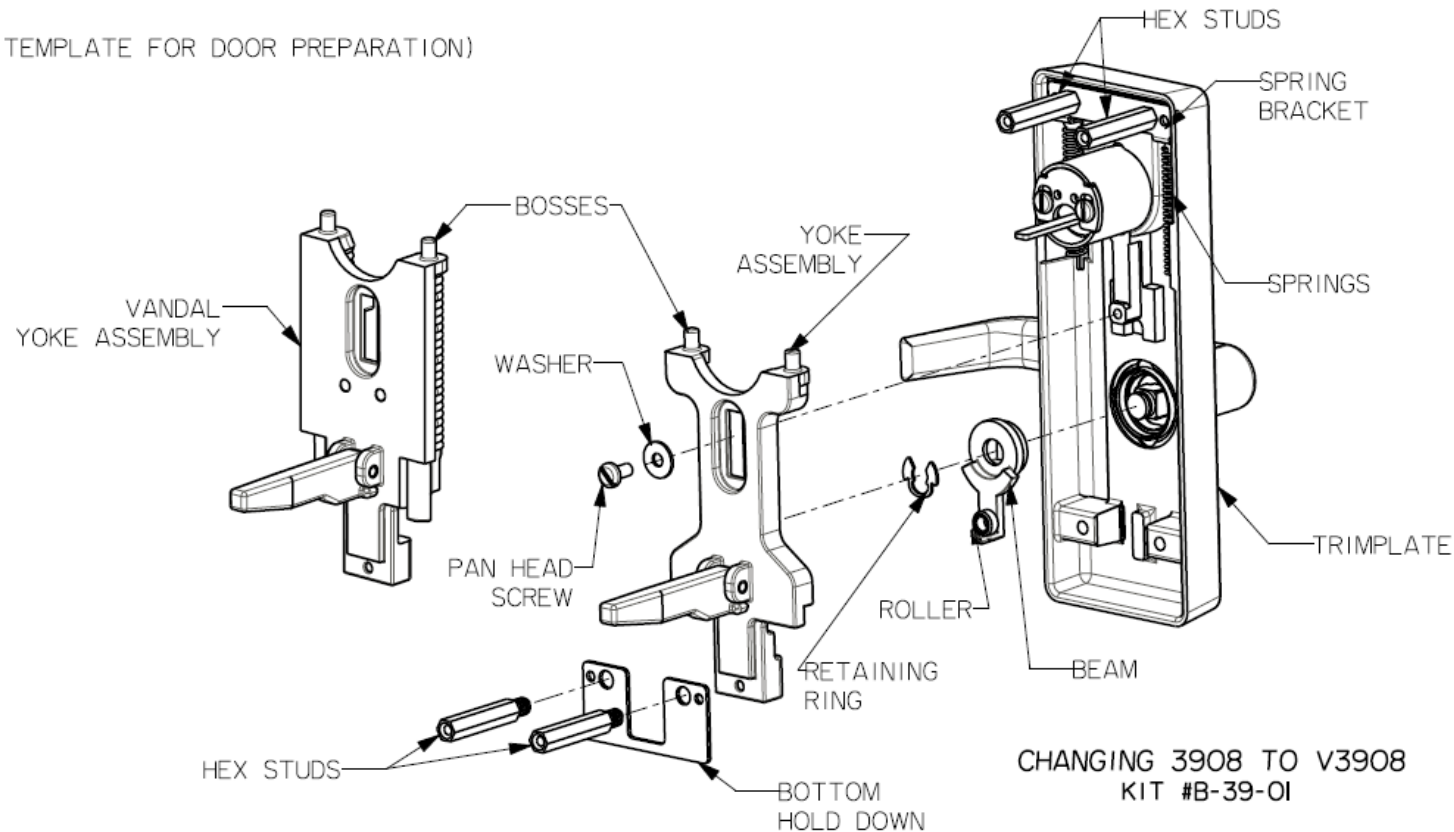

CHANGING 3902/3903 TRIM TO 3908/3914 KIT #FC-08 OR VFC-08

DISASSEMBLE

- 1) DISENGAGE BEAM FROM LEVER BY REMOVING RETAINING RING
- 2) REMOVE TOP AND BOTTOM HEX STUDS

REASSEMBLE

- 1) ROTATE BEAM 180° AND SECURE IT TO THE LEVER WITH RETAINING RING. PLACE ROLLER ONTO THE BEAM.
- 2) SPRING BRACKET AND SPRINGS WITH TOP STUDS AS SHOWN.
- 3) INSERT YOKE BOSES INTO SPRINGS AND PUSH UP TO SEAT YOKE ASSEMBLY INTO THE TRIMPLATE AND SECURE WITH SCREW AND WASHER.
- 4) SECURE BOTTOM HOLDDOWN WITH HEX STUDS.

CHANGING 3908 TO V3908 KIT #B-39-01

DISASSEMBLE

- 1) REMOVE BOTTOM HEX STUDS AND HOLDDOWN.
- 2) PULL OUT YOKE ASSEMBLY BY REMOVING SCREW AND WASHER.

REASSEMBLE

- 1) INSERT VANDAL YOKE BOSES INTO SPRINGS AND PUSH UP TO SEAT YOKE ASSEMBLY INTO THE TRIMPLATE AND SECURE WITH SCREW AND WASHER.
- 2) SECURE BOTTOM HOLDDOWN WITH HEX STUDS.