

Installation Instructions: Electric Lock / Unlock E-2103K Conversion Kit

For online instructions, assistance or warranty information:
Call 1-800-392-5209 or visit <https://dhwsupport.dormakaba.com/hc/en-us>

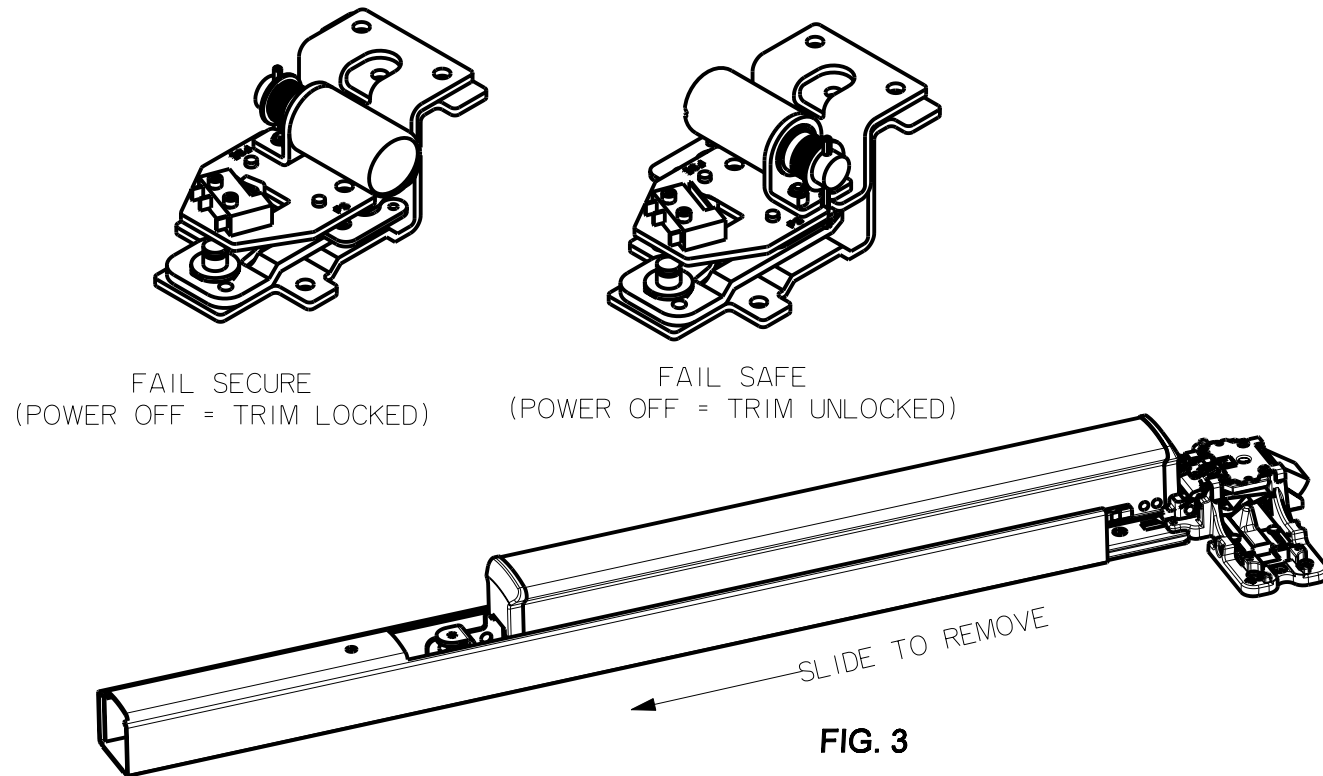

DISASSEMBLE:

- 1 - Remove the 2 channel screws (Fig. 1) Loosen set screw (Fig. 2) and slide device channel away from chassis (Fig.3)
- 2 - Remove the 2 Top plate screws shown and attach the Trim Locking Assembly with 2 screws (Fig.4)
- 3 - Attach the E-Locking Assembly with (2) 8-32 x 1/2" screws. (Fig. 5)
- 4 - Carefully route the wires through the Chassis, into the wire run slots and down the Subplate. Secure with tape. (Fig. 6)
- 5 - Slide device channel back to the chassis and secure with 2 screws. Snug the set screw and slide in the hinge filler into place.

OPERATION:

Applying 24 VDC across the green wires will cause the Locking Arm to move, a switch closure should appear across the blue and green wires. Refer to drawing #01853-II-000 for electrical information.

