

Trim Series: 2902, 2903, 2908, 2914 – Installation Instructions

TOOLS NEEDED:

Phillips screwdriver



Slotted screwdriver



1 INSTALLING RIM CYLINDER (2903 TRIM)

Kit number CA-2903

- 1.1 See appropriate template for door preparation.
- 1.2 Insert rim cylinder into trim.
- 1.3 Position sleeve by placing tabs into notches in trim plate.
- 1.4 Place strap on sleeve.
- 1.5 Secure cylinder by tightening screws.

Figure 1

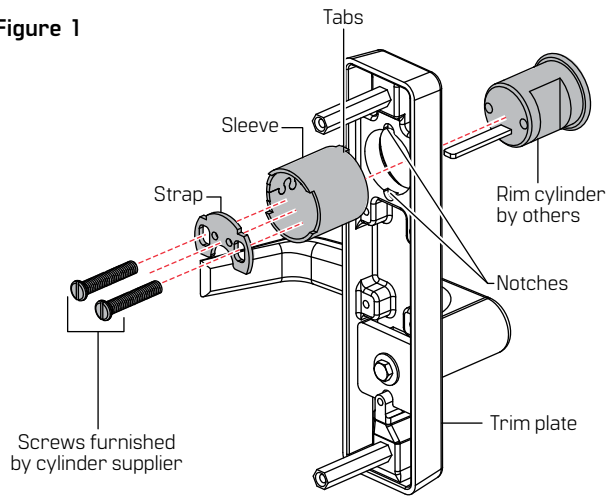

2 INSTALLING MORTISE CYLINDER (2908 TRIM)

Kit number CA-2908

- 2.1 See appropriate template for door preparation.
- 2.2 Insert mortise cylinder into trim.
- 2.3 Position sleeve by placing tabs into notches in trim plate.
- 2.4 Secure cylinder by tightening lock nut.

Figure 2

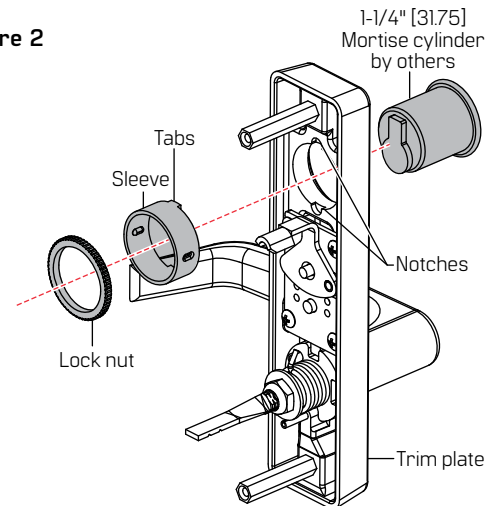

3 INSTALLING TRIM

- 3.1 See appropriate template for door preparation.
- 3.2 Insert cylinder tailpiece into cam or spindle extension into cam.
- 3.3 Secure chassis to trim with screws.

Figure 3

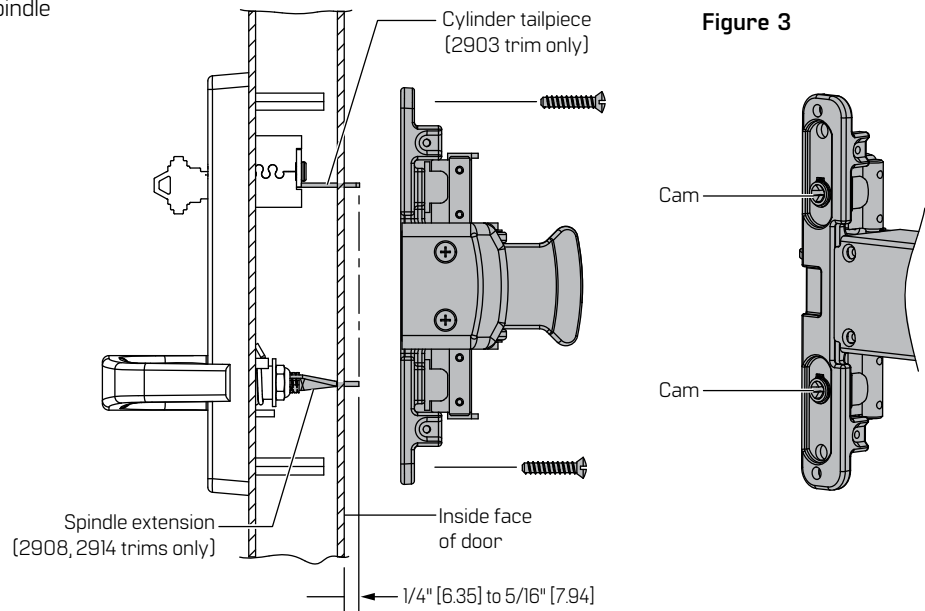

4 CHANGING HAND (2902, 2903 TRIM)

- 4.1 See appropriate template for door preparation.
- 4.2 Remove hex head screw and washer.
- 4.3 Pull lever out of lock plate and rotate 180°.
- 4.4 Insert lever into lock plate and attach with hex head screw and washer.

Figure 4

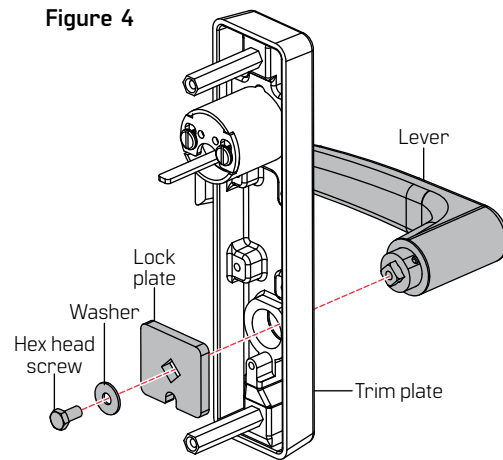

5 CHANGING HAND (2908, 2914 TRIM)

- 5.1 See appropriate template for door preparation.
- 5.2 Remove lever, lockout ring, spring, and mandrel by removing nylon stop nut.
- 5.3 Push rollpin through to opposite side of lockout ring.
- 5.4 Rotate lever 180°, insert lever with nylon washer into trim plate.
- 5.5 Place lockout ring on lever spindle, ensuring rollpin is facing you.
- 5.6 Position spring with lower leg against stop in trim plate, then place mandrel onto lever spindle.
- 5.7 Load spring by setting upper leg against rollpin in lockout ring, and secure by tightening nylon stop nut.

NOTE: If lever does not move freely, slightly loosen nylon stop nut.

Figure 5

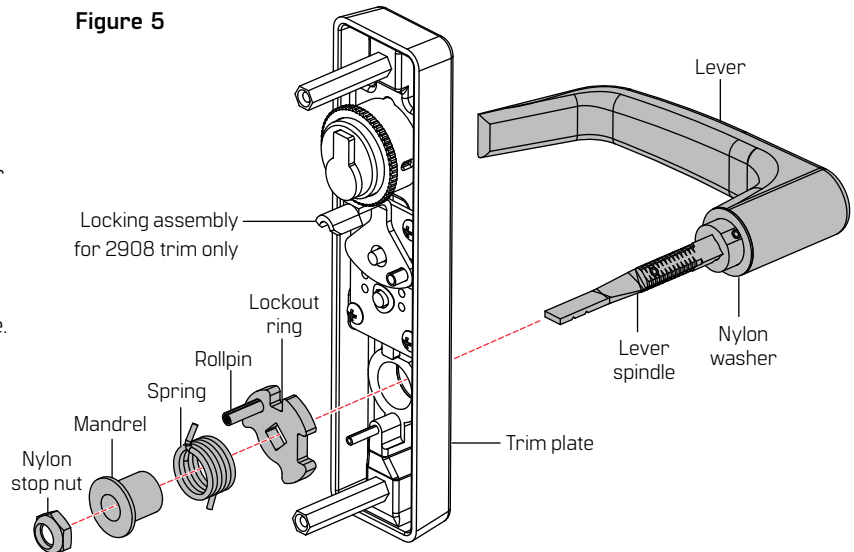

Document translations available.
Scan for product details and downloads.

Call 1-800-392-5209 or visit
<https://dhwsupport.dormakaba.com/hc/en-us>
for assistance and warranty information.

⚠ WARNING! This Manufacturer advises that no lock can provide complete security by itself. This lock may be defeated by forcible or technical means, or evaded by entry elsewhere on the property. No lock can substitute for caution, awareness of your environment, and common sense. Builder's hardware is available in multiple performance grades to suit the application. In order to enhance security and reduce risk, you should consult a qualified locksmith or other security professional.