

# MDC-10 Mortise Series Double Cylinder (10-Function) Installation Instructions

## TOOLS NEEDED:

Phillips screwdriver



Slotted screwdriver



### 1 ASSEMBLING CYLINDER

- 1.1 Insert RIM cylinder into collar.
- 1.2 Position cylinder bracket over collar.
- 1.3 Secure cylinder by tightening screws (x2).

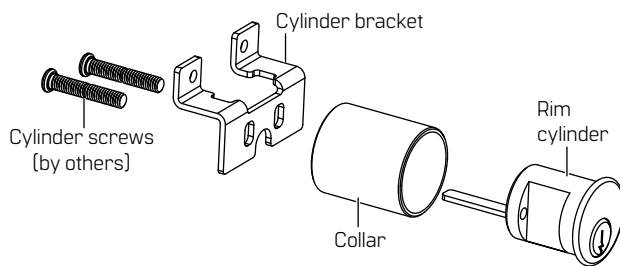

### 2 INSTALLING MORTISE LOCK AND CYLINDER

- 2.1 Install mortise lock into prepared opening in door.
- 2.2 Thread cylinder extension into mortise lock.
- 2.3 Secure assembly to lock by tightening provided screw.

**NOTE: Cam on cylinder extension must rotate freely inside mortise lock.**

**NOTE: Cam must be in vertical position.**

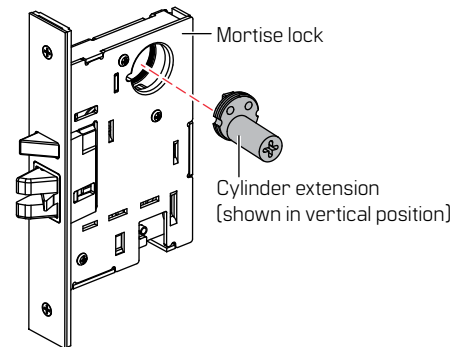

### 3 INSTALLING LOCK STILE CASE

- 3.1 Attach lock stile case to door.

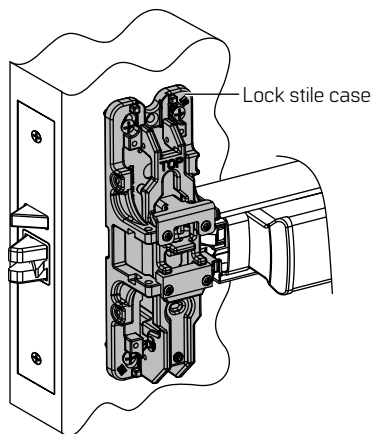

### 4 INSTALLING CYLINDER BRACKET

- 4.1 Secure cylinder bracket assembly onto lock stile case with two provided #8-32 screws.

**NOTE: Ensure rim cylinder tail engages properly with cross-cut in mortise cylinder extension.**

**NOTE: Cylinder tail may need to be cut to length.**

- 4.2 Assemble cover over lock components.

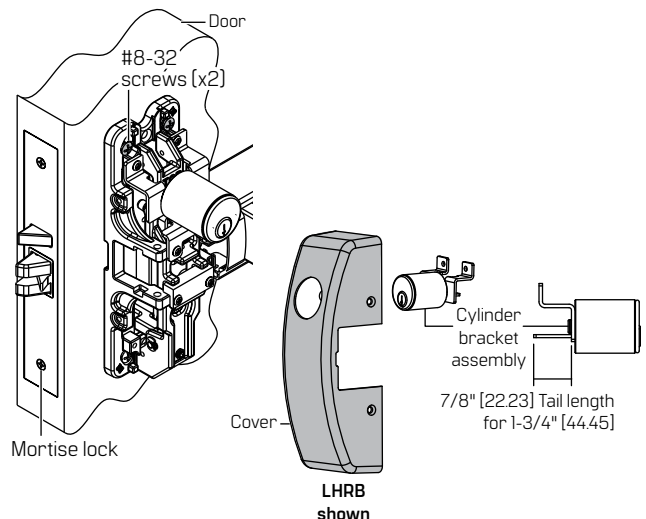

Document translations available.  
Scan for product details and downloads.  
Call 1-800-392-5209 or visit  
<https://dhwsupport.dormakaba.com/hc/en-us>  
for assistance and warranty information.

**⚠ WARNING!** This Manufacturer advises that no lock can provide complete security by itself. This lock may be defeated by forcible or technical means, or evaded by entry elsewhere on the property. No lock can substitute for caution, awareness of your environment, and common sense. Builder's hardware is available in multiple performance grades to suit the application. In order to enhance security and reduce risk, you should consult a qualified locksmith or other security professional.