

# Trim Conversion

## 4900 Series

Installation Instructions

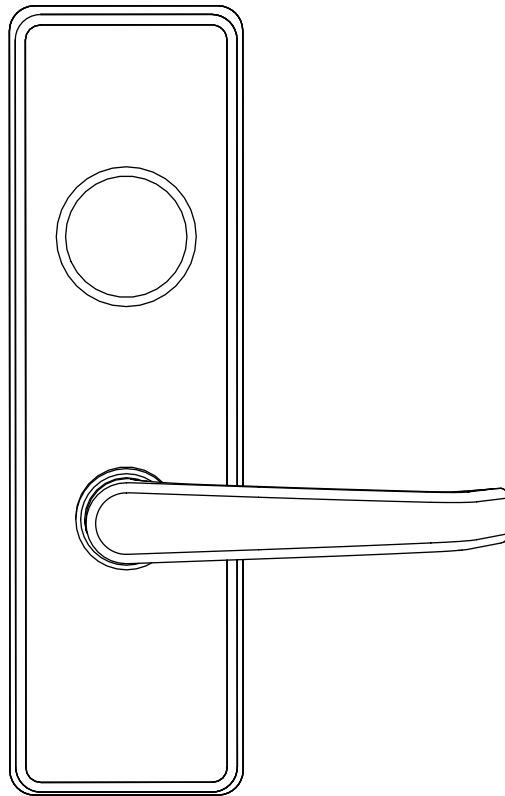

# Table of contents

<b>1</b>	<b>Important safety information</b>	<b>3</b>
1.1	Safety warnings	3
<b>2</b>	<b>Technical specifications</b>	<b>3</b>
2.1	Tools needed	3
2.2	Measurements	3
<b>3</b>	<b>Installation instructions</b>	<b>4</b>
3.1	Installing cylinder	4
3.2	Installing trim	4
<b>4</b>	<b>Changing hand</b>	<b>5</b>
4.1	Mortise yoke assembly	5
4.2	4 902 and 4 903 assembly [ 4 903 shown]	5
4.3	4 908, V 4 908, 4 9 1 4 assembly [ 4 908 shown]	6
<b>5</b>	<b>Converting trim</b>	<b>6</b>
5.1	Changing 4 902/4 903 trim to 4 908/4 9 1 4 [Kits #FC-0 8 or VFC-0 8]	6
5.2	Changing 4 908 trim to V 4 908 [Kit #B-4 9-0 1]	7
5.3	Changing 4 908/4 9 1 4 trim to 4 902/4 903	7
<b>6</b>	<b>Retro-fit applications</b>	<b>8</b>
6.1	Change stud locations	8

# 1 Important safety information

## 1.1 Safety warnings

1.1.1 Safety instructions: To reduce risk of injury or damage, carefully read and follow safety warnings, cautions and notices provided.

1.1.2 Safety warnings: Indicates a hazardous situation which, if not avoided, could result in death or serious injury.

 **WARNING**

1.1.3 Safety cautions: Indicates a hazardous situation which, if not avoided, could result in minor or moderate injury.

 **CAUTION**

1.1.4 Notice: Indicates information considered important but not directly hazard-related.

**NOTICE**

- Protect inside of device from metal shavings.

# 2 Technical specifications

## 2.1 Tools needed

Table 1

Phillips head screwdriver	Level
Flat head screwdriver	

## 2.2 Measurements

2.2.1 All dimensions are given in inches [millimeters].

# 3 Installation instructions

## 3.1 Installing cylinder

Fig. 1, Fig. 2

### Rim cylinder

- 3.1.1 See appropriate template for door preparation.
- 3.1.2 Insert rim cylinder into trim.
- 3.1.3 Position sleeve by placing tabs into notches in trim plate.
- 3.1.4 Place strap on sleeve.
- 3.1.5 Secure cylinder by tightening screws.

Figure 1 Rim cylinder

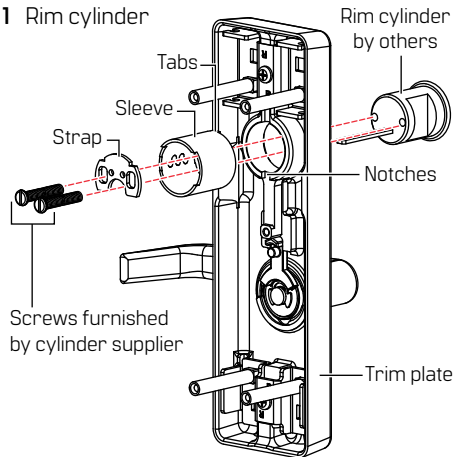

### Mortise cylinder

- 3.1.6 See appropriate template for door preparation.
- 3.1.7 Thread cylinder into mortise lock through trim assembly.
- 3.1.8 Secure with screw through mortise lock front.

Figure 2 Mortise cylinder

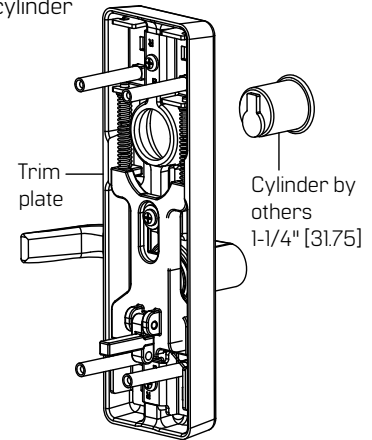

## 3.2 Installing trim

Fig. 3, Table 2

- 3.3.1 See appropriate template for door preparation.

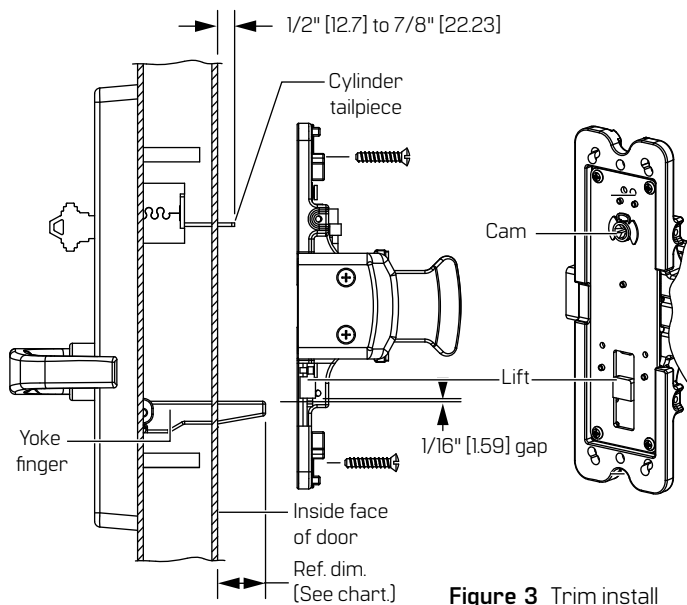

Figure 3 Trim install

Table 2

Device type	Door thickness	Reference dim.
Touchbar device	1-3/4" [44.45]	1-1/16" [26.99]
	2" [50.8]	1 3/16" [20.64]
	2-1/4" [57.15]	9/16" [14.29]
Crossbar device	1-3/4" [44.45]	1/2" [12.7]
	2" [50.8]	1/4" [6.35]
	2-1/4" [57.15]	Flush

**NOTE: Reference dimension does not apply to mortise device trims.**

### For devices with cylinder function

- 3.3.2 Insert cylinder tailpiece into cam.

### For devices with active level or knob

- 3.3.3 Secure chassis to trim with screws.

**NOTE: Ensure yoke finger is under lift with 1/16" [1.59] gap.**

# 4 Changing hand

## 4.1 Mortise yoke assembly

Fig. 4

- 4.1.1 See appropriate template for door preparation.
- 4.1.2 Remove trim finger by removing groove pin.
- 4.1.3 Rotate finger 180° and reassemble with groove pin.

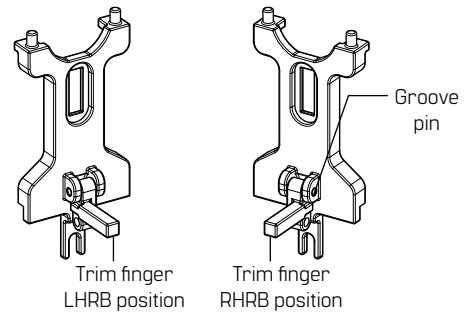

**Figure 4** Mortise yoke assembly

## 4.2 4902 and 4903 assembly [4903 shown]

Fig. 5

- 4.2.1 See appropriate template for door preparation.
- 4.2.2 Remove beam by removing retaining ring.
- 4.2.3 Rotate lever 180°.
- 4.2.4 Position beam in notch, then secure it to lever with retaining ring.

**Figure 5** 4903 trim

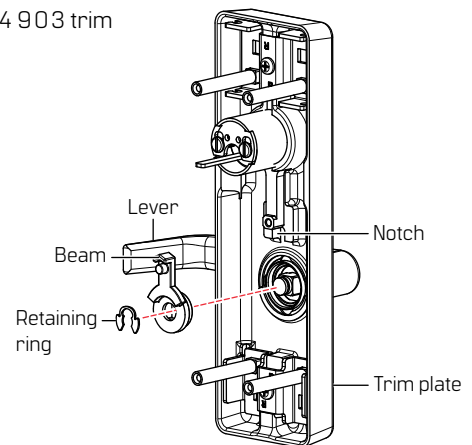

## 4.3 4908, V4908, 4914 assembly (4908 shown)

Fig. 6

### Disassemble

- 4.3.1 See appropriate template for door preparation.
- 4.3.2 Remove bottom bracket with trim studs by removing pan head screw.
- 4.3.3 Remove yoke assembly by removing screw.
- 4.3.4 Remove beam from lever by removing retaining ring.

### Reassemble

- 4.3.5 Rotate lever 180° and secure lever to beam with retaining ring.
- 4.3.6 Insert yoke bosses into springs, then push up to seat yoke assembly into trim plate and secure with pan head screw and washer.
- 4.3.7 Secure bottom bracket and trim studs with pan head screw.

Figure 6 4908 trim

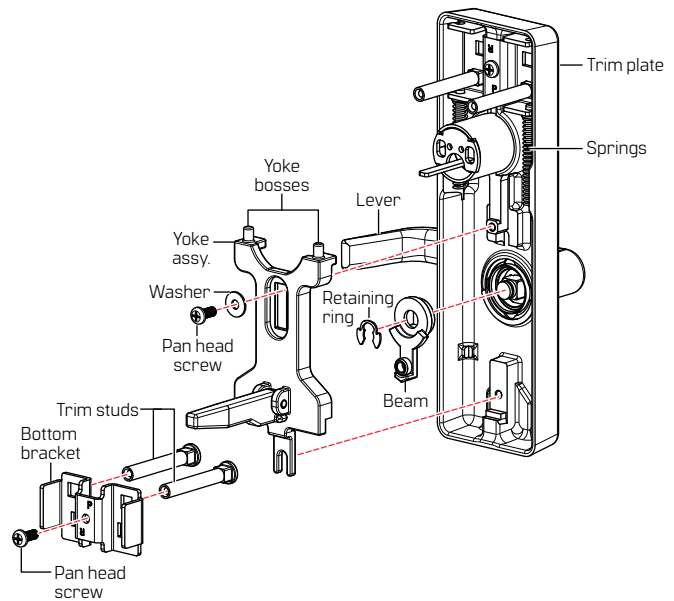

## 5 Converting trim

### 5.1 Changing 4902/4903 trim to 4908/4914 (Kit #FC-08 or VFC-08)

Fig. 7

### Disassemble

- 5.1.1 See appropriate template for door preparation.
- 5.1.2 Remove beam from lever by removing retaining ring.
- 5.1.3 Remove bottom bracket with trim studs by removing pan head screw.

### Reassemble

- 5.1.4 Rotate beam 180° and, then secure it to lever with retaining ring.
- 5.1.5 Place roller onto beam.
- 5.1.6 Insert spring seats into top bracket, then insert springs onto spring seats, as shown in Fig. 7.
- 5.1.7 Insert yoke bosses into springs, then push up to seat yoke assembly into trim plate and secure with pan head screw and washer.
- 5.1.8 Secure bottom bracket and trim studs with pan head screw.

Figure 7 4902/4903 trim to 4908/4914 trim

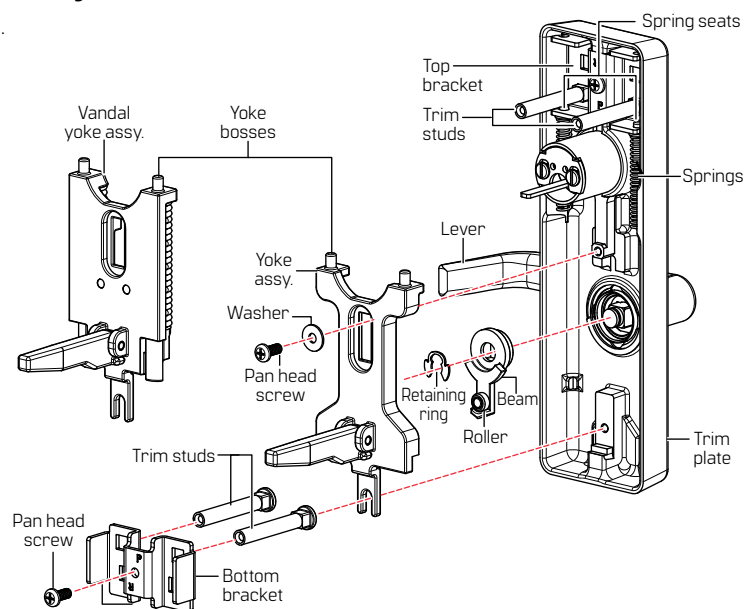

## 5.2 Changing 4908 trim to V4908 (Kit #B-49-01)

Fig. 8

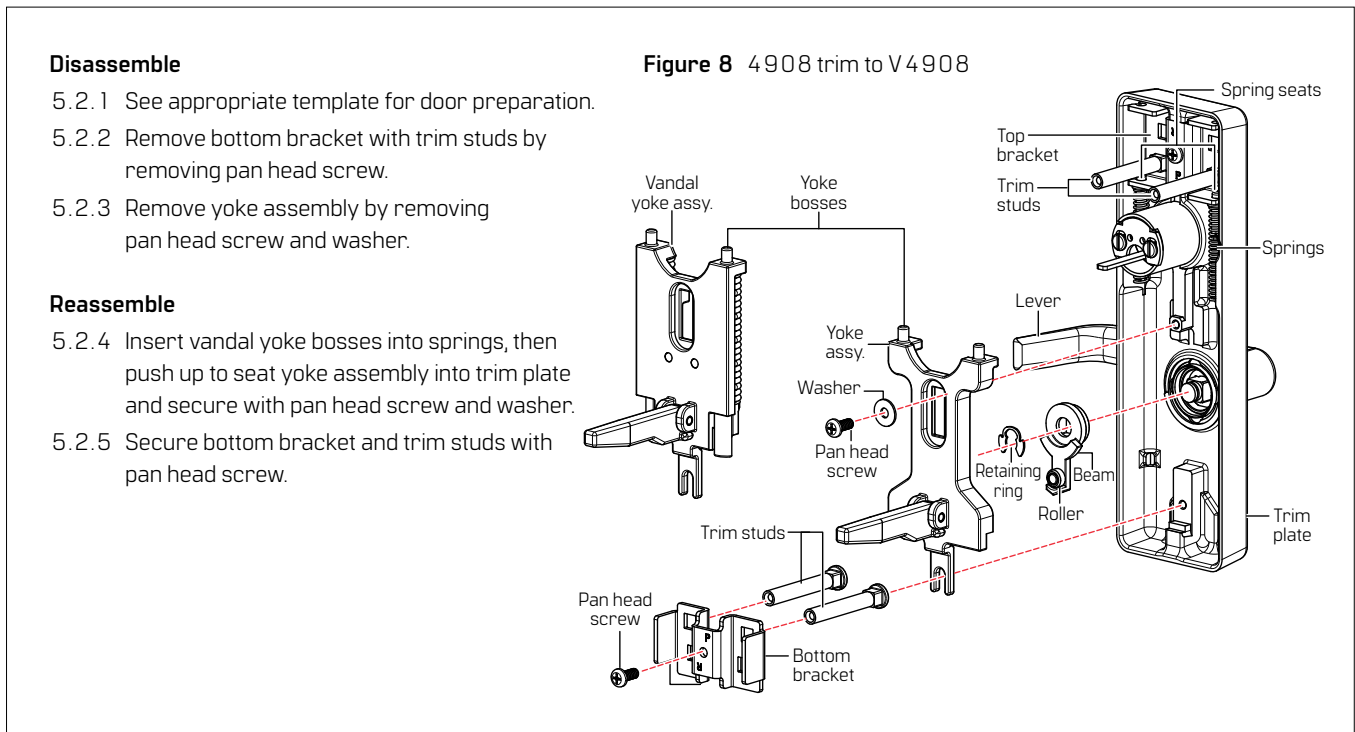

## 5.3 Changing 4908/4914 trim to 4902/4903

Fig. 9

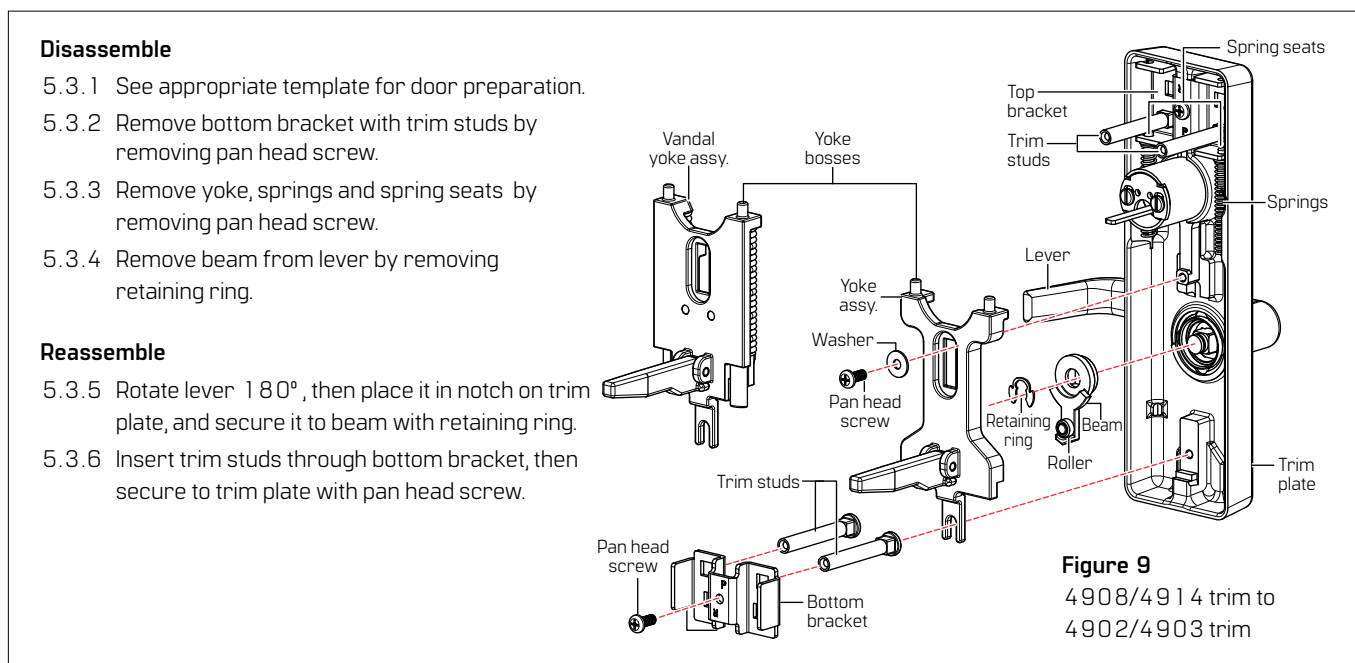

# 6 Retro-fit applications

## 6.1 Change stud locations

Fig. 10, Fig. 11, Fig. 12

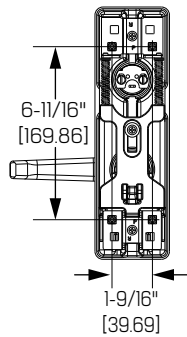

**Figure 10**  
BEST stud location

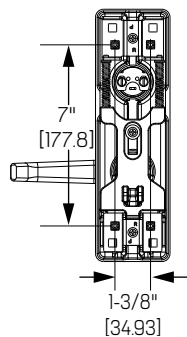

**Figure 11**  
Retro-fit location

### Changing stud locations

- 6.1.1 See appropriate template for door preparation.
- 6.1.2 Remove yoke assembly, screws and brackets.
- 6.1.3 Rotate brackets 180°.
- 6.1.4 Push trim studs through bottom bracket at correct location.
- 6.1.5 Replace spring seats and springs into top bracket.
- 6.1.6 Re-attach top bracket and yoke assembly.
- 6.1.7 Fasten bottom bracket.

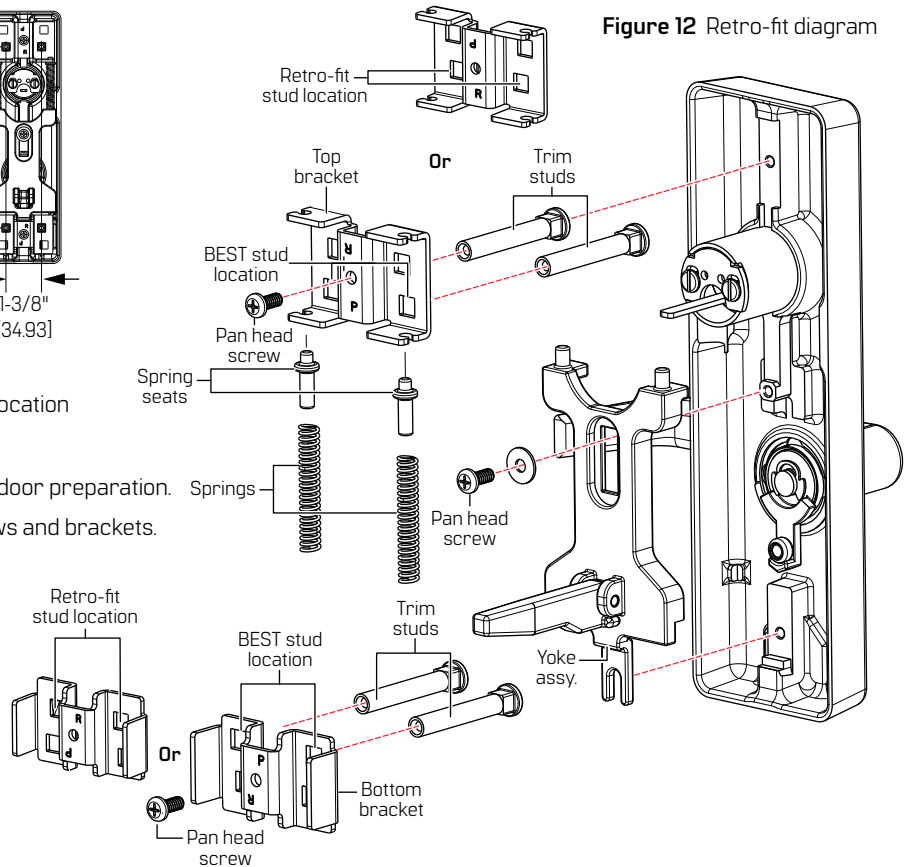

**Figure 12** Retro-fit diagram



Document translations available.

Scan for product details and downloads.

Call 1-800-392-5209 or visit

<https://dhwsupport.dormakaba.com/hc/en-us>

for assistance and warranty information.

**⚠ WARNING!** This Manufacturer advises that no lock can provide complete security by itself. This lock may be defeated by forcible or technical means, or evaded by entry elsewhere on the property. No lock can substitute for caution, awareness of your environment, and common sense. Builder's hardware is available in multiple performance grades to suit the application. In order to enhance security and reduce risk, you should consult a qualified locksmith or other security professional.