

1 INSTALLING RIM CYLINDER

NOTE: Refer to appropriate template for door preparation.

- 1.1 Insert rim cylinder into trim plate.
- 1.2 Position sleeve by placing tabs into notches in trim plate.
- 1.3 Place strap on sleeve.
- 1.4 Secure cylinder by tightening screws.

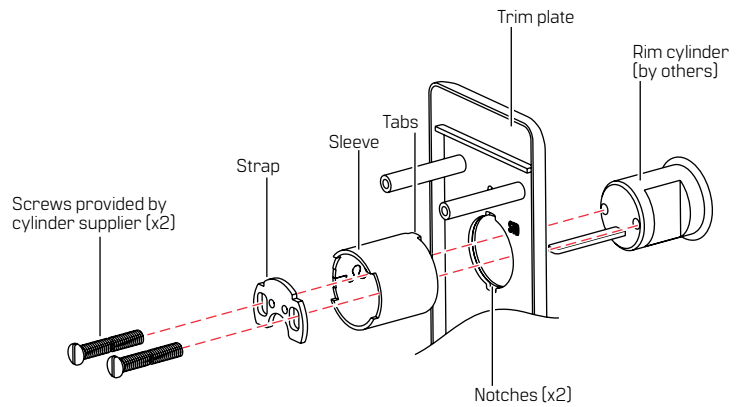

2 INSTALLING TRIM

- 2.1 For devices with cylinder function, insert cylinder tailpiece into cam.

NOTE: For devices with thumbpiece, make sure trim is under lift with 1/16" [27] gap.

- 2.2 Secure chassis to trim with screws.

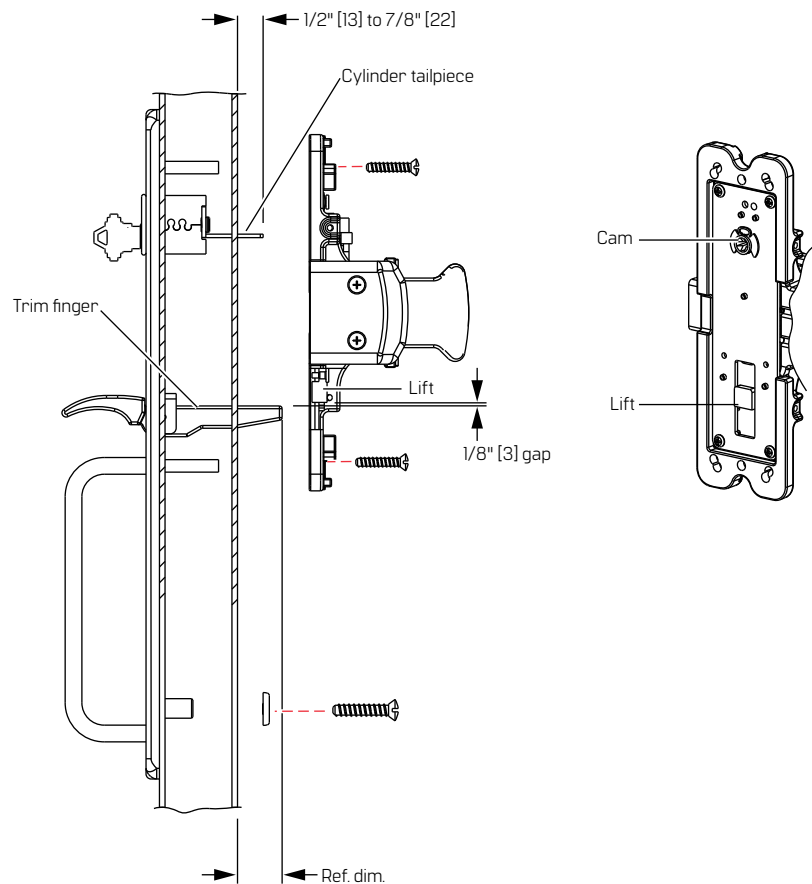

Device type	Door thk.	Ref. Dim.
Touchbar device	1-3/4" [45]	1" [25]
	2" [50]	3/4" [19]
	2-1/4" [57]	1/2" [13]
Crossbar device	1-3/4" [45]	7/16" [11]
	2" [50]	3/16" [5]
	2-1/4" [57]	-1/16" [-2]

NOTE: Ref. dim. does not apply to mortise device trims.

3 INSTALLING MORTISE TRIM CYLINDER (M1705, M1715)

- 3.1 Thread cylinder into mortise lock through trim assembly.
- 3.2 Secure with screw through mortise lock front.

Trim finger LHRB position

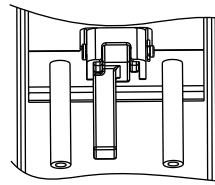

Trim finger RHRB position

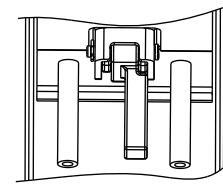

4 CHANGING HANDING ON MORTISE TRIM

- 4.1 Remove trim finger by removing retaining ring and pivot pin.
- 4.2 Rotate trim finger 180° and reassemble with pivot pin and retaining ring.

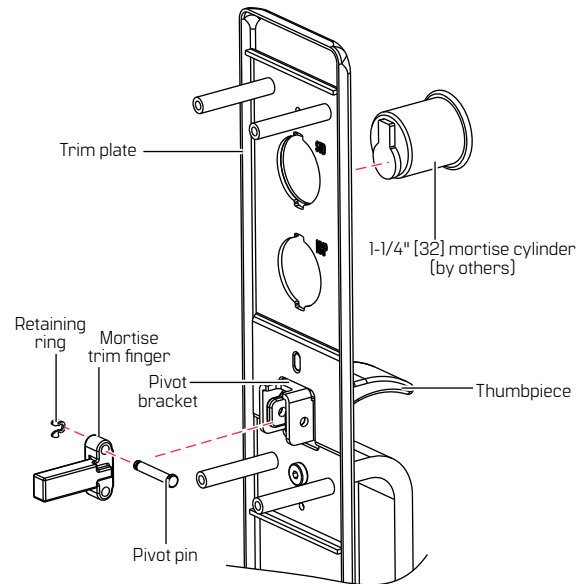

5 INSTALLING SERIES C1700 TRIM

How to convert standard 1700A and 1700C series trim for 2800 series concealed vertical rod devices:

- 5.1 Remove trim stud by removing screw.
- 5.2 Rotate trim stud 90° and secure with screw.

C1700A and C1700C series trim

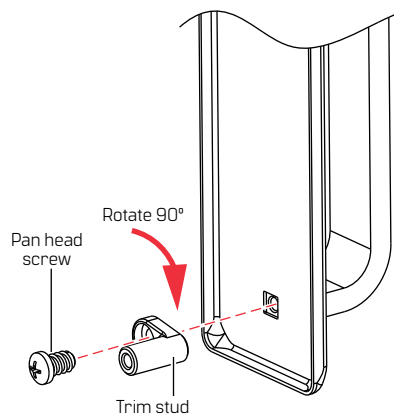

C1700B series trim

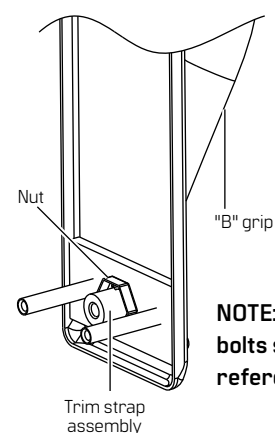

NOTE: Bottom thru bolts shown for reference only.



Document translations available.
Scan for product details and downloads.
Call 1-800-392-5209 or visit
<https://dhwsupport.dormakaba.com/hc/en-us>
for assistance and warranty information.

⚠ WARNING! This Manufacturer advises that no lock can provide complete security by itself. This lock may be defeated by forcible or technical means, or evaded by entry elsewhere on the property. No lock can substitute for caution, awareness of your environment, and common sense. Builder's hardware is available in multiple performance grades to suit the application. In order to enhance security and reduce risk, you should consult a qualified locksmith or other security professional.