

HD8000 FH/FHJ/FHP

Friction hold open for regular,
top jamb and parallel mounts

Installation Instructions

OVERVIEW

- 1** Closer body
- 2** Connecting arm
- 3** Bar and shoe
- 4** Pinion screw
- 5** Flat head screws
- 6** Pan head screws
- 7** Connecting arm screw and nut
- 8** PA shoe screws
- 9** PA bracket
- 10** Cover
- 11** Plates
- 12** Full metal cover

Regular mount

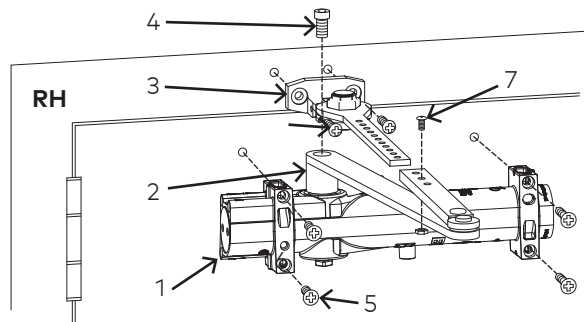

Top jamb mount

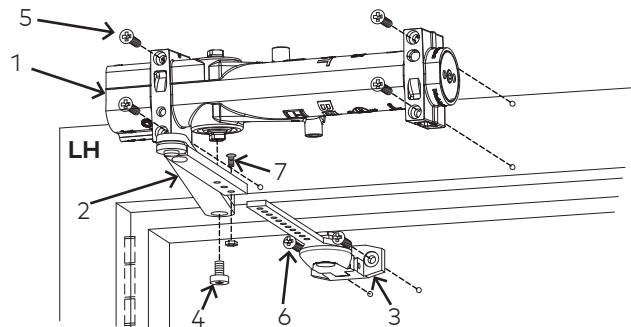

Parallel mount

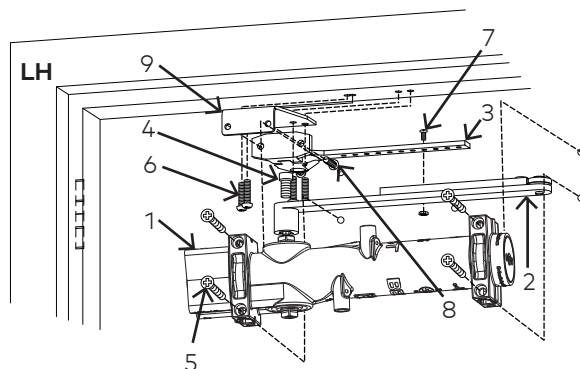









Table of contents

1	Technical specifications	3
1.1	Overview	3
1.2	Tools recommended	3
1.3	Handing the door	3
1.4	Surface closer components	3
2	Installation - regular mount	4
2.1	Surface closer system	4
2.2	Installing the surface closer and (optional) backplate	4
2.3	Installing main arm	4
3	Instructions - top jamb mount	5
3.1	Surface closer system	5
3.2	Installing the surface closer and (optional) backplate	5
3.3	Installing main arm	5
4	Instructions - parallel mount	6
4.1	Surface closer system	6
4.2	Installing the surface closer and (optional) backplate	6
4.3	Installing main arm	6
5	Adjustments	7
5.1	Adjust closing speeds: sweep, latch, backcheck, delayed action if applicable	7
5.2	Adjust optional hold open	7
5.3	Adjust spring force	7
6	Install covers	8

1 Technical specifications

1.1 Overview

-  Caution: sex nuts are required for attachment of components to unreinforced doors and to wood or plastic faced composite type fire doors, unless an alternative method is identified in the individual door manufacturer's listings.
-  Maximum door opening degree is 180°.
-  Maximum 4-1/2" reveal on top jamb mounts for 180° degree openings.
-  Hold open range is from 30° to 140° with optional hold open kit.
-  Know the swing of the door which is being installed prior to installation.
-  Verify closer spring size prior to installation.
-  Make sure door efficiently operates prior to installing closer.
-  Do not hammer arm onto spindle. Warranty will be void.

1.2 Tools recommended

Table 1

Drill bits:	#3 Phillips screwdriver
Metal: 7/32" drill bit; #12-24 tap	3/16" flat head screwdriver
Wood: 3/8" and 5/32" bit	5mm hex key
1/2" box wrench	10" adjustable wrench

1.3 Handing the door

Fig.1

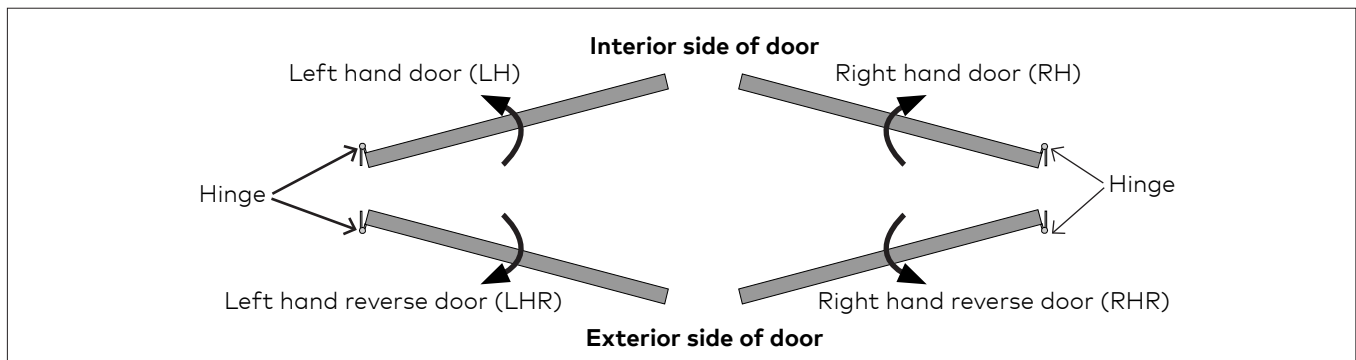

1.4 Surface closer components

The surface closer is comprised of the following components.

1. Closer body
2. Connecting arm
3. Bar and shoe
4. Pinion screw
5. Flat head screws
6. Pan head screws
7. Connecting arm screw and nut
8. PA shoe screws
9. PA bracket
10. Cover
11. Plates
12. Full metal cover

2 Installation - regular mount

2.1 Surface closer system

Fig.2

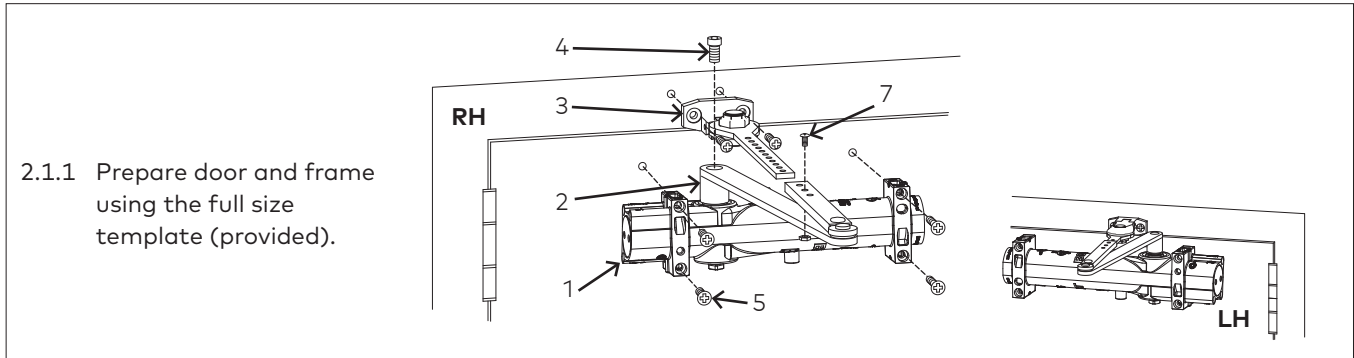

2.2 Installing the surface closer and (optional) backplate

Fig.3

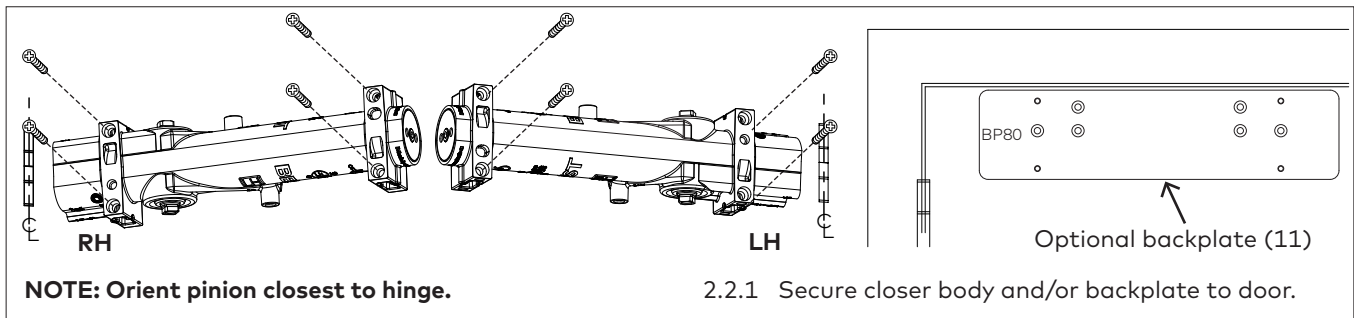

2.3 Installing main arm

Fig.4

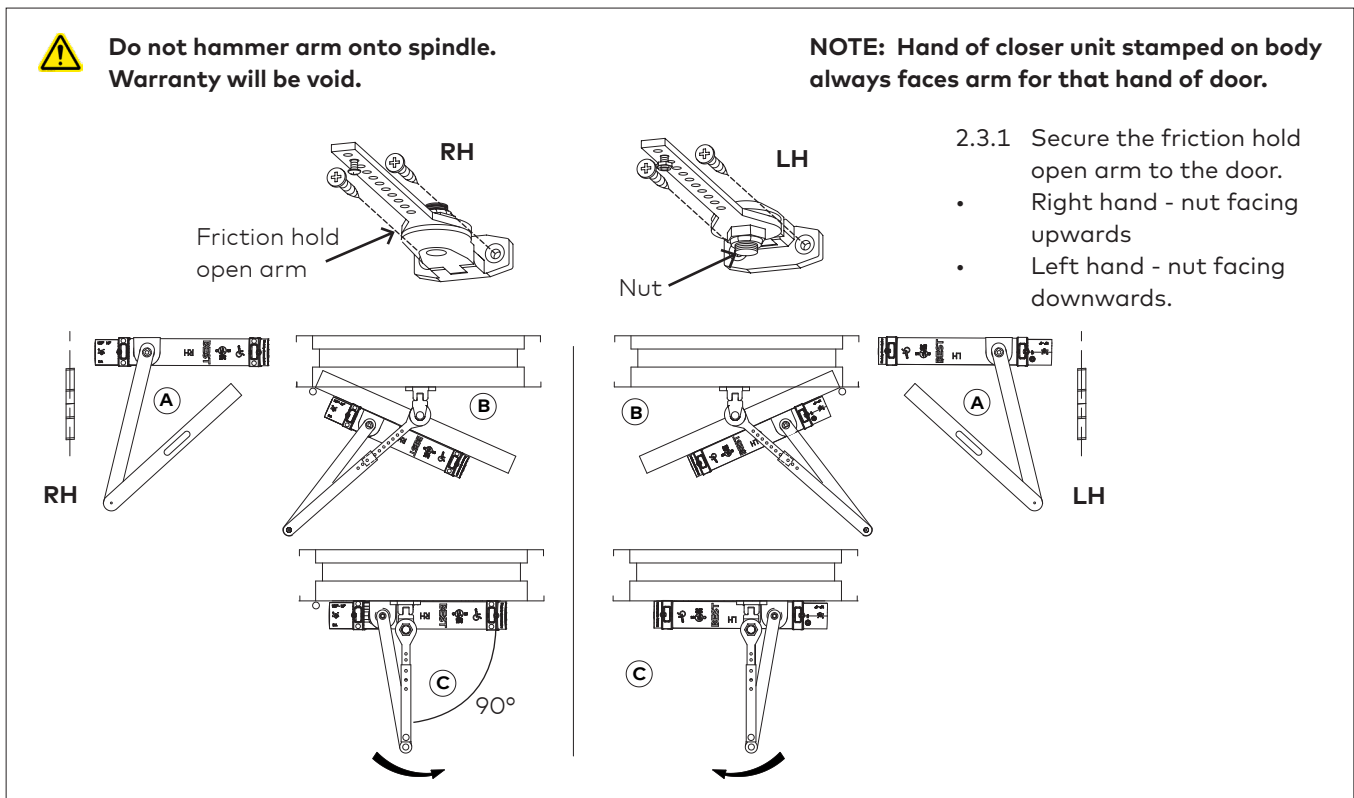

3 Instructions - top jamb mount

3.1 Surface closer system

Fig.5

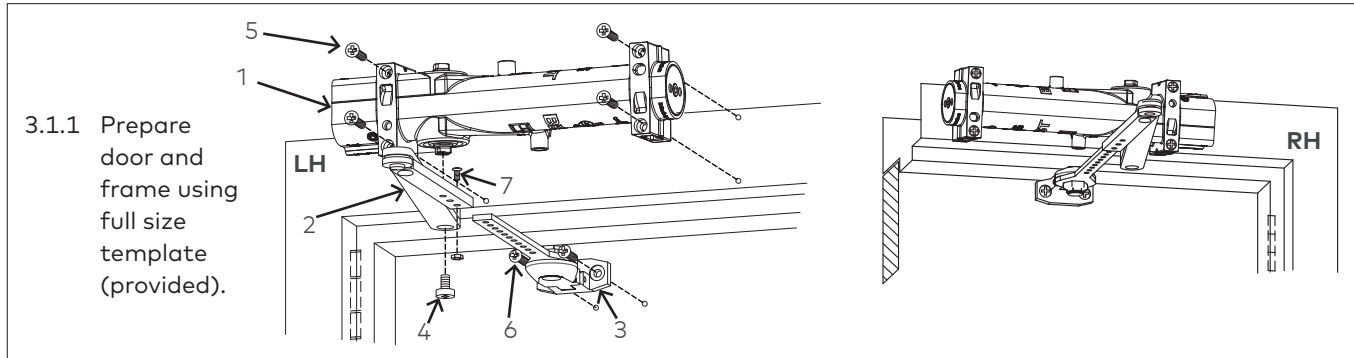

3.2 Installing the surface closer and (optional) backplate

Fig.6

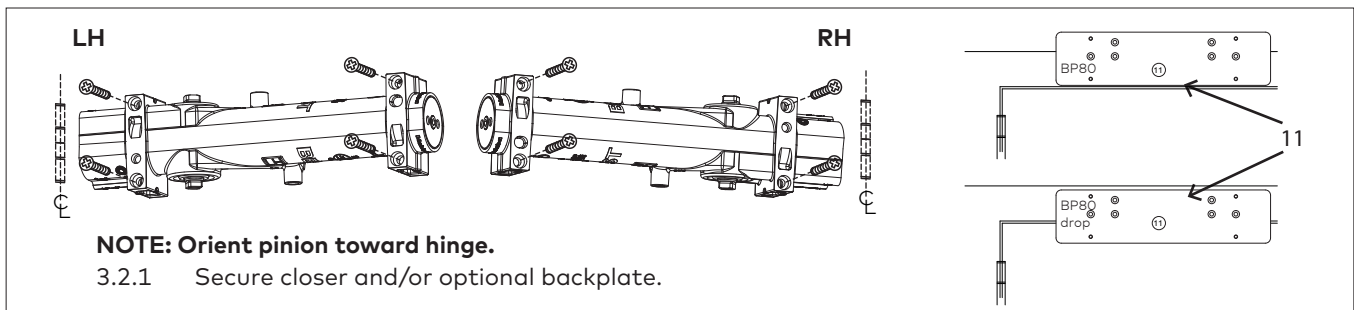

3.3 Installing main arm

Fig.7

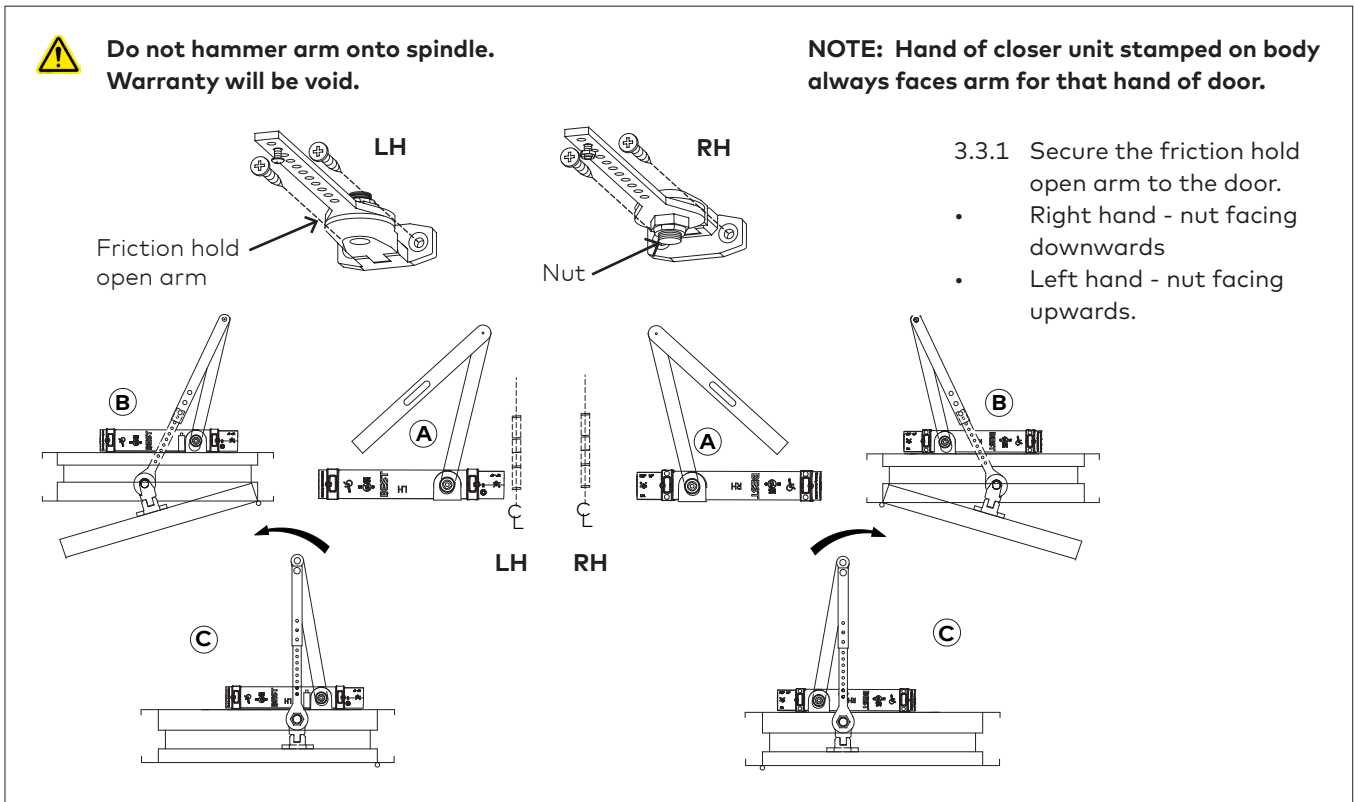

4 Instructions - parallel mount

4.1 Surface closer system

Fig.8

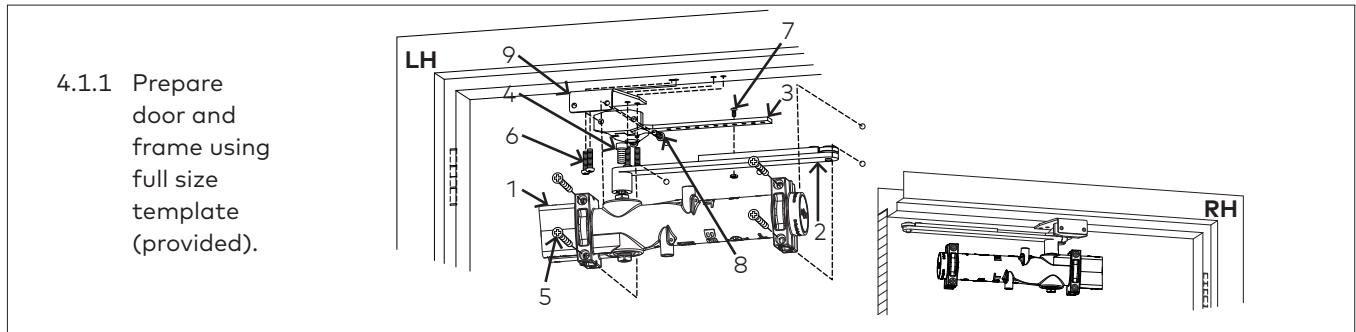

4.2 Installing the surface closer and (optional) backplate

Fig.9

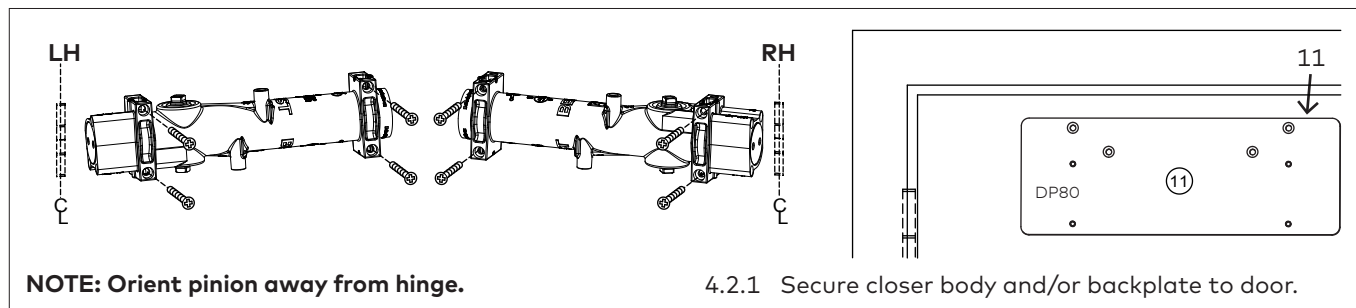

4.3 Installing main arm

Fig.10

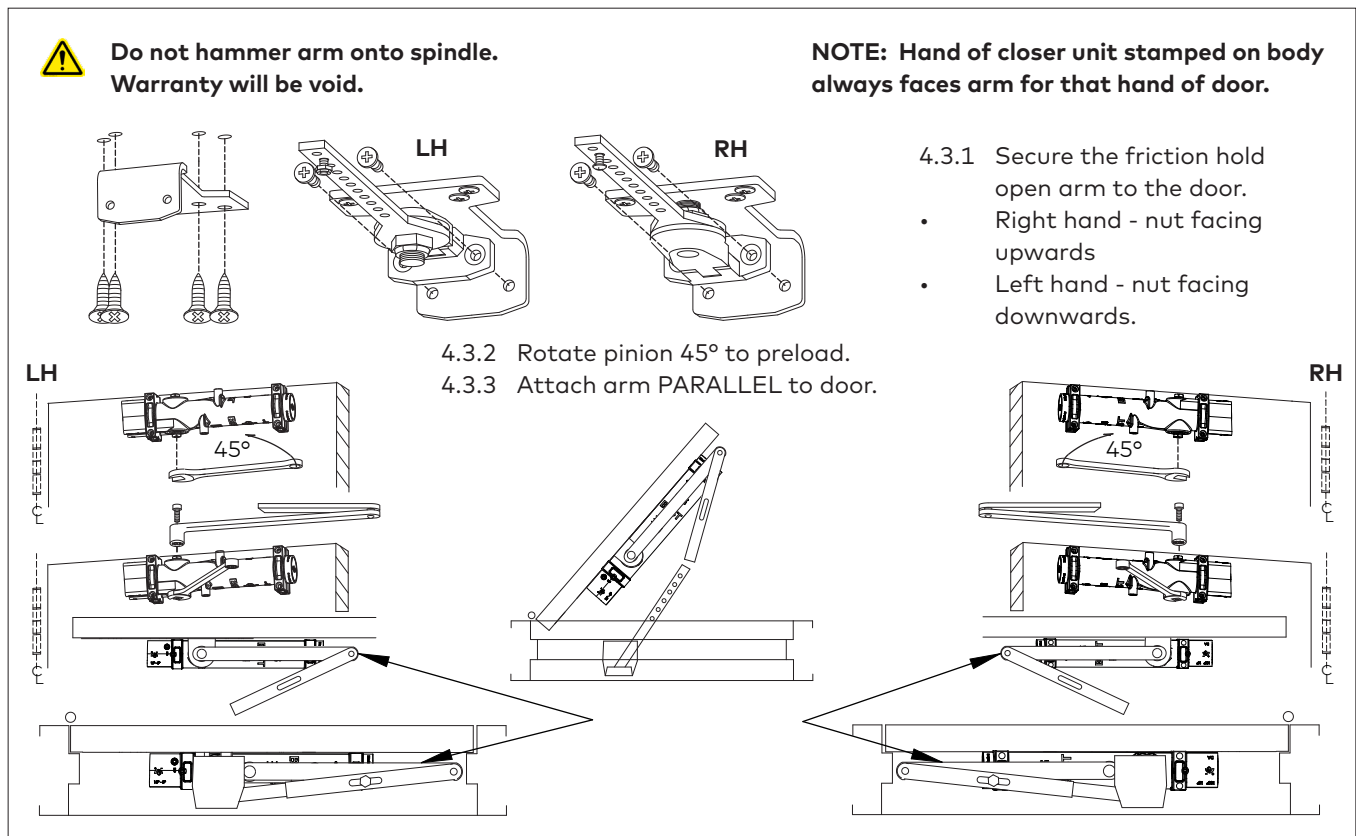

5 Adjustments

- ⚠ Confirm closer spring size prior to making any closing speed adjustments.
- ⚠ Do not back valve heads out beyond closer casting.

- ⚠ Maximum opening angle is 85° to 170°.
- ⚠ Door should close in 3 to 6 seconds from 90°.
- ⚠ Do not close valves completely.

5.1 Adjust closing speeds: sweep, latch, backcheck, delayed action if applicable

Fig.11

NOTE: Delayed action and advanced variable backcheck are optional.

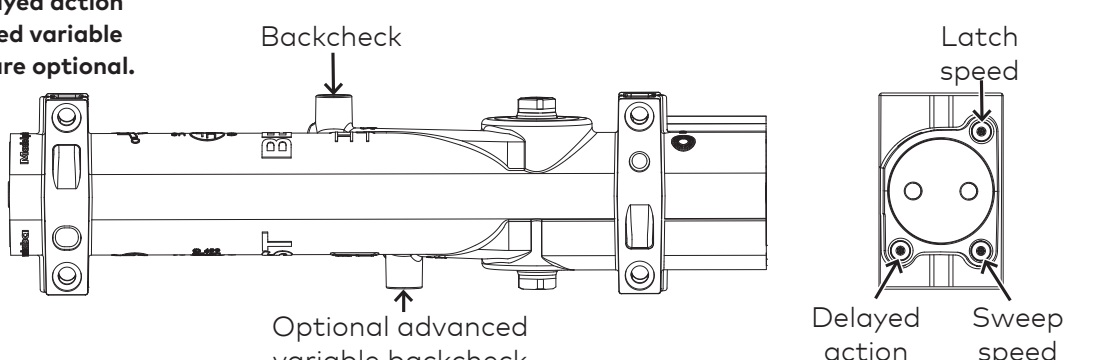

Backcheck

Optional advanced variable backcheck

Latch speed

Delayed action Sweep speed

NOTE: Advanced variable backcheck is shipped in the "ON" fully CW position.
 NOTE: Advanced variable backcheck must remain "ON" for **parallel arm mounts**.
 NOTE: Advanced variable backcheck will advance approximately 15° in the "ON" position.
 NOTE: Turn off advanced variable backcheck by rotating valve CCW.

Decrease Sweep, Latch & Delayed Action

Increase

Increase Backcheck

Decrease

- 5.1.1 Adjust **closing sweep speed**: 70° to start of latch speed.
- Increase sweep speed: Turn valve counter-clockwise.
 - Decrease sweep speed: Turn valve clockwise.
- 5.1.2 Adjust **closing latch speed**: 15° to close.
- Increase latch speed: Turn valve counter-clockwise.

- 5.1.3 Adjust **opening backcheck**: beginning at 65°.
- Increase resistance: Turn valve clockwise.
 - Decrease resistance: Turn valve counter-clockwise.
- 5.1.4 If applicable, adjust **closing delayed action**: angle 180° to start of sweep.
- Increase delayed action: Turn valve counter-clockwise.
 - Decrease delayed action: Turn valve clockwise.

5.2 Adjust optional hold open

Fig.12

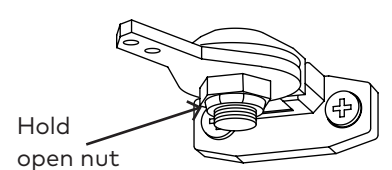

Hold open nut

- 5.2.1 Loosen hold open nut.
- 5.2.2 Open door 3° - 5° before desired hold open position.
- 5.2.3 Tighten hold open nut securely.
- 5.2.4 Pull door closed.

- 5.2.5 Open door to hold open position.
- (Do not push door beyond hold open position. An auxiliary stop must be used to limit door swing.)
- 5.2.6 To disengage, pull door closed until hold open releases and door closer takes over.

5.3 Adjust spring force

Fig.13

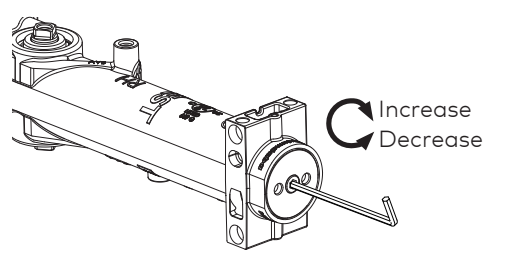

Increase Decrease

HD8016

Barrier free openings: Take an opening force reading from the pull on the door. If required, adjust the spring force to meet the barrier-free requirement.

- **Decrease force:** Turn counter-clockwise.
- **Increase force:** Turn clockwise.

Depending on opening conditions, a door adjusted to meet barrier-free forces may not have sufficient power to reliably close and latch the door.

Regular and top jamb mounts					
	Closer size	Max door weight (lbs)	Door width		Full turns
			Interior	Exterior	
HD8016	2	100	2'6"	---	-20
	3	125	3'	2'6"	-12
	4	150	3'6"	3'	0
	5	200	4'	3'6"	+4
	6	250	---	4'	+12
HD8056	5	200	4'	3'6"	-6
	6	250	---	4'	0
Parallel mount					
HD8016	3	100	2'6"	----	-12
	4	125	3'	2'6"	0
	5	150	3'6"	3'	+4
	6	200	4'	3'6"	+12
HD8056	5	150	3'6"	3'	-6
	6	200	4'	3'6"	6
	6+	250	---	4'	6+

6 Install covers

Fig.14

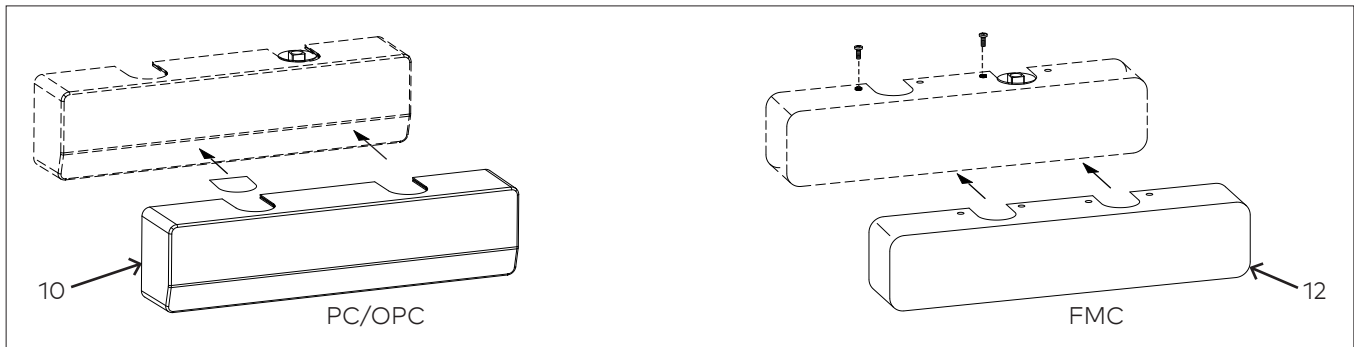

For Complete Online Instructions Visit:
<https://dhwsupport.dormakaba.com/hc/en-us>

For Assistance or Warranty Information:
 Call 1-800-392-5209 or visit
<https://dhwsupport.dormakaba.com/hc/en-us>