

D900 MORTISE DEAD BOLT

Installation Instructions



Overall Exploded View

Tools required for installation

#2 Phillips screwdriver

D900 with standard thumb turn part list

- 1 - Thumb turn assembly
- 2 - 6-32 x 3/8" machine screws
- 3 - Cylinder ring
- 4 - Wave washer
- 5 - Mortise cylinder
- 6 - 8-32 x 1/4" flat head screws
- 7 - Armor plate
- 8 - 12-24x1" combo screws
- 9 - Chassis
- 10 - #6 x 1/2" wood screws

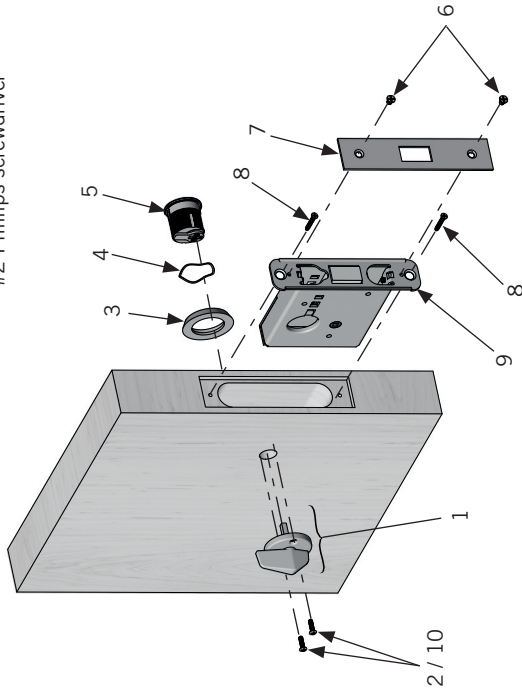

1. Install lock body

1.1 Place the lock body into the door edge.

⚠ Orient such that the cylinder hole is towards the top of the chassis.

1.2 Secure with two 12-24x1" combo screws.

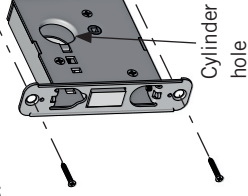

1

2. Assemble and install mortise cylinder.

Conventional mortise cylinder

2.1A Slide the wave washer and cylinder ring over the cylinder.

NOTE: Do not over torque the key as it could cause the key to bend or break.

NOTE: Ensure the cylinder face is flush with the ring.

NOTE: D962 Double Cylinder: do not tighten the cylinder retainer screws until both cylinders have been installed.

2.2A Tighten the cylinder in place using the cylinder retainer screw. See **FIGURE 1** in this step.

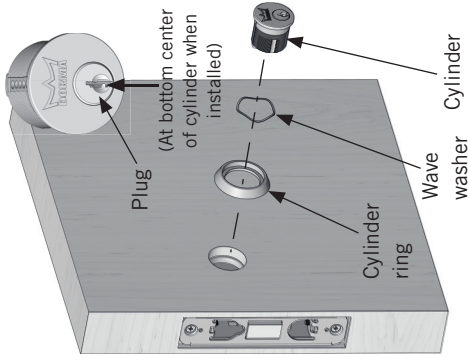

IC mortise housing

2.1B Insert the core into the mortise housing.

2.2B Slide the wave washer and outside cylinder ring over the housing.

NOTE: Do not over torque the key as it could cause the key to bend or break.

NOTE: Ensure the cylinder face is flush with the housing.

NOTE: D962 Double Cylinder: do not tighten the cylinder retaining screws until both cylinders have been installed.

2.3B Tighten the housing in place using the cylinder retainer screw.

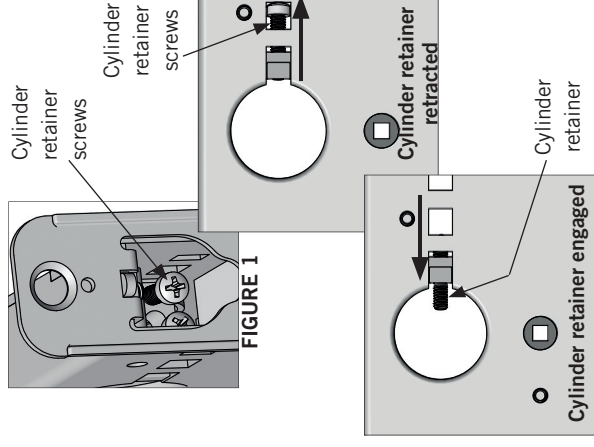
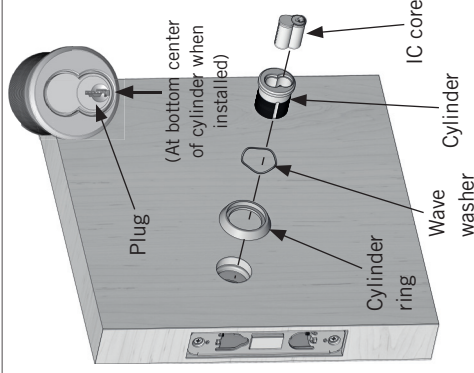

FIGURE 1

2

3. Install standard thumb turn and mortise thumb turn Standard thumb turn cylinder

3.1A Insert the thumb turn spindle through the door face, into the chassis.

3.2A Secure the thumb turn rose to the door with two 6x $\frac{1}{2}$ " Phillips head wood screws or 6-32x $\frac{3}{8}$ " machine screws.

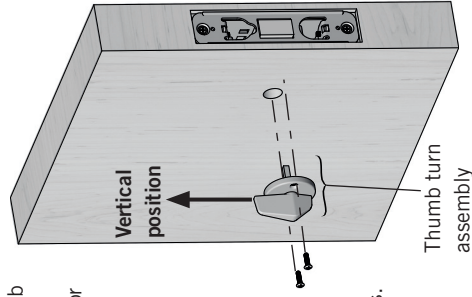

3

4. Install the armor plate

4.1 Place the armor plate against the face of the chassis and secure with two 8-32x $\frac{1}{4}$ " flat head screws.

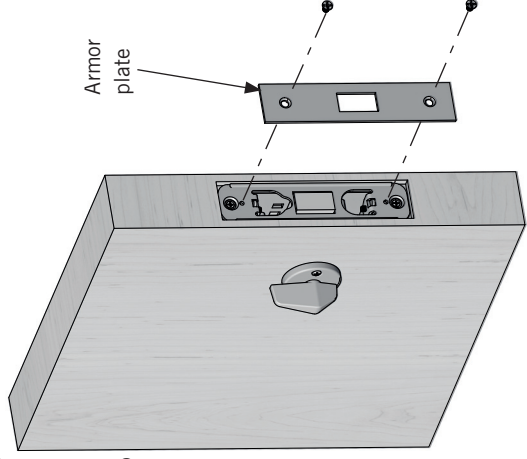

4

5. Install strikes

5.1 Insert reinforcement plate and secure with two 12-24x1" combo screws.

5.2 Insert the strike and secure with two 12-24x1" combo screws.

Strike part list

- 1 - 12-24x1" combo screws
- 2 - Strike plate
- 3 - 12-24x1" combo screws
- 4 - Reinforcement plate

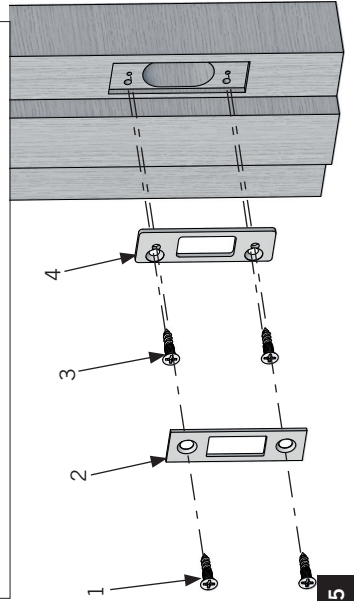

5

I. D971 Cylinder Indicator x Turn

NOTE: Please reference the separate instructions included with the indicator.

