

# CL700 CYLINDRICAL LEVERSET

Installation Instructions



## Overall Exploded View

**Tools required for installation**  
#2 Cross drive screwdriver

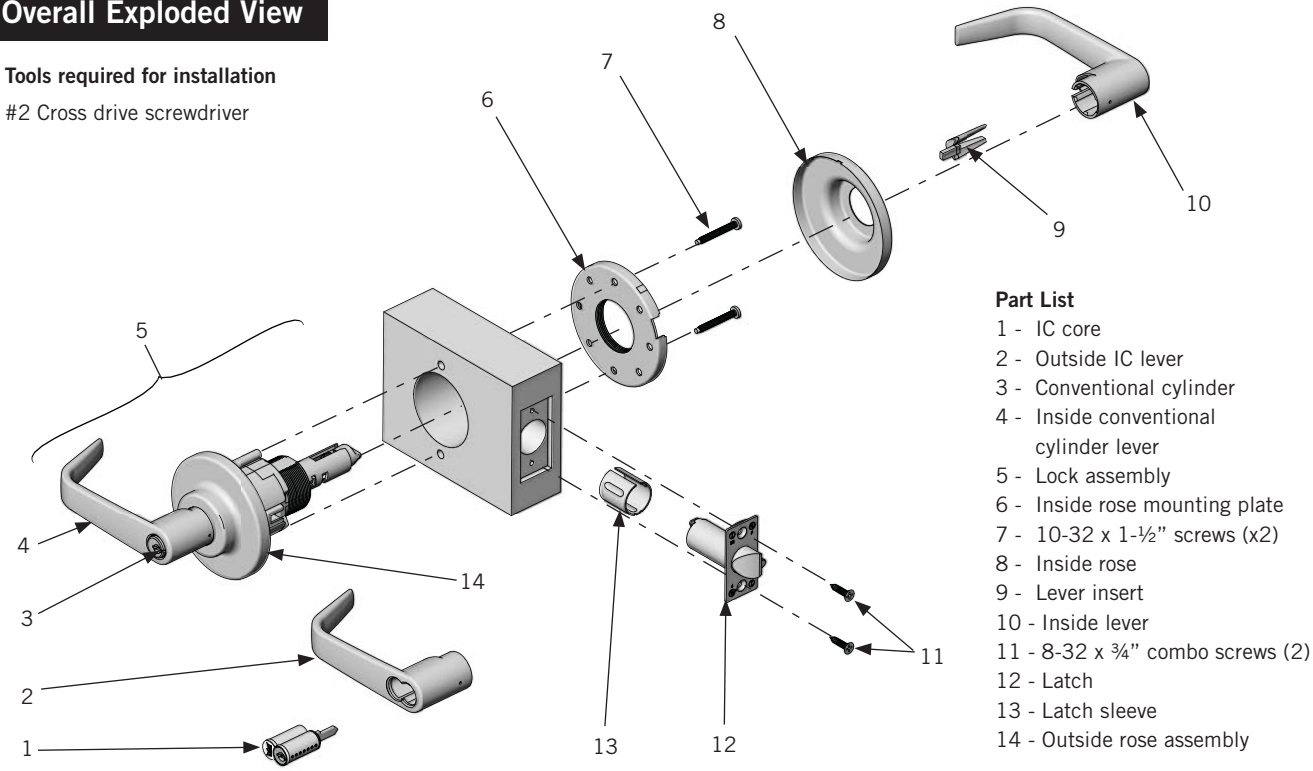

- Part List**
- 1 - IC core
  - 2 - Outside IC lever
  - 3 - Conventional cylinder
  - 4 - Inside conventional cylinder lever
  - 5 - Lock assembly
  - 6 - Inside rose mounting plate
  - 7 - 10-32 x 1-1/2" screws (x2)
  - 8 - Inside rose
  - 9 - Lever insert
  - 10 - Inside lever
  - 11 - 8-32 x 3/4" combo screws (2)
  - 12 - Latch
  - 13 - Latch sleeve
  - 14 - Outside rose assembly

### 1. Install latch

- 1.1** Place the latch into the door edge.  
 ⚠ Orient such that the beveled edge of the latch faces the door jamb.  
**1.2** Secure with two 8-32 x 3/4" combo screws.  
**NOTE:** Latch sleeve to be used for doors with 1-1/8" face plate prep and 1" latch bore.

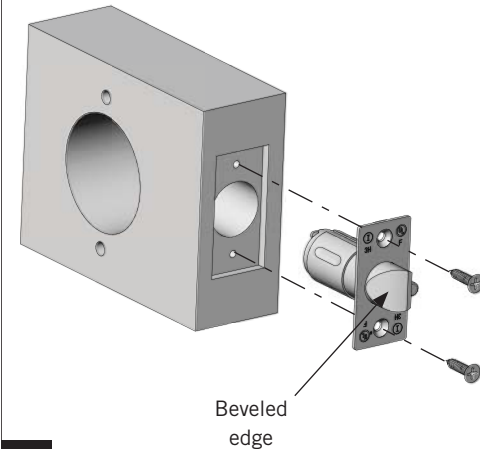

1

### 2. Install lock assembly

**Adjust for door thickness**  
**NOTE:** Lock comes adjusted for 1-3/4" door from the factory.

- 2.1** To adjust the lock assembly for door thickness, align so the center of the chassis is in line with the center of the latch.

- 2.2** Slightly separate the thru-bolt retainer from the outside rose.  
**2.3** Rotate the outside rose assembly to adjust for proper door thickness.  
**2.4** Realign the thru-bolt retainer with the outside rose.

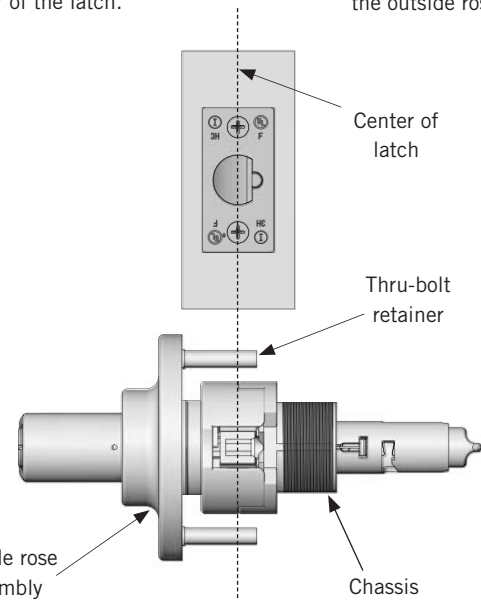

2

### Install chassis

- 2.5** Slide the lock assembly into the face of the door.

⚠ Be sure to engage the inner latch mechanism of the chassis with the back of the latch as shown.

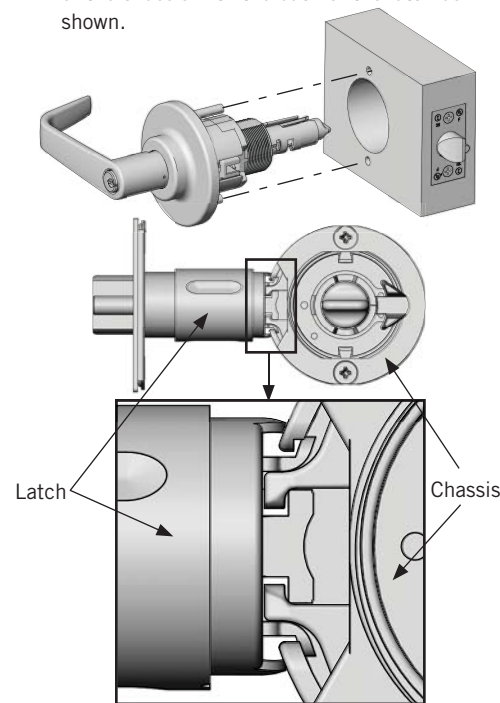

### 3. Install inside rose mounting plate

- 3.1** Hold the lock assembly in place.  
**3.2** Thread the inside rose mounting plate onto the chassis until snug against the door and tighten using the included spanner wrench.

⚠ Be sure holes in plate are aligned with the holes in the door.

- 3.3** Secure the mounting plate using two 10-32 x 1-1/2" screws.

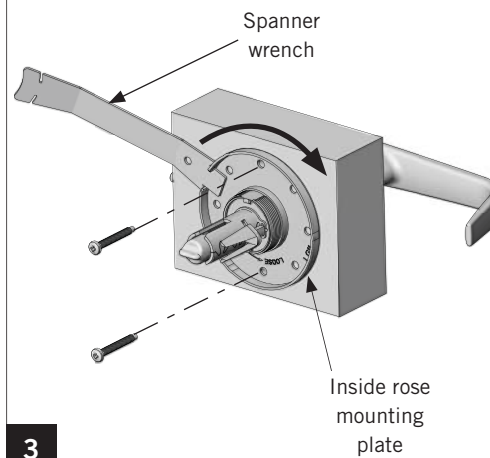

3

### 4. Install rose

- 4.1** Push the inside rose onto the inside rose mounting plate oriented such that the rose notch is facing downward.

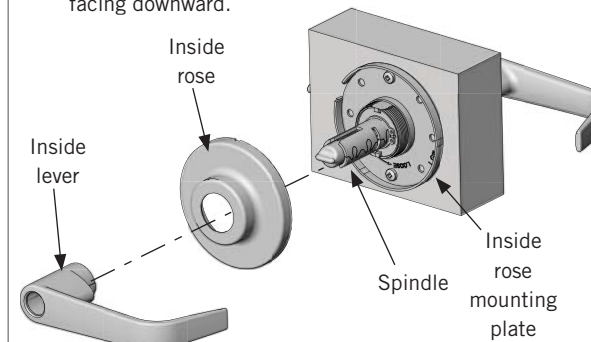

**NOTE:** Be sure the lever insert is inserted into the inside lever prior to installation.

- 4.2** Push the inside lever onto the spindle until it clicks into place.

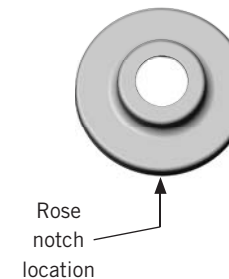

4

### 5. Install strike

- 5.1** Insert strike as shown, and secure with two 12-24 x 1" combo screws.

#### Strike part list

- 1 - Strike plate
- 2 - 12-24 x 1" combo-screws

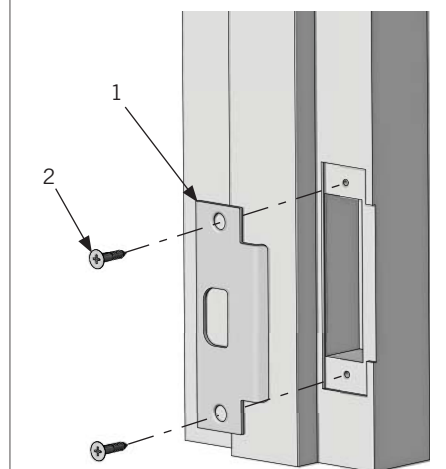

5

### I. C770 - Timing instructions

**TIMING INSTRUCTIONS:** Install lock on door. Remove outside lever and cylinder (for Interchangeable Core locks, leave levers in place and remove cores and tail pieces)

**OUTSIDE OF DOOR:**

Rotate key spindle fully **counter-clockwise**. Install cylinder and lever. (See steps 4 & 5 in section III.)

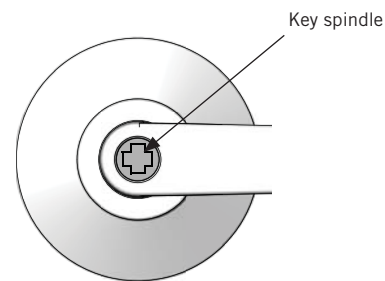

### II. Removing & reassembling interchangeable core lever

**Removal**

1. Insert the control key into the IC core, rotate the key 15° clockwise, and remove the core and tail piece from the lever.
2. Using a flathead screwdriver, retract the lever catch inside the spindle and remove the lever.

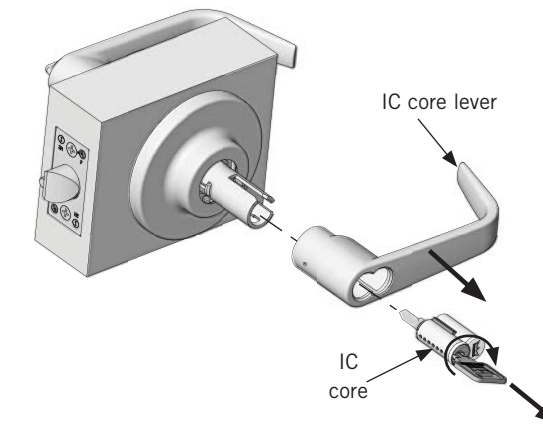

**Reinstallation**

3. Press the lever onto the spindle until it snaps into place.
4. Install the tail piece on the core. Insert the control key into the core, rotate the key 15° clockwise, push the core fully into the lever and turn counter clockwise 15° (home position), and remove the key.

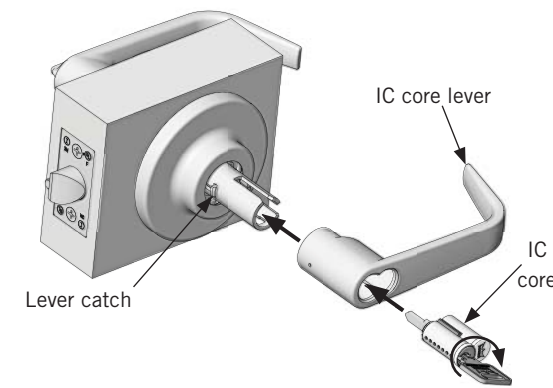

### III. Removing & reassembling standard cylinder lever (cylinder changes)

**Removal**

1. Remove the outside lever by inserting the key, turn clockwise and **hold** at 45°. Using the pick, depress the lever catch through the pick hole and remove the lever. Remove the key. (Figure 1a & 1b)
2. Remove the lever insert and cylinder.

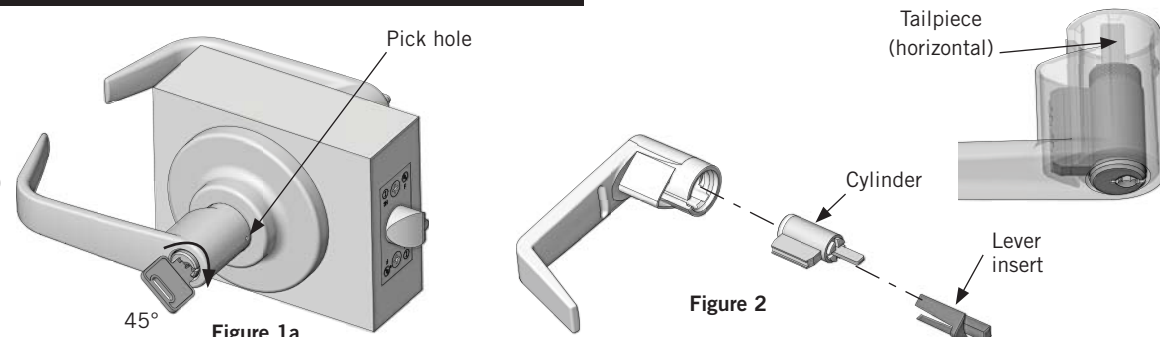

**Reinstallation**

3. Replace with new cylinder and lever insert, and reinstall the lever insert. (Figure 2)

**⚠ Be sure the tailpiece is horizontal.**

4. Press the outside lever onto the spindle until it contacts the lever catch. (Figure 3)

5. Insert the key into the cylinder, turn clockwise and **hold** at 45°. Press the lever fully onto the spindle until it clicks into place. Release the key. (Figure 3)

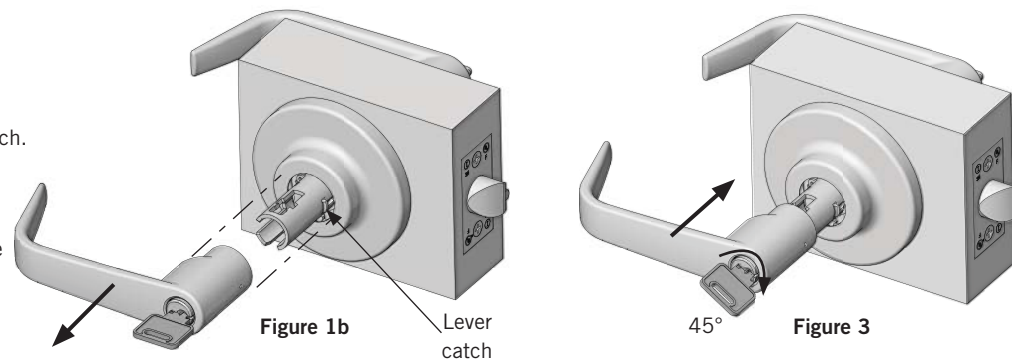

### IV. C701 Dummy trim installation

**Single dummy trim**

1. Using the pick, depress the lever catch through the pick hole and remove the lever.
2. Remove the rose from the dummy mounting plate.
3. Position the dummy mounting plate on the door with the lever catch facing towards the door edge.
4. Secure to the door using four 8-32 x 3/4" combo screws.
5. Push the rose onto the mounting plate oriented with the rose notch facing downward.
6. Push the inside lever onto the spindle until it clicks into place.

