

## TOOLS NEEDED:

Drill



1" drill bit

· 7/32" [5.5]

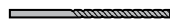

Screwdriver

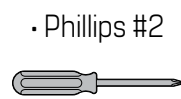

Hole saw

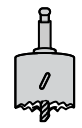

· 1" [25.4]  
· 2-1/8" [54]  
· 2-33/64" [64]

Chisel



Installation tool

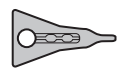

## OVERVIEW

**A** Outside knob

**B** Outside rose

**C** Latch retractor

**D** Cylindrical case

**E** Inside sleeve

**F** Spindle

**G** Push button

**H** Inside mounting plate

**I** (2x) Mounting screws

**J** Inside rose

**K** Inside knob

**L** (2x) Latch screws

**M** Guardbolt

**N** Latchbolt

**O** (2x) Screw holes

**P** Latch face

**Q** Unit latch

**NOTE:** Follow all steps for remodeling or new construction.

**NOTE:** Follow steps 4, 5, 6, 7, 8, 9 and 10 for do-it-yourself replacement after removal of existing lock.

**NOTE:** Illustrations are shown with lock entrance models. Installation of privacy and passage models are identical to lock entrance model.

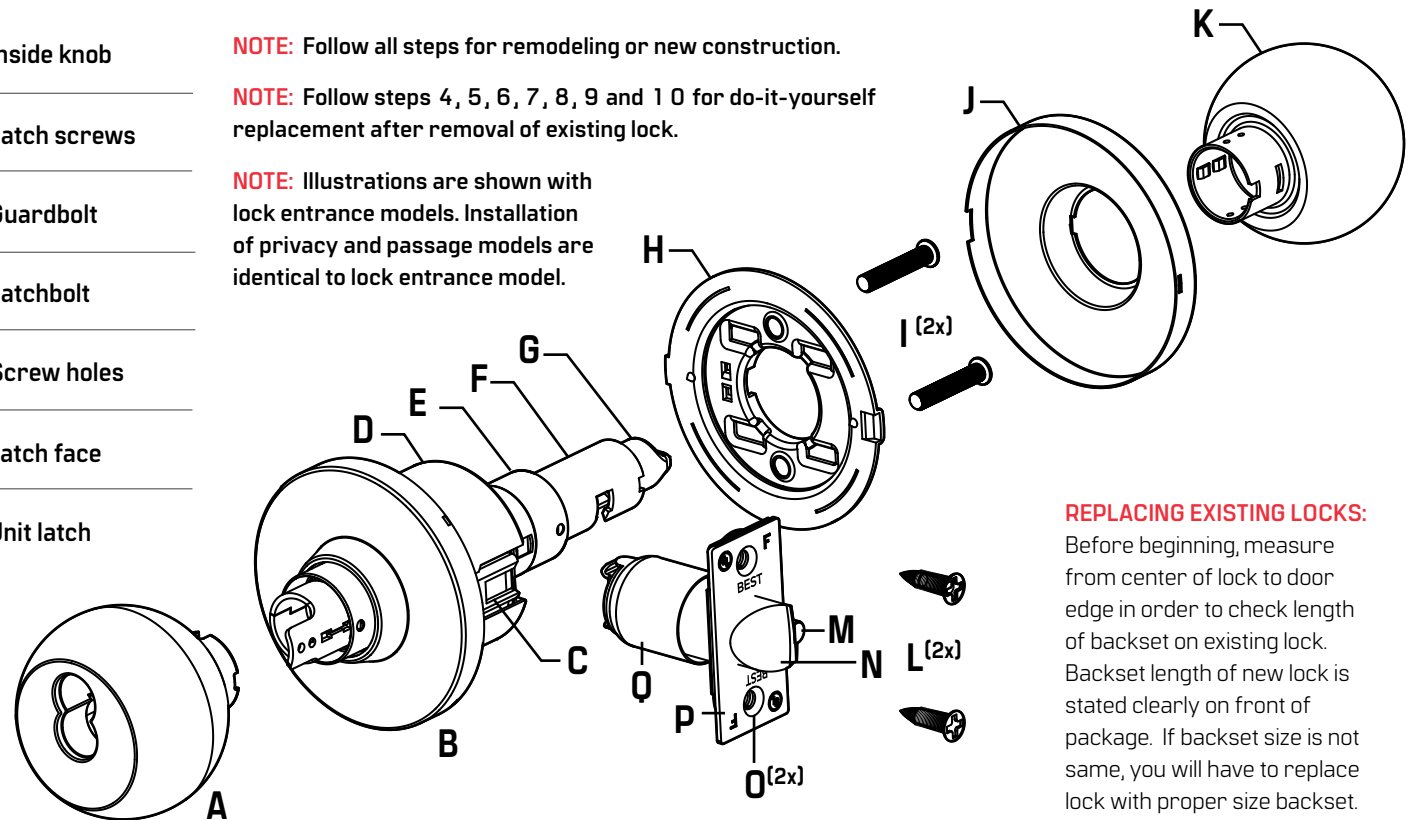

### REPLACING EXISTING LOCKS:

Before beginning, measure from center of lock to door edge in order to check length of backset on existing lock. Backset length of new lock is stated clearly on front of package. If backset size is not same, you will have to replace lock with proper size backset.

## 1 POSITIONING TEMPLATE

**NOTE:** Suggested height from floor to centerline of lock is 40-5/16" [1024]. If steel frames are used, latch centerline must be in line with center of strike preparation.

- 1.1 Remove and fold template and place in position on high edge of door bevel.
- 1.2 Mark drill points for lock and latch.

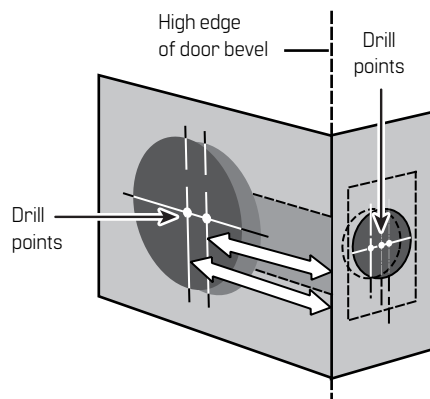

## 2 BORING TWO HOLES AND INSTALLING LATCH

- 2.1 Bore a 2-1/8" [54] diameter hole from both sides of door, to center of door.
- 2.2 Drill a 1" [25.4] diameter hole from edge of door that intersects 2-1/8" [54] hole.
- 2.3 Mortise door edge for latch face.
- 2.4 Install latch and check the door swing. Latch tabs should project into 2-1/8" [54] diameter hole.

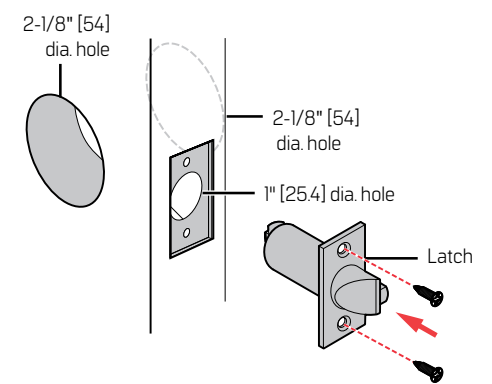

## 3 INSTALLING STRIKE PLATE

**CAUTION:** Deadlocking plunger of latchbolt must not enter strike plate opening. Plunger deadlocks latchbolt and prevents forcing latch when door is closed. A gap of more than 1/8" [3] may reduce security and/or cause improper operation of latchbolt.

- 3.1 Mortise door jamb to fit strike box and strike plate. Make sure to align strike plate and latchbolt centers.
- 3.2 Insert strike box and secure strike plate with screws provided.

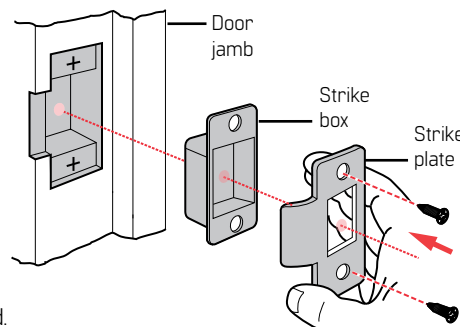

## 4 REMOVING INSIDE TRIM

- 4.1 Use nail end of installation tool provided to depress inside knob keeper in hole of inside sleeve collar and slide knob off of spindle.
- 4.2 Depress spring attached to inside rose. Insert nail end of installation tool into slot to remove inside rose plate.
- 4.3 Remove inside rose and mounting plate.

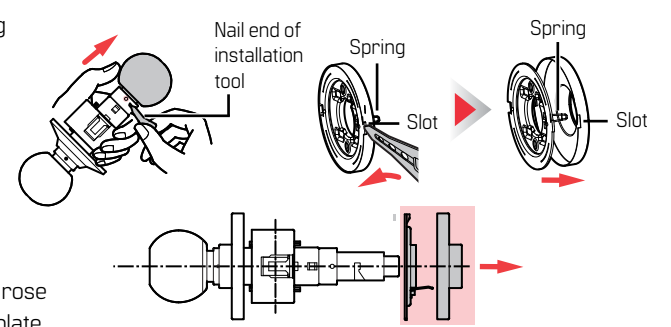

## 5 ADJUSTING OUTSIDE ROSE

- 5.1 Adjust lock to fit door thickness by rotating outside rose. Lock will fit all doors 1-3/8" [35] to 1-3/4" [45] thick.

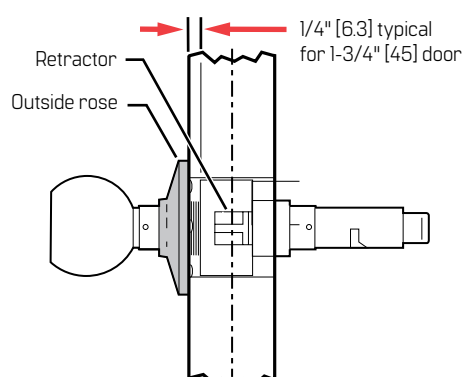

## 6 ENGAGING RETRACTOR IN LATCH

- 6.1 The latch unit must be in place before installing the lock.
- 6.2 Ensure the lock housing engages with the latch tabs and the retractor interlocks with the latch tailpiece.

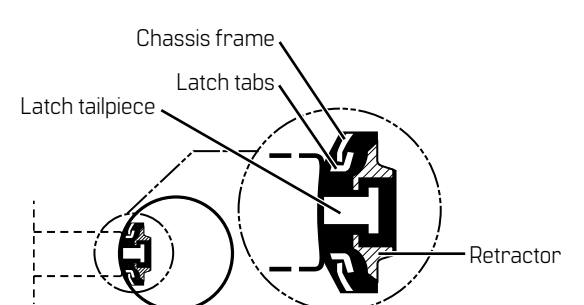

## 7 INSTALLING INSIDE ROSE

**NOTE:** Ensure mounting plate fits horizontally into tabs notched in door.

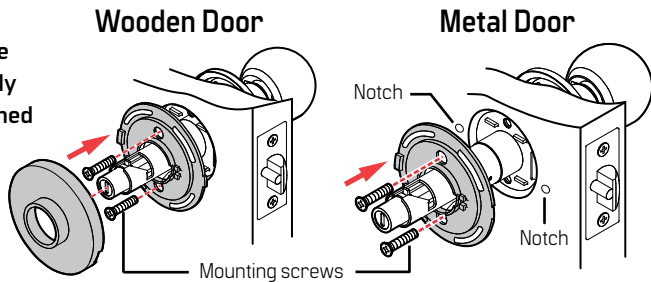

- 7.1 Tighten mounting screws securely to install mounting plate.
- 7.2 Press the rose onto mounting plate.

## 8 INSTALLING INSIDE KNOB

**CAUTION:** Align lug on knob with narrow slot on side of spindle. Push knob all the way in until knob keeper clicks into slot on knob. Otherwise, knob will jamb on shaft.

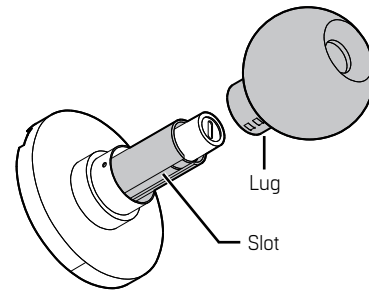

## 9 CHECKING HANDING

- 9.1 Incorrect key hole position.
- 9.2 Remove cylinder using control key.
- 9.3 Turn knob clockwise until knob keeper appears in small slot. Use installation tool to depress knob keeper and pull knob out.

### Wrong key hole position

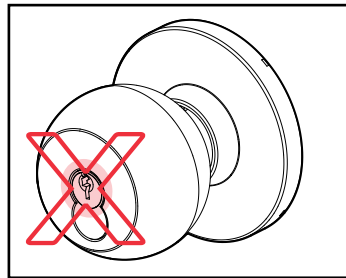

### Remove cylinder

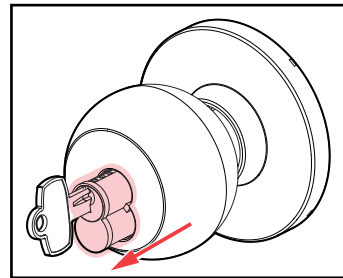

### Pull knob out

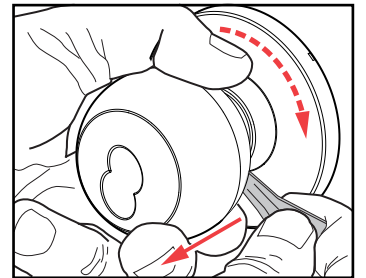

- 9.4 Rotate knob so figure-eight hole is located in upper area of knob. Align slot on side of knob with knob keeper on spindle. Push in firmly until knob keeper clicks into slot on knob.
- 9.5 Install cylinder into knob.
- 9.6 Key hole position is correct.

### Rotate and push knob in

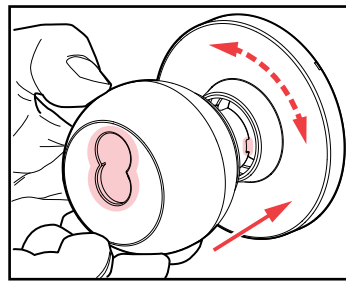

### Install cylinder

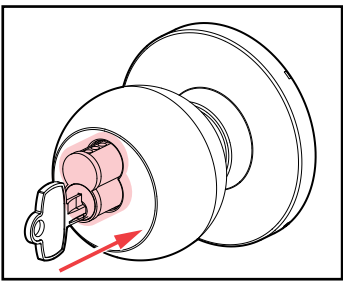

### Correct key hole position

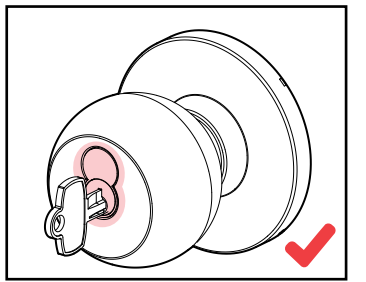

## 10 INSTALLING CORE

### For 'R' function locks only (Timing the lock)

- 1 0.1 Simulating throw member, insert a screwdriver through figure-8 opening to engage throw member slot.
- 1 0.2 Turn locking mechanism clockwise as far as it will go.
- 1 0.3 Rotate counterclockwise approximately 90° and install core.

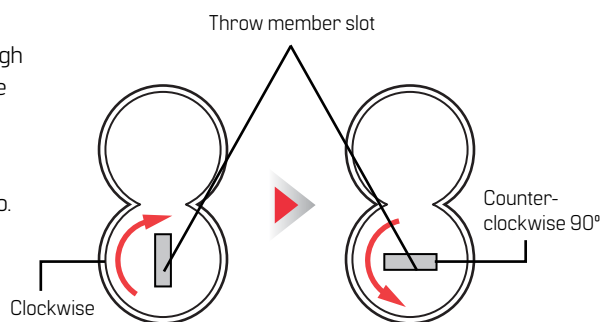

### For all functions (Including 'R')

- 1 0.1 Insert throw member into back of core.
- 1 0.2 Insert control key into core and turn key 15° clockwise.
- 1 0.3 Insert core and throw member into knob with control key.
- 1 0.4 Turn key 15° counterclockwise and remove key.

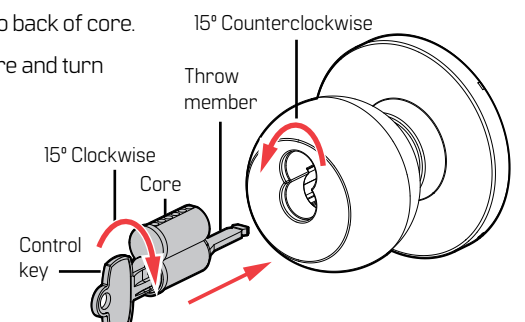

English



Scan for product details and downloads.

Call 1-800-392-5209 or visit <https://dhwsupport.dormakaba.com/hc/en-us> for assistance and warranty information.

**Warning:** This Manufacturer advises that no lock can provide complete security by itself. This lock may be defeated by forcible or technical means, or evaded by entry elsewhere on the property. No lock can substitute for caution, awareness of your environment, and common sense. Builder's hardware is available in multiple performance grades to suit the application. In order to enhance security and reduce risk, you should consult a qualified locksmith or other security professional.

Español



Escanee para acceder a información del producto y descargas.

Llame al 1-800-392-5209 o visite <https://dhwsupport.dormakaba.com/hc/en-us> para obtener asistencia e información sobre garantía.

**Advertencia:** Este fabricante debe saber que no hay cerraduras que puedan proporcionar seguridad completa por sí mismas. Esta cerradura puede fallar forzándola o utilizando medios técnicos o entrando por otra parte del edificio. No hay cerraduras que puedan sustituir precaución, estar al tanto de su entorno y sentido común. Este fabricante también ofrece cerraduras de diferentes grados y rendimientos para ajustarse a su aplicación. Para mejorar la seguridad y reducir riesgos, usted debe consultar con un cerrajero especializado u otro profesional de seguridad.

Français



Scanner pour obtenir des détails sur les produits et des téléchargements.

Appelez le 1-800-392-5209 ou rendez-vous sur le site <https://dhwsupport.dormakaba.com/hc/fr-ca> pour obtenir de l'aide et des renseignements sur la garantie.

**Advertissement:** Le fabricant tient à vous aviser qu'aucun verrou ne peut à lui seul offrir une sécurité complète. Ce verrou peut être mis hors d'état par la force ou des moyens techniques ou être évité par l'utilisation d'une autre entrée sur la propriété. Aucun verrou ne peut remplacer la surveillance de votre environnement et le bon sens. La quincaillerie pour le constructeur est offerte selon différents grades de performance pour différentes applications. Afin d'augmenter la sécurité et de réduire le risque, vous devriez consulter un serrurier qualifié ou un autre professionnel de la sécurité.