

Wi-Q Adapter Installation Instructions

1 REMOVING COVER.

- 1.1 Remove cover screws from either side of top cover and set aside.
- 1.2 Press top cover against door lightly and slide up to remove from fire plate.

CAUTION:
To avoid scratching door, use light pressure when pressing top cover into door.

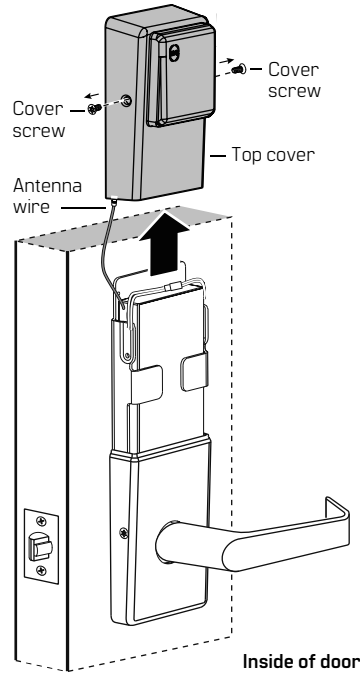

2 DISCONNECTING WIRES.

- 2.1 Disconnect gray antenna wire connector from black antenna wire connector.

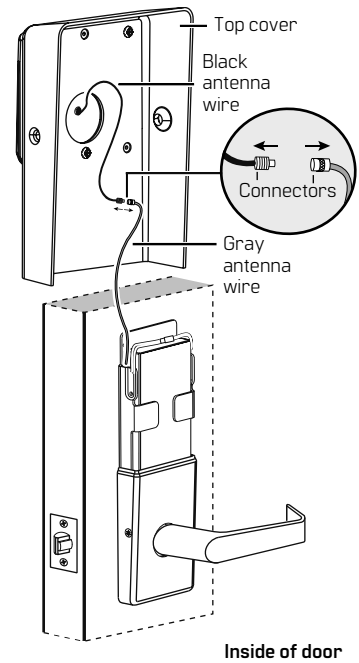

3 RECONNECTING WIRES.

- 3.1 Insert gray antenna wire connector into new adapter (as shown). Repeat with black antenna wire connector.

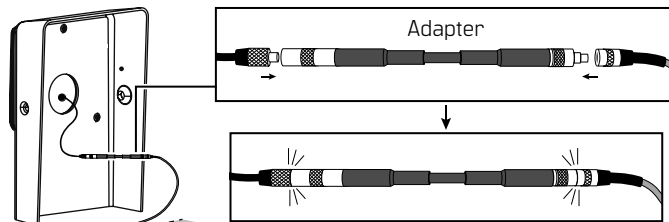

NOTE: Adapter can only be connected in one orientation.

NOTE: Press firmly when securing connector to adapter. Connector will click in place once secure.

CAUTION:
Ensure there are no loose wire connections where connectors are inserted in adapter.

CAUTION:
Ensure connectors are firmly mated to adapter.

4 SECURING COVER.

- 4.1 Place top cover against door, above fire plate. Slide top cover down toward bottom cover.

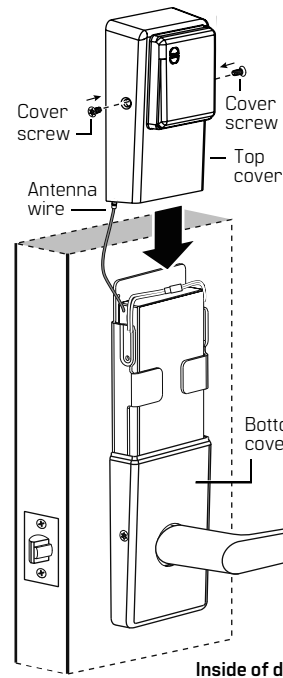

CAUTION:
Feed antenna wire down into bottom cover as top cover slides down onto fire plate. Be sure not to pinch wire on bottom cover.

CAUTION:
To avoid scratching door, use light pressure when sliding top cover down against door.

- 4.2 Secure top cover using cover screws from step 1.1.