

# 45H/47H Installation Instructions

Spanish and French translations, are available at <https://dhwsupport.dormakaba.com/hc/en-us/articles/>

**Tools Needed:**

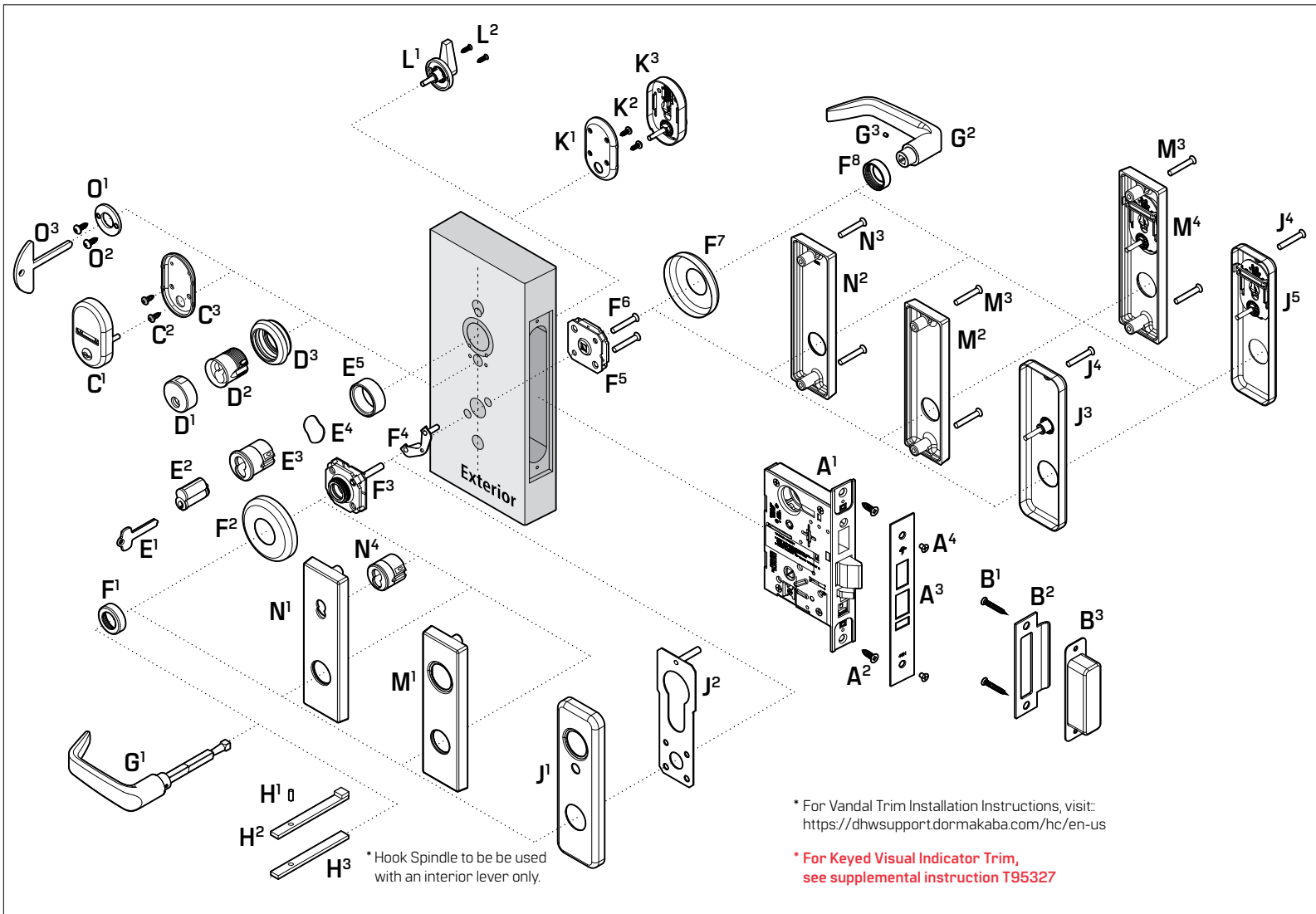
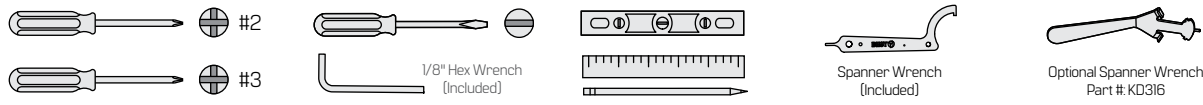

Function	Type
A	Office Lock
AB	Office Lock
AT	Office Lock
B	Entrance Lock
BA	Entrance Lock
BW	Entrance or Storeroom Lock
D	Storeroom Lock
H	Hotel Lock Indicator
HJ	Hotel Lock
R	Classroom Lock
RHB	Classroom Holdback Lock
T	Dormitory Lock
TA	Dormitory Lock
TD	Dormitory Lock
C	Public Entrance Lock
CHB	Holdback Lock
G	Communicating Lock
INA	Intruder Lock
IND	Intruder Lock
INL	Intruder Lock
S	Storeroom Lock
SV	Security Vestibule
W	Storeroom Lock
AD	Deadlock Lock
RD	Classroom Deadlock
WD	Deadlock
YD	Deadlock
L	Privacy Lock
LB	Privacy Lock
LT	Privacy Lock
N	Passage Lock
NX	Exit Lock
IDT	Single Dummy Lock
2DT	Double Dummy Lock
B5	Entrance Lock
B7	Entrance Lock
XR	Classroom Lock-less exterior lever
ZD	Storeroom Lock-less interior lever
DEL	Electronically Locked-Fail Safe Lock
DEU	Electrically Unlocked-Fail Secure Lock
LEL	Electronically Locked-Fail Safe Lock
LEU	Electrically Unlocked-Fail Secure Lock
NXEL	Electronically Locked-Fail Safe Lock
NXEU	Electrically Unlocked-Fail Secure Lock
TDEL	Electronically Locked-Fail Safe Lock
TDEU	Electrically Unlocked-Fail Secure Lock
TWEL	Electronically Locked-Fail Safe Lock
TWEU	Electrically Unlocked-Fail Secure Lock
WEL	Electronically Locked-Fail Safe Lock
WEU	Electrically Unlocked-Fail Secure Lock

Part	Description	Part	Description	Part	Description	Part	Description
A <sup>1</sup>	Mortise Lock	E <sup>2</sup>	Cone	G <sup>3</sup>	Interior Lever Set Screw	M <sup>1</sup>	Exterior M Trim
A <sup>2</sup>	Mortise Lock Screw	E <sup>3</sup>	Standard Cylinder	H <sup>1</sup>	Pin	M <sup>2</sup>	Interior M Trim
A <sup>3</sup>	Faceplate	E <sup>4</sup>	Cylinder Washer	H <sup>2</sup>	Upper Hook Spindle	M <sup>3</sup>	M Trim Mounting Screw
A <sup>4</sup>	Faceplate Screw	E <sup>5</sup>	Cylinder Ring	H <sup>3</sup>	Lower Hook Spindle	M <sup>4</sup>	Interior M Trim - Visual Indicator Thumb Turn
B <sup>1</sup>	Strike Screw	F <sup>1</sup>	Trim Ring	J <sup>1</sup>	Exterior J Trim	N <sup>1</sup>	Exterior N Trim
B <sup>2</sup>	Strike	F <sup>2</sup>	Rose	J <sup>2</sup>	Alignment Plate	N <sup>2</sup>	Interior N Trim
B <sup>3</sup>	Strike Box	F <sup>3</sup>	Trim Cassette	J <sup>3</sup>	Interior J Trim	N <sup>3</sup>	N Trim Mounting Screw
C <sup>1</sup>	Visual Indicator Faceplate Assembly	F <sup>4</sup>	Trim Plate (Optional)	J <sup>4</sup>	J Trim Mounting Screw	N <sup>4</sup>	Exterior N Trim Cylinder
C <sup>2</sup>	Visual Indicator Mounting Bracket Screw	F <sup>5</sup>	Interior Trim Cassette	J <sup>5</sup>	Interior J Trim - Visual Indicator Thumb Turn	O <sup>1</sup>	Emergency Access Rose
C <sup>3</sup>	Visual Indicator Mounting Bracket	F <sup>6</sup>	Trim Cassette Screw	K <sup>1</sup>	VIT Mounting Bracket	O <sup>2</sup>	Rose Screw
D <sup>1</sup>	High Security Cylinder Face	F <sup>7</sup>	Interior Rose	K <sup>2</sup>	VIT Screw	O <sup>3</sup>	Emergency Access Key
D <sup>2</sup>	High Security Cylinder	F <sup>8</sup>	Interior Trim Ring	K <sup>3</sup>	VIT Assembly		
D <sup>3</sup>	High Security Cylinder Ring	G <sup>1</sup>	Exterior Lever	L <sup>1</sup>	Thumb Turn		
E <sup>1</sup>	Control Key	G <sup>2</sup>	Interior Lever	L <sup>2</sup>	Thumb Turn Screw		

**1** **UNR Functions Only**

Rotate the shuttle to the position according to your function and insert a stop screw.

Functions	Install Shuttle Screw Positions	Remove Shuttle Screw Positions
A	0, 2, 4	1, 3, 5, 6
AT,R	0, 5, 6	1,2,3,4
D,NX	3, 5, 6	0,1,2,4
N	1, 5, 6	0,2,3,4

**2** Determine Door Handing and change latch bolt handing if it does not match door handing.

**3** Position Hub Toggles (if necessary)

Make sure that the Mortise is locked before adjusting the Hub Toggles.

**Up** **Middle**

**Locked** **Unlocked**

Setting the hub toggles incorrectly can trap people in the room.

Function	Type	Function	Type	Function	Type
A, AB, AT, BA, C, CHB, D, H, HJ, IND, INL, L, LT, NX, R, RHB, S, T, TA, TD, X, XR, ZD	Exterior: Up (locked) Interior: Middle (always unlocked)	B, BW, B5, B7, G, LB, W	Both Up		Both Middle

**4**

**i** Install both Trim Cassettes for all trim **except for J Trim and One-Sided Trim.**

**F<sup>3</sup>** Exterior

**F<sup>5</sup>** **F<sup>6</sup>**

**Do not overtighten.**

**i** **J Trim Only.** For one-sided J Trim, do not install J<sup>2</sup>.

**F<sup>3</sup>** **F<sup>5</sup>** **F<sup>6</sup>**

**Do not overtighten.**

**i** If using the **Optional Trim Plate**, install before inserting case body in door.

**Optional Trim Plate** **F<sup>4</sup>** **A<sup>1</sup>** **A<sup>2</sup>**

**F<sup>5</sup>** **F<sup>6</sup>**

**#8x1" PFH Surface Mounting Screws**

**Do not overtighten.**

**NOTE: For 45H Security Vestibule Function, see supplemental instruction T95328.**

**5**

**Sectional Trim**      **J Trim**      **M Trim**      **N Trim**

**E<sup>3</sup>** **E<sup>4</sup>** **E<sup>5</sup>**

**Cam must be in 12 o'clock position.**

**Do not tighten escutcheon screws until cylinder is threaded and secure.**

**Note: If VIN needs to be reassembled, please refer to this diagram.**

**J<sup>1</sup>** **J<sup>3</sup>** **F<sup>8</sup>** **J<sup>4</sup>**

**Do not tighten escutcheon screws until cylinder is threaded and secure.**

**M<sup>1</sup>** **M<sup>2</sup>** **M<sup>3</sup>** **F<sup>8</sup>**

**Do not tighten escutcheon screws until cylinder is threaded and secure.**

**Do not tighten escutcheon screws until cylinder is threaded and secure.**

**F<sup>1</sup>** **F<sup>2</sup>** **F<sup>7</sup>** **F<sup>8</sup>**

**Ensure F<sup>2</sup> & F<sup>7</sup> is centered beneath F<sup>1</sup> & F<sup>8</sup>.**

**F<sup>3</sup>** **E<sup>3</sup>** **E<sup>4</sup>**

**Cam must be in 12 o'clock position.**

**Tighten once cylinder is in place.**

**E<sup>3</sup>** **F<sup>4</sup>** **F<sup>5</sup>**

**Cam must be in 12 o'clock position.**

**Tighten once cylinder is in place.**

**F<sup>1</sup>** **N<sup>2</sup>** **N<sup>3</sup>** **N<sup>4</sup>** **F<sup>8</sup>**

**Do not tighten escutcheon screws until cylinder is threaded and secure.**

**6**

**G<sup>1</sup>** Exterior

**G<sup>2</sup>**

**Interior**

**One-Sided Lever Only.**

**Door**

**H<sup>2</sup>** **H<sup>3</sup>**

**NOTE: If the Optional Trim Plate is installed, please refer to Step 4: (One-sided Trim Only).**

**H<sup>1</sup>**

**The hook spindle can be installed on either side of the door, but only the interior lever can be used.**

**7**

**i** **Emergency Access Key Only.**

**O<sup>1</sup>** **O<sup>2</sup>** **O<sup>3</sup>** Exterior

**i** **Thumb Turn Only.**

**L<sup>1</sup>** **L<sup>2</sup>** Interior

**Do not bind spindle. Mortise and Turn Dial must be unlocked.**

**i** **Visual Indicator Trim Only.**

**VIN indicator must be unlocked.**

**C<sup>1</sup>** **C<sup>2</sup>** **C<sup>3</sup>** Exterior

**i** **Visual Indicator Thumb Turn Only.**

**K<sup>1</sup>** **K<sup>2</sup>** **K<sup>3</sup>** Interior

**Mortise and Turn Dial must be unlocked.**

**i** **Visual Indicator Thumb Turn Trim Only.**

**J<sup>5</sup>** **J<sup>4</sup>**

**8**

**Sectional trim is displayed. However, all functions that require a core can utilize the following steps.**

**E<sup>1</sup>** **E<sup>2</sup>**

**Cam must be in 12 o'clock position.**

**9**

**i** **High Security Cylinder Only.**

**D<sup>1</sup>** **E<sup>2</sup>**

**Cam must be in 12 o'clock position.**

**D<sup>2</sup>** **D<sup>3</sup>**

**10**

**A<sup>3</sup>** **A<sup>4</sup>**

**Most locks ship with only one faceplate. The UNAB and UNR locks ship with two faceplates. For AB (UNAB) and A (UNR) function locks, use the faceplate that exposes the locking toggle.**

**B<sup>1</sup>** **B<sup>2</sup>** **B<sup>3</sup>**

**Check Operation:**

- Door latches and opens properly.
- Deadbolt operates properly.
- Visual indicator and visual indicator thumb turn operates properly.
- Thumb turn operates properly.
- Key access works.
- Door gap is 1/8" [3.175 mm].
- Auxiliary bolt is held inside the case when the door is closed.



Scan for product details and downloads.  
Call 1-800-392-5209 or visit  
<https://dhwsupport.dormakaba.com/hc/en-us> for assistance or warranty information.

**Warning:** This Manufacturer advises that no lock can provide complete security by itself. This lock may be defeated by forcible or technical means, or evaded by entry elsewhere on the property. No lock can substitute for caution, awareness of your environment, and common sense. Builder's hardware is available in multiple performance grades to suit the application. In order to enhance security and reduce risk, you should consult a qualified locksmith or other security professional.