

Wiring diagram

The diagram below shows how to wire 8KW and 9KW electrified locks.

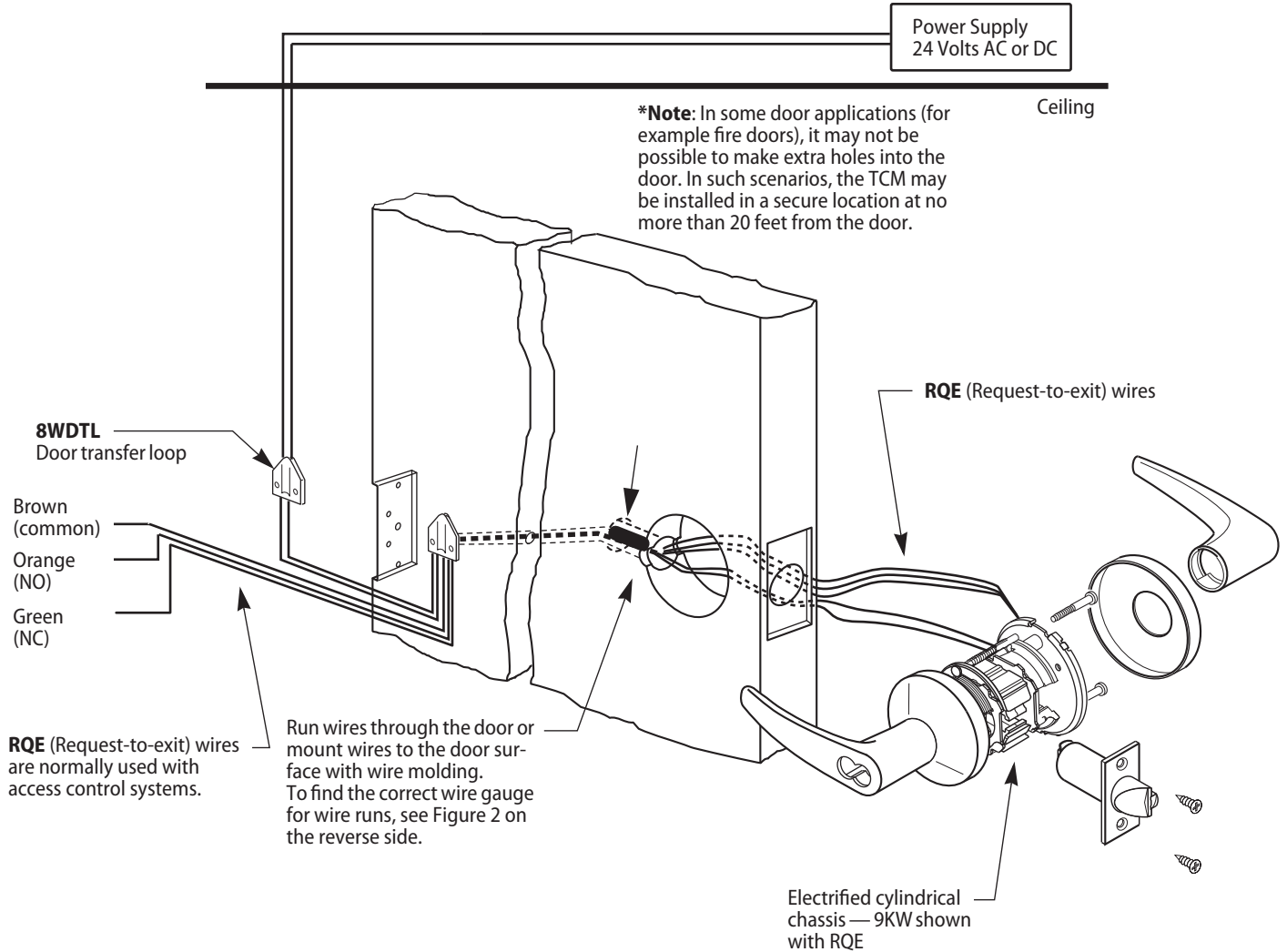

Figure 1—Wiring diagram for 8KW and 9KW electrified locks (9KW with RQE shown)

Electrical requirements

The following table describes the voltage and current specifications for the 8KW and 9KW locks, with RQE (REX) switch, and door monitoring switch.

Unit	Voltage	Current
8KW (RQE not available)	24 volts AC or DC	0.18 amp continuous duty
9KW with and without RQE	24 volts AC or DC	0.18 amp continuous duty
RQE switch	30 volts AC or DC maximum	0.7 amp inductive 0.7 amp resistive

Minimum gauge wire chart for lock circuits

The chart in Figure 2 helps you find the minimum wire gauge needed for a specific length wire run. It assumes that the lock circuit is made of two conductor cable. The chart also factors in a 15% voltage loss at 24 volts.

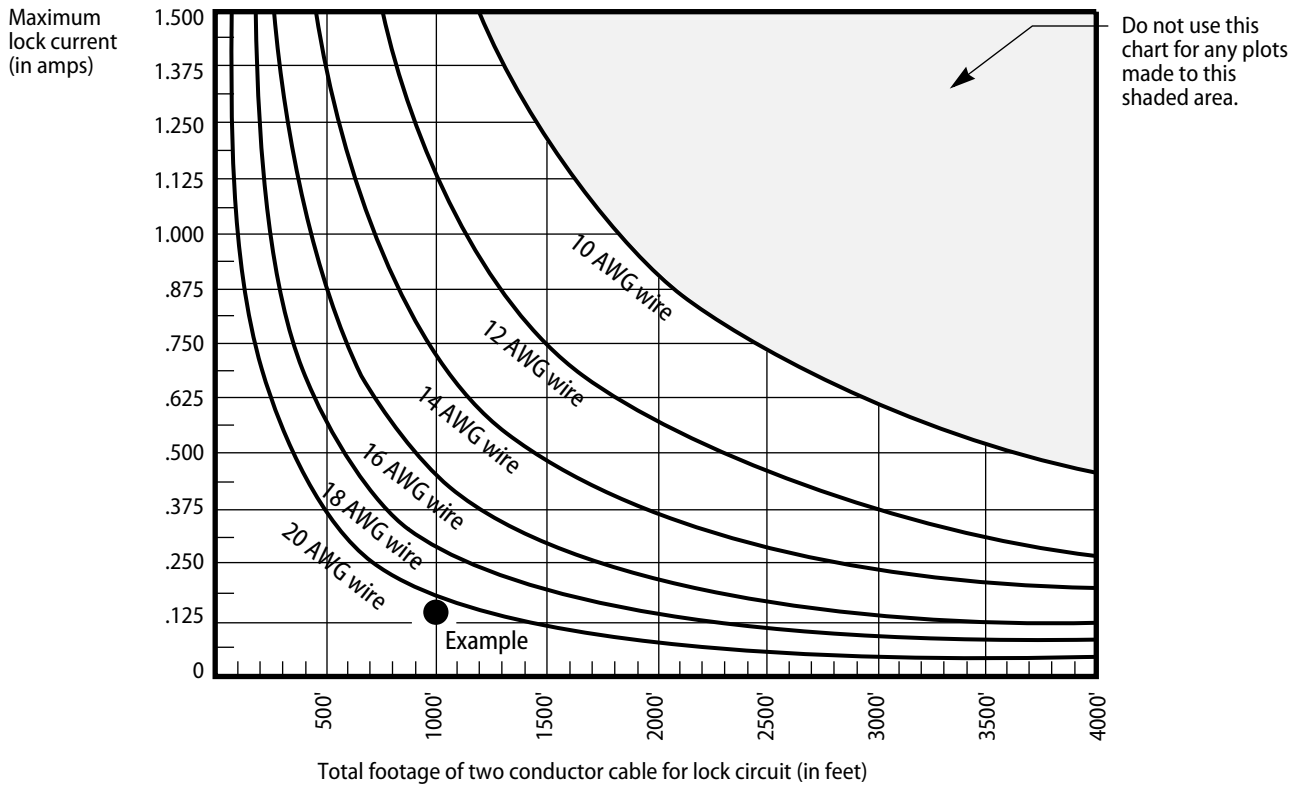

Figure 2—Minimum gauge wire chart for lock circuits

To find the correct gauge wire

- 1 Determine the maximum lock current and find that value on the left side of the chart.
- 2 Determine the total footage of cable to be used in the lock circuit and find that value at the bottom of the chart.
- 3 Locate the intersection of current and footage. The line above or to the right of the intersection shows what minimum gauge wire you need.

Example

▲ Lock current: 0.18 amp maximum

▲ Total wire run: 1000 feet

Wire gauge needed: 20 AWG two conductor cable

Note: For 12 volt locks, double the maximum lock current, then use that value on the left side of the chart.

Installation hints

- 1 Wire gauge (or size) determines how efficiently the lock will operate. Consider wire gauge before installation. To find the recommended minimum wire gauge for all wire runs, see Figure 2.
- 2 Use wire of 20 AWG (gauge) or larger. We do not recommend using a smaller wire gauge than 20 AWG.
- 3 When wiring two or more locks to a single power supply, make sure that the power rating of the power supply is 1 1/2 times greater than the sum of the lock's power requirement.

Example

For two locks powered by one supply:

▲ Lock 1 (9KW) is rated at 24 volts, 0.18 amps—24 volts × 0.18 amps = 4.32 volt-amps

▲ Lock 2 (45HW) is rated at 24 volts, 0.75 amps—24 volts × 0.75 amps = 18 volt-amps

Choose a transformer with a rating of at least: (4.32 volt-amps + 18 volt-amps) × 1 1/2 = **33.48 volt-amps**



For assistance or warranty information:
Call 1-800-392-6209 or visit
<https://dhwsupport.dormakaba.com/hc/en-us>



Si desea ayuda o información sobre la garantía:
llame al 1-800-392-6209 o visite
<https://dhwsupport.dormakaba.com/hc/en-us>



Pour de l'aide ou des informations sur la garantie:
Veuillez appeler le 1-800-392-6209 ou visiter
<https://dhwsupport.dormakaba.com/hc/en-us>

Warning: This Manufacturer advises that no lock can provide complete security by itself. This lock may be defeated by force or technical means, or evaded by entry elsewhere on the property. No lock can substitute for caution, awareness of your environment, and common sense. Builder's hardware is available in multiple performance grades to suit the application. In order to enhance security and reduce risk, you should consult a qualified locksmith or other security professional.

Advertencia: Este fabricante hace saber que no hay cerraduras que puedan proporcionar seguridad completa por sí mismas. Esta cerradura puede fallar forzándola o utilizando medios técnicos o entrando por otra parte del edificio. No hay cerraduras que puedan sustituir precaución, estar al tanto de su entorno y sentido común. Este fabricante también ofrece cerraduras de diferentes grados y rendimientos para ajustarse a su aplicación. Para mejorar la seguridad y reducir riesgos, usted debe consultar con un cerrajero especializado u otro profesional de seguridad.

Advertissement: Le fabricant tient à vous aviser qu'aucun verrou ne peut à lui seul offrir une sécurité complète. Ce verrou peut être mis hors d'état par la force ou des moyens techniques ou être évité par l'utilisation d'une autre entrée sur la propriété. Aucun verrou ne peut remplacer la surveillance de votre environnement et le bon sens. La qualification pour le constructeur est offerte selon différents grades de performance pour différentes applications. Afin d'augmenter la sécurité et de réduire le risque, vous devez consulter un serrurier qualifié ou un autre professionnel de la sécurité.