

## Preparing the door

### For factory prepared doors only

- 1 Install the latch so that the bevel on the latchbolt faces the strike lip.
- 2 Adjust the outside rose so that the chassis is centered in the door. Install the chassis from the outside of the door.
- 3 Install the inside rose, rose ring, knob, and strike plate.

**Caution:** If you use fabricated hollow metal doors, determine whether the doors are reinforced enough to support the lock. If the door reinforcement is not adequate, consult the door manufacturer for information on proper reinforcement.

**Note:** For detailed installation instructions, see the following steps.

### 1 Position template

- 1 Fold the template and place it in position on the high edge of the door bevel. (See Figure 2.)
- 2 Mark the drill points.

**Note:** Suggested height from floor to centerline of the lock is 40 5/16". If steel frames are used, the latch centerline must be in line with the center of the strike preparation.

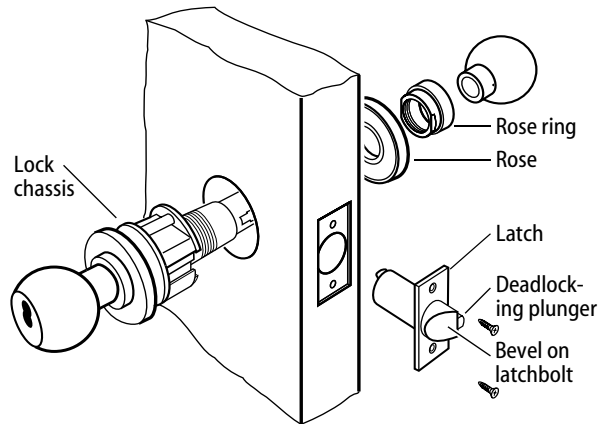

Figure 1 Overview diagram

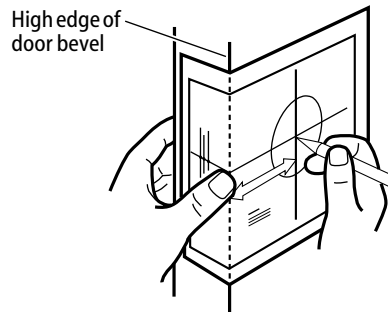

Figure 2 Marking the drill points

## Preparing the lock

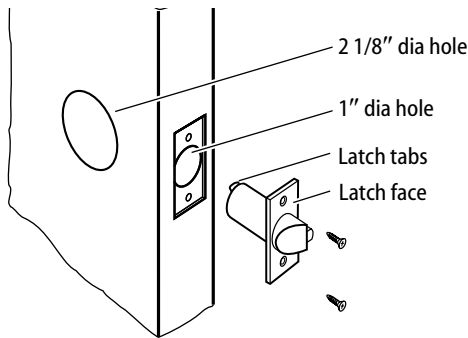

Figure 3 Boring holes and installing the latch

### 2 Bore holes and install latch

- 1 Bore a 2 1/8" diameter hole from both sides of the door to the center of the door. (See Figure 3.)
- 2 Drill a 1" diameter hole from the edge of the door that intersects the 2 1/8" hole.
- 3 Mortise the door edge for the latch face.
- 4 Install the latch and check the door swing. Latch tabs should project into the 2 1/8" diameter hole. See Task 5, *Install chassis*.

### 3 Remove inside knob and trim

#### For inside knobs with button or blank face:

- 1 Insert the spanner wrench tip into the knob keeper hole and depress the keeper. (See Figure 4.)
- 2 Slide the knob off.
- 3 Unthread the rose ring and remove the rose.

#### For keyed inside knobs:

- 1 Remove the core and throw member (if not already removed). For instructions on removing the core, see Task 9, *Install core*.
- 2 Insert a screwdriver into the figure-8 core hole and into the keeper. (See Figure 4, top.)
- 3 Using the edge of the screwdriver, press down on the keeper and slide the keyed knob off of the sleeve.

**Caution:** You will not be able to remove the knob if you put the screwdriver blade too far past the keeper.

### 4 Center lock in door

Check to see if the lock retractor is centered in the door.

- If centered, proceed to Task 5, *Install core*.
- If not centered, use the door as a reference and center the retractor in the door. Do this by pulling the rose locking pin and rotating the outside rose in or out. (See Figure 5.)

**Caution:** Center the retractor before proceeding to Step 5, *Install chassis*.

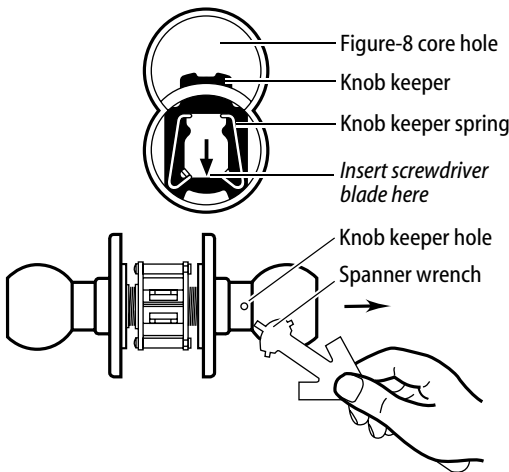

Figure 4 Removing inside knob and trim

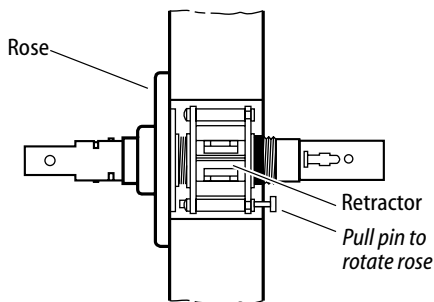

Figure 5 Marking the centerlines

## Installing the lock

**Note 1:** Make sure the locking pin locks back into the rose liner.

**Note 2:** Locks with standard trim will fit doors 1 3/8" to 2 1/8" thick. Locks with 'E' trim will fit doors 2 1/4" to 3" thick.

### 5 Install chassis

- After the retractor has been centered, and with the latch in place, install the chassis from the outside of the door. Make sure the latch tabs fit into the chassis frame and the latch tailpiece fits into the retractor. (See Figure 6.)

### 6 Install inside rose and knob

**Note:** For lead lined locksets, slide the lead shield (not shown) over the sleeve and into the 2 1/8" hole.

- Slide the rose over the sleeve, then thread the rose ring onto the threaded hub and tighten snugly with the spanner wrench.

#### For non-keyed inside knobs:

- Align the knob keeper hole with the knob keeper in the sleeve as shown in Figure 7. Firmly push the knob on until seated.

#### For keyed inside knobs:

- Align either of the knob driver slots with the knob driver in the sleeve as shown in Figure 8. Firmly push the knob on until seated.

### 7 Install strike plate

- Mortise the door jamb to fit the strike box and strike plate. Make sure to align the strike plate and latchbolt centers.

**Caution:** The deadlocking plunger of the latchbolt must not enter the strike plate. The plunger deadlocks the latchbolt and prevents forcing the latch when the door is closed. Excessive gap may reduce security and/or cause malfunction of the latchbolt assembly. A maximum door gap of 1/8" is recommended.

- Insert the strike box and secure the strike plate with the screws provided.

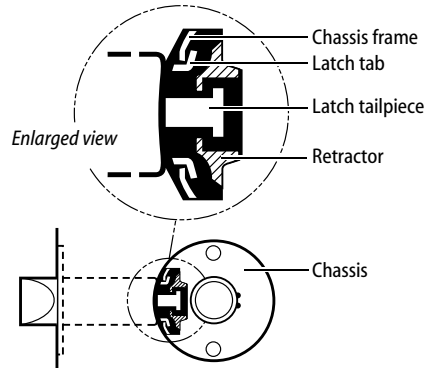

Figure 6 Installing the chassis

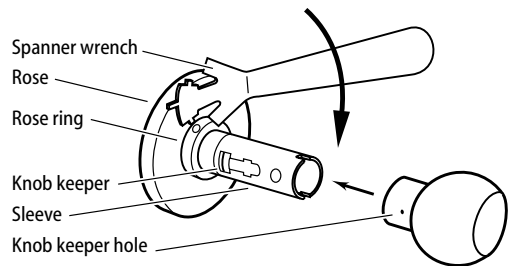

Figure 7 Installing the inside knob and rose

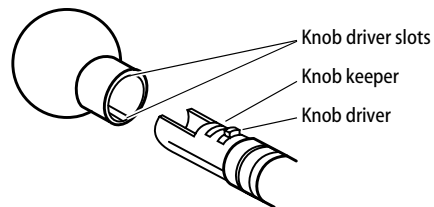

Figure 8 Installing the inside keyed knob

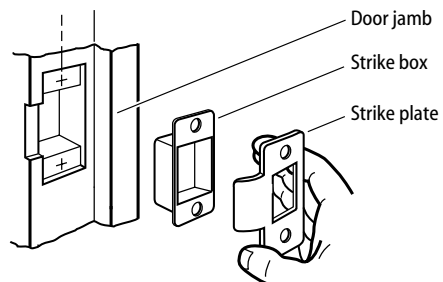

Figure 9 Installing the strike

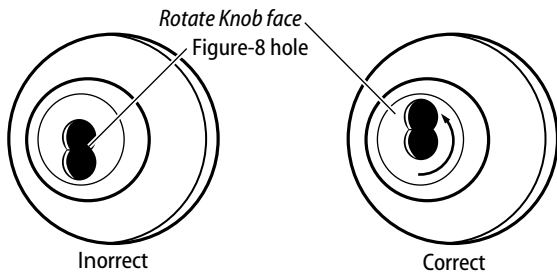

Figure 10 Turning the knob face to correct the handing of the lock

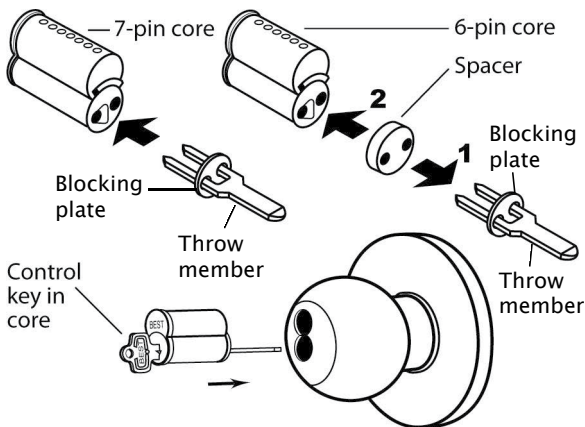

Figure 11 Installing the figure-8 core

### 8 Check handing

**Note:** When Best 8K locksets are properly installed, the figure-8 hole must be in the upper half of the knob. If it is not, change the hand of the lock.

**To change the hand of the lock:**

- Rotate the knob face 180 degrees so that the figure-8 is in the upper half of the knob.

### 9 Install core

**For 6-pin core users only:** Slide the spacer — supplied with your 6-pin core — over the 7-pin throw member (see Figure 11, top right).

**Note:** If you have ordered 6-pin cores, you will get one spacer per core with your order. Spacers are not supplied with locks.

- 1 Install the throw member into the back of the core as shown in Figure 11, top.
- 2 Insert the control key into the core and rotate the key 15 degrees to the right.

**Caution:** You must use the blocking plate when installing an 8K lockset to prevent unauthorized access.

- 3 Insert the core and throw member into the knob with the control key as shown in Figure 11, bottom.
- 4 Rotate the control key 15 degrees to the left and withdraw the key.

**Caution:** The control key can be used to remove cores and to access doors. Provide adequate security for the control key.



For assistance or warranty information:  
Call 1-800-392-5209 or visit  
<https://dhw.support.dormakaba.com/hc/en-us>

**Warning:** This Manufacturer advises that no lock can provide complete security by itself. This lock may be defeated by forcible or technical means, or evaded by entry elsewhere on the property. No lock can substitute for caution, awareness of your environment, and common sense. Builder's hardware is available in multiple performance grades to suit the application. In order to enhance security and reduce risk, you should consult a qualified locksmith or other security professional.



Si desea ayuda o información sobre la garantía:  
llame al 1-800-392-5209 o visite  
<https://dhw.support.dormakaba.com/hc/en-us>

**Advertencia:** Este fabricante debe saber que no hay cerraduras que puedan proporcionar seguridad completa por sí mismas. Este cerradura o puede fallar forzosamente o utilizando medios técnicos o entrando por otra parte del edificio. No hay cerraduras que puedan sustituir precaución, estar al tanto de su entorno y sentido común. Este fabricante también ofrece cerraduras de diferentes grados y rendimientos para ajustarse a su aplicación. Para mejorar la seguridad y reducir riesgos, usted debe consultar con un cerrajero especializado u otro profesional de seguridad.



Pour de l'aide ou des informations sur la garantie:  
Veuillez appeler le 1-800-392-5209 ou visiter  
<https://dhw.support.dormakaba.com/hc/en-us>

**Advertissement:** Le fabricant tient à vous aviser qu'aucun verrou ne peut à lui seul offrir une sécurité complète. Ce verrou peut être malhonnêtement forcé par la force ou des moyens techniques ou être évadé par l'utilisation d'une autre entrée sur la propriété. Aucun verrou ne peut remplacer la surveillance de votre environnement et le bon sens. La qualité pour le constructeur est offerte selon différents grades de performance pour différentes applications. Afin d'améliorer la sécurité et de réduire le risque, vous devez consulter un serrurier qualifié ou un autre professionnel de la sécurité.