

WOOD DOOR CONCEALED VERTICAL ROD EXIT DEVICES

S519

Apex 2700 Series - Reversible Apex FL2700 Fire Exit Series - Reversible

DOORS - For all types of single and double door applications. Available for 1-3/4" to 2-1/4" thick, up to 4'-0" wide by 10'-0" high openings. For thicker doors, consult factory. Furnished standard for 1-3/4" thick, 3'-0" wide by 6'-8" to 8'-0" high openings.

FUNCTIONS - A Universal Exit Device. Add Trim for desired function.

BASE MATERIAL - Side Filler and End Cap are furnished of heavy wrought Brass, Bronze or Stainless Steel. 628 Devices are furnished with Aluminum, Brass, Bronze and Stainless Steel components. See "Finish & Base Material" chart on page 3.

CHASSIS - Lock Stile Assembly - Investment Cast Steel, Zinc Dich-romated.

VERTICAL RODS - Steel, plated. Top Rod is adjustable from 6'-8" to 8'-0" or from 8'-1" to 10'-0". Additional adjustments are available through the lock front filler.

BOTTOM STRIKE - No. S460 Flush mounted, Steel, Black Powder Coated.

DOGGING - 1/4 turn hex key dogging standard. NOT available on Fire Exit Hardware.

TOUCHBAR HEIGHT - 39-15/16 from floor standard. Specify required height if other than standard.

REVERSIBLE - Reversible for all functions and trims. Standard packaging RHRB.

UL LISTED - Panic and Fire Exit Hardware. For FIRE EXIT HARDWARE Ratings see page 33. Conforms to UL10C and UBC 7-2.

ANSI/BHMA - Devices are BHMA certified for ANSI 156.3, Grade 1.

FINISHES - 605, 606, 612, 613, 625, 626W, 628, 630. For finish description see page 3.

CYLINDERS - Rim Type, not furnished standard. Specify when required. For cylinder details see page 19.



TOP LATCHBOLT - Stainless Steel, Deadlocking, 3/4" throw.

BOTTOM BOLT - Steel plated, independent action 5/8" throw, with adjustment range to suit 3/4 door undercut.

TOP STRIKE - No. S519 Surface applied, Investment Cast Stainless Steel, Black Powder Coated.

STILE WIDTH - See Stile Information on page 36.

LESS BOTTOM ROD (LBR) OPTION - Specify suffix "LBR" (e.g. 2703LBR). See UL FIRE LABEL RATING Chart on page 33. Fire Rated Devices include FB277 Fire Bolt Assembly. For Fire Bolt Assembly image see page 35.

DEVICE OPTIONS

Prefix	Description	Page	Suffix	Description	Page
C	Quick Connect Plugs	39	ALK	Exit Alarm: battery operated	27
DE	Delayed Egress.....	24	ALW	Exit Alarm: remote power	27
E	Electric Device.....	28	BRL	Braille Touchbar.....	35
ELR	Electric Latch Retraction.....	21	CD	Cylinder Dogging	19
FL	Fire Exit Hardware	14	DS	Door Position Monitoring Switch	29
LS	Latchbolt Monitoring Switch	29	LBR	Less Bottom Rod.....	14
MLR	Motorized Latch Retraction	40-41	LD	Less Dogging	19
Q	Wireless Access Management System..	30-32	SEC	Security Screws.....	3
TDS	Touchbar Monitoring Double Switch	29	SNB	Sex Nut and Bolt	3
TS	Touchbar Monitoring Switch	29	WALW	Weatherized Exit Alarm: remote power	27
WTDS	Weatherized Touchbar Mon. Dbl. Switch	29		To specify add Prefix to Device No. (e.g. TS2703)	
WTS	Weatherized Touchbar Mon. Switch	29			

To specify add Prefix to Device No. (e.g. TS2703)

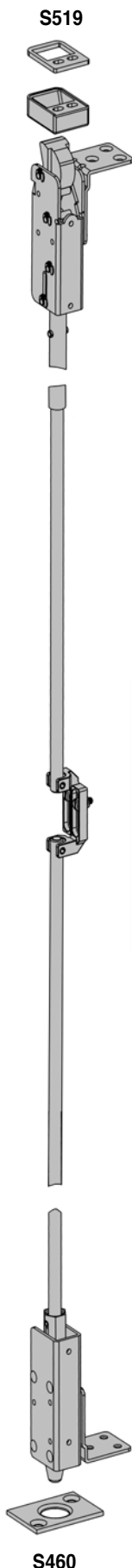

S460

1700A
"A" Grip



1700B
"B" Grip



1700C
"C" Grip



2000C
"C" Grip



1. All Trims are furnished with wrought plates and extruded or cast solid grips.
2. Specify Grip Design (A,B,C) ("A" Grip furnished standard for 1700 Series Trim, "C" Grip furnished standard for 2000 Series Trim)
3. 630 Trim is furnished for 628 Devices.
4. 626 Trim is furnished for 626W Devices.

4900A
"A" Lever



4900B
"B" Lever



4900C
"C" Lever



4900D
"D" Lever



4900K
"K" Knob



V4908A
Vandal Resistant Trim

A heavy duty lever trim designed to withstand abuse and vandalism. Composed of extra strength shock-absorbing "overload" springs and heavy duty investment cast stainless steel internal components. Lever returns to the "home" position eliminating the need to reset the lever.

1. All the escutcheons and levers are castings or forgings.
2. Specify Lever or Knob Design (A,B,C,D,K) and Handing ("A" Lever x RHRB furnished standard)
3. 626 Trim furnished for 626W, 628 and 630 Devices.
 - For Trim dimensions see page 38.
 - Trims are BHMA certified for ANSI 156.3, Grade 1.
 - Trims are through bolted and will cover 161 and 86 cutouts (except for 2000C Trim).
 - Cylinder, Rim Type, not furnished standard. For cylinder details see page 19.

ANSI Function	01 Exit Only (cover plate)	02 Dummy Trim	03 Key Retracts Latchbolt	05 Key Locks/Unlocks Thumbpiece	08 Key Locks/Unlocks Lever/Knob	14 No Cylinder Lever/Knob Always Active	15 No Cylinder Thumbpiece Always Active
Device Nos.	2701 FL2701	2702	2703** FL2703**	2705 FL2705	2708 FL2708	2714 FL2714	2715 FL2715
Trim Nos.	1701 2001 4901	1702A 2002C 4902A	1703A 2003C 4903A	1705A 2005C	4908A V4908A	4914A	1715A 2015C

Device with Trim:



Device Only: Device no., hand, finish, strike, and door size including thickness: (e.g. TS2708CD x RHRB x 630 x 3'-0" x 7'-0" x 1-3/4")

Trim Only: Trim no., hand, finish, strike, and door size including thickness: (e.g. V4908A x RHRB x 626 x 1-3/4")

* 2703 & FL2703 X Cylinder Only Application includes Cylinder Attachment Kit "CA-03".